

A

B

C

D

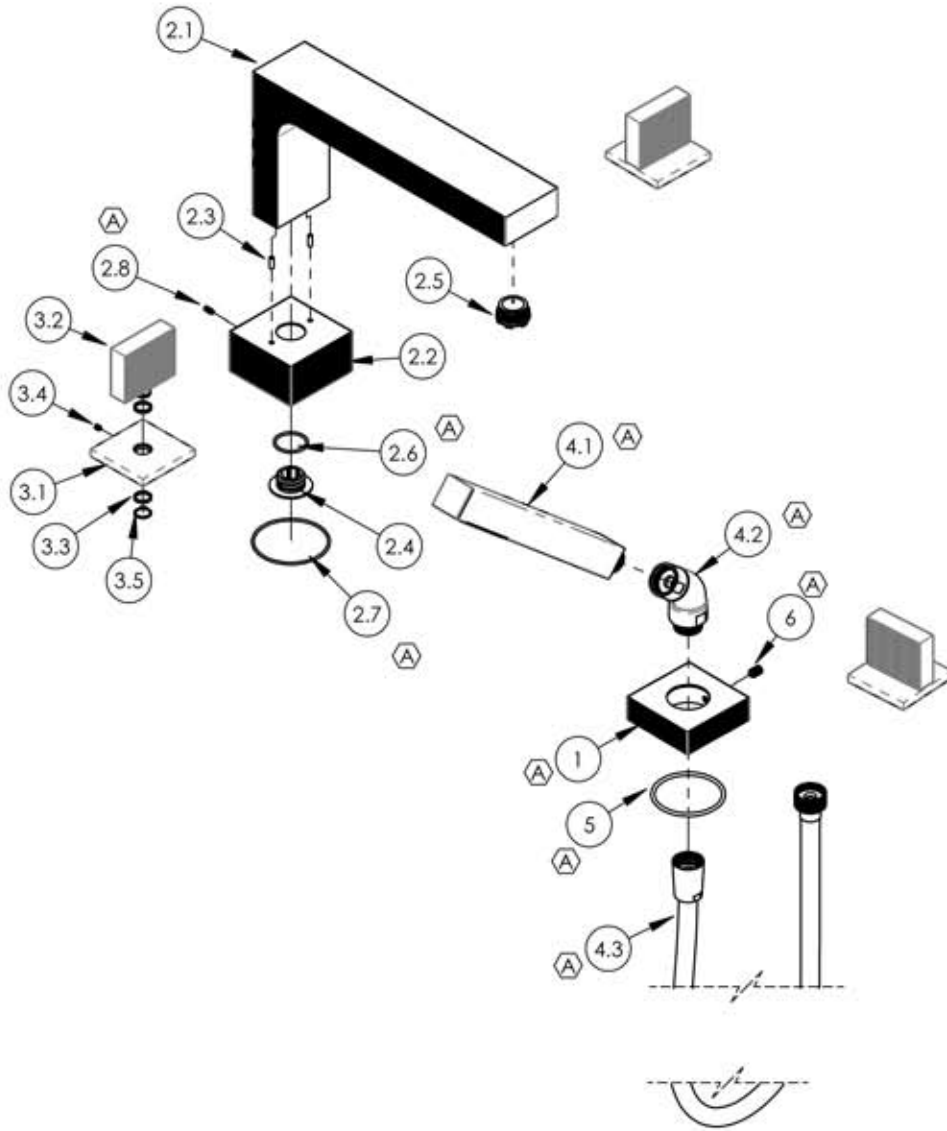

ITEM NO.	PART NUMBER	DESCRIPTION	QTY.
1	11225/00	HAND SHOWER BASE, STRIA SERIES	1
2	3-107/00	ASSY, SPOUT ROMAN TUB RIBBED LOW	1
2.1	10951/00	SPOUT, DECK TUB 291 STRIA	1
2.2	11224/00	ESCUTCHEON, SPOUT STRIA SERIES	1
2.3	92158	DOWEL PIN, 1/8" X 3/8"L	2
2.4	11220	SPUD SCREW, 1/2"-NPSM CONNECTOR	1
2.5	P05051	AERATOR, CACHE COINED SLOT M24X1.0 FULL FLOW	1
2.6	90020	O-RING, 7/8"ID X 1"OD X 1/16"THK. AS-568-020	1
2.7	90034	O-RING, 2-1/8"ID X 2-1/4"OD X 1/16"THK. AS-568-034	1
2.8	92303	SET SCREW, CUP POINT 6-32 X 5/16" L	1
3	3-108/00	ASSY, HANDLE RIBBED BLADE	3
3.1	10937/00	ESCUTCHEON, HANDLE EDGE SERIES	1
3.2	10927/00	HANDLE, BLADE EDGE SERIES	1
3.3	92176	WEAR WASHER	2
3.4	92005	SET SCREW, CUP PT 6-32 UNC THREAD 3/16"L	1
3.5	92177	RETAINING RING, 7/16" SHAFT	1
4	4-522/00	HAND SHOWER HEAD, HOSE, ELBOW, SQUARE, WAVELAND	1
4.1	3-600/00	HAND SHOWER, SQUARE, MODERN	1
4.2	3-050/00	ELBOW ASSEMBLY	1
4.3	3-049/00	ASSY, HOSE KIT, HANDSHOWER	1
5	90135	O-RING, 1-15/16"ID X 3/32"THK. AS-568-135	1
6	92173	SET SCREW, CUP PT. 1/4" - 20 X 3/8" L	1

E

ALL	REV.	DESCRIPTION	DATE	APPROVED
A		REMOVE ROUGH IN, UPDATE HAND SHOWER & SPOUT ASSY	7/3/2019	AMM

REVISIONS				
Defining Luxury Since 1959				

**PROPRIETARY AND CONFIDENTIAL**  
 THE INFORMATION CONTAINED IN THIS DRAWING IS THE SOLE PROPERTY OF RJS MANUFACTURING. ANY REPRODUCTION IN PART OR AS A WHOLE WITHOUT THE WRITTEN PERMISSION OF RJS MANUFACTURING IS PROHIBITED.

NEXT ASSY		USED ON		INTERPRET GEOMETRIC DIMENSIONING & TOLERANCING IN ACCORDANCE WITH ASME Y14.5-2009 & ASME Y14.41-2003 STANDARDS, UNLESS OTHERWISE SPECIFIED. DIMENSIONS ARE IN INCHES. TOLERANCES ARE:			<b>DECK HAND SHOWER KIT, BLADE HANDLE, STRIA SERIES</b>		
APPLICATION				FRACTIONS ±1/64"	DECIMALS X.X: ±.1 X.XX: ±.01 X.XXX: ±.005	ANGULAR ±.5°			
MATERIAL							<b>A</b>	291-48/00	A
FINISH				DRAWN		1/29/2016			
<b>DO NOT SCALE DRAWING</b>				CHECKED	MAF		SCALE: 1:5.5	WEIGHT: lbs.	SHEET 1 OF 2

5

4

3

2

1