

NOTE(S):

AVAILABLE STONE OPTIONS  
 \*BLACK MARBLE = /030  
 \*WHITE MARBLE = /031  
 \*SOAPSTONE = /032  
 EX: 230-50/026X030

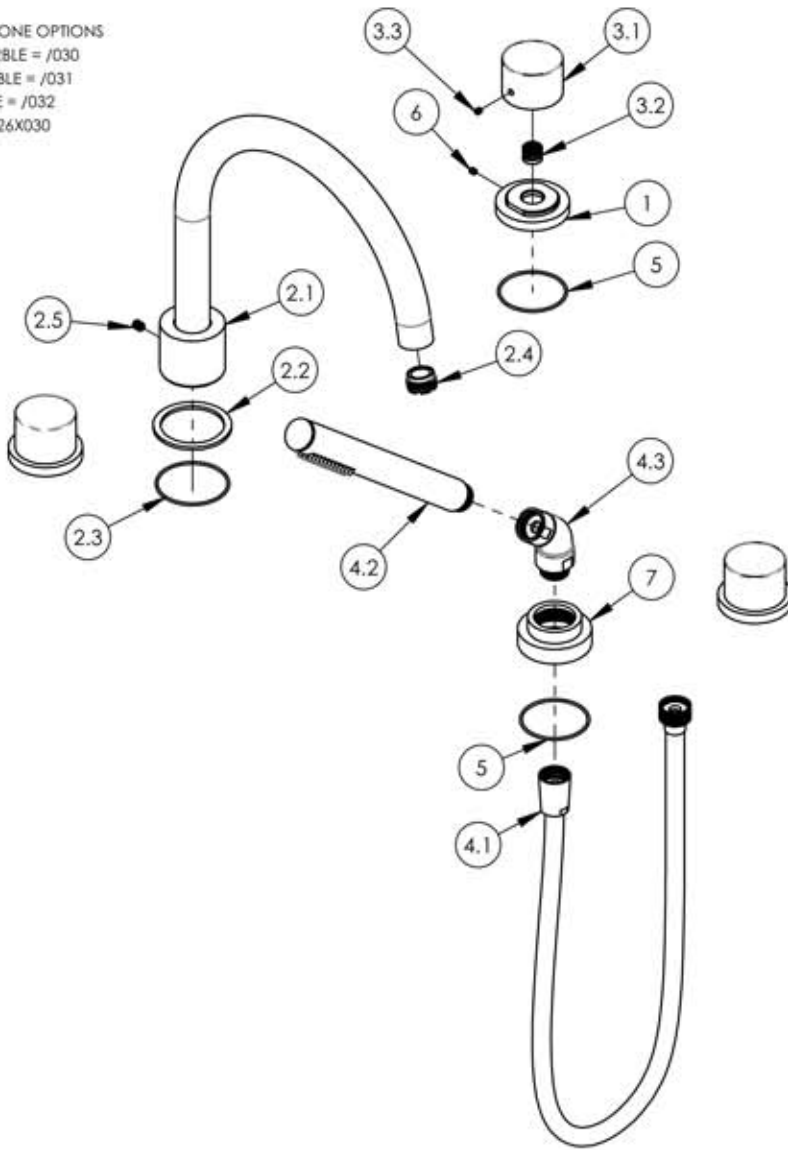

SEE NOTES \*

ITEM NO.	PART NUMBER	DESCRIPTION	QTY.
1	11344/00	ESCLUTCHEON BASE, DECK TUB HANDLE, BASIC II	3
2	3-394/00	ASSY, HIGH ARC TUB SPOUT, DECK TUB BASIC II	1
2.1	2-128/00	SUB ASSY, HIGH ARC TUB SPOUT, DECK TUB BASIC II	1
2.2	11186/00	BASE FLANGE, BASIC II	1
2.3	90033	O-RING, 2"ID X 2-1/8"OD X 1/16"THK, AS-568-033	1
2.4	P05024	AERATOR CACHE COIN SLOT, M21.5X1.0 FULL FLOW	1
2.5	92127	SET SCREW, CUP POINT, 1/4-20 X 5/16"L, STAINLESS STEEL	1
3	3-572	HANDLE, ROUND MARBLE, SOAPSTONE (032) ASSY	3
3.1	11389	HANDLE, ROUND CYLINDER, MARBLE, SOAPSTONE (032)	1
3.2	11322	1/6PT. BROACH INSERT, ROUND MARBLE HANDLE	1
3.3	92008	SET SCREW, CUP POINT 8-32, 3/16" L.	1
4	4-585/00	HAND SHOWER HEAD, HOSE, ELBOW, CYLINDER	1
4.1	3-049/00	ASSY, HOSE KIT, HANDSHOWER	1
4.2	3-471/00	ASSY, ROUND HANDSHOWER, CONTEMPORARY	1
4.3	3-050/00	ELBOW ASSEMBLY	1
5	90032	O-RING, 1-7/8"ID X 2"OD X 1/16"THK, AS-568-032	4
6	92008	SET SCREW, CUP POINT 8-32, 3/16" L.	3
7	P18030/00	BASE, DECK HANDHELD, BASIC	1

A

B

C

D

E

ZONE	REV.	DESCRIPTION	DATE	APPROVED
REVISIONS				
Defining Luxury Since 1959				

**PROPRIETARY AND CONFIDENTIAL**  
 THE INFORMATION CONTAINED IN THIS DRAWING IS THE SOLE PROPERTY OF RSS MANUFACTURING. ANY REPRODUCTION IN PART OR AS A WHOLE WITHOUT THE WRITTEN PERMISSION OF RSS MANUFACTURING IS PROHIBITED.

-		INTERPRET GEOMETRIC DIMENSIONING & TOLERANCING IN ACCORDANCE WITH ASME Y14.5-2009 & ASME Y14.41-2003 STANDARDS, UNLESS OTHERWISE SPECIFIED. DIMENSIONS ARE IN INCHES. TOLERANCES ARE:		
NEXT ASSY	USED ON	FRACTIONS ±1/64"	DECIMALS X.X: ±.1 X.XX: ±.01 X.XXX: ±.005	ANGULAR ±.5°
APPLICATION		MATERIAL	NAME	DATE
FINISH		DRAWN	AMM	8/27/2019
DO NOT SCALE DRAWING		CHECKED		

DECK TUB SET WITH HAND SHOWER, MARBLE HANDLES, BASIC II SERIES

SIZE	ASM/PRT NO.	REV
<b>A</b>	230-50/00	-
SCALE: 1:5.5	WEIGHT: lbs.	SHEET 1 OF 2

5

4

3

2

1