

NOTE(S):
1. APPLY NSF COMPLIANT LOCTITE TO
THREADED AREA.

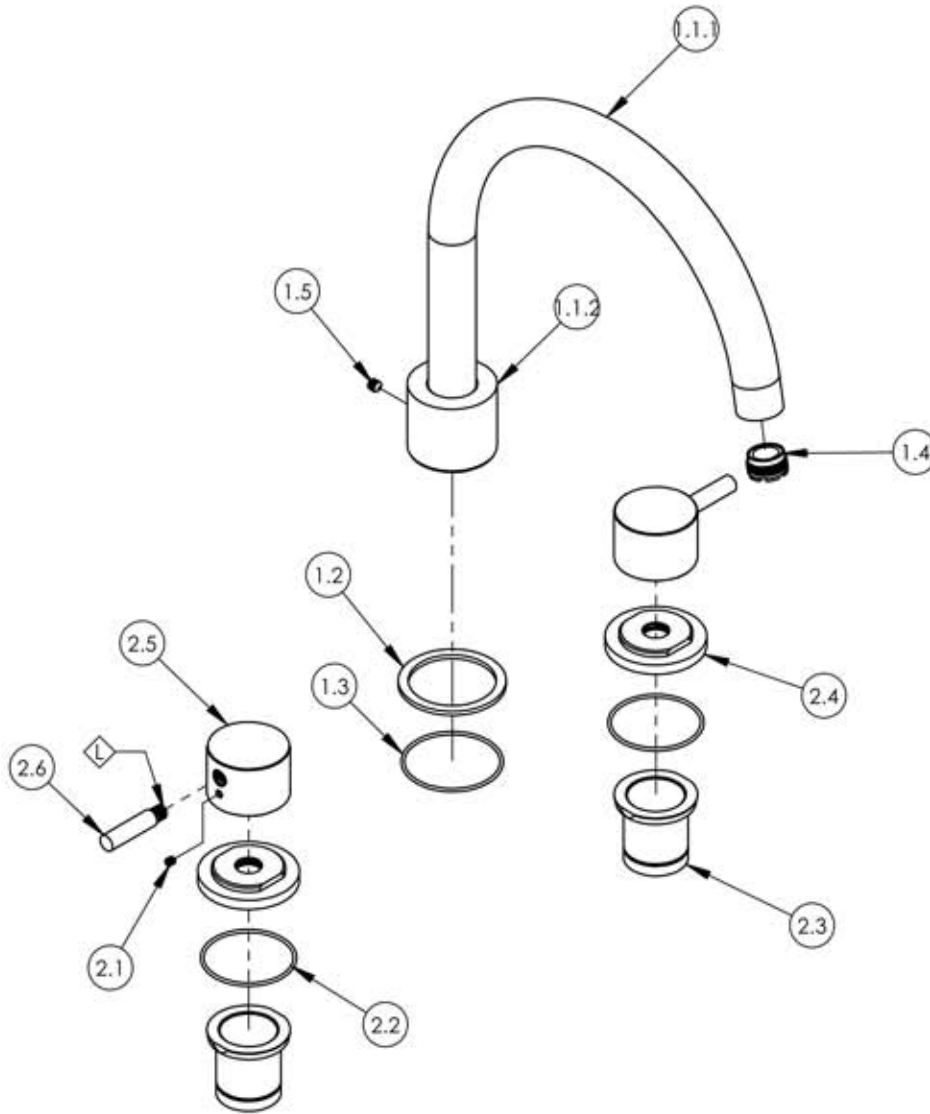

ITEM NO.	PART NUMBER	DESCRIPTION	QTY.
1	3-394/00	ASSY, HIGH ARC TUB SPOUT, DECK TUB BASIC II	1
1.1	2-128/00	SUB ASSY, HIGH ARC TUB SPOUT, DECK TUB BASIC II	1
1.1.1	P27032/00	HIGH SPOUT, ROMAN TUB, BASIC SERIES	1
1.1.2	11185/00	SPOUT BASE, BASIC II SERIES	1
1.2	11186/00	BASE FLANGE, BASIC II	1
1.3	90033	O-RING, 2"ID X 2-1/8"OD X 1/16"THK, AS-568-033	1
1.4	P05024	AERATOR CACHE COIN SLOT, M21.5X1.0 FULL FLOW	1
1.5	92191	M6X1.0-6MM L	1
2	3-435/00	ASSEMBLY LEVER HANDLE, DECK TUB, BASIC II	2
2.1	92008	SET SCREW, CUP POINT 8-32	1
2.2	90032	O-RING, 1-7/8"ID X 2"OD X 1/16"THK, AS-568-032	1
2.3	11077	SLEEVE MOUNT, DECK (ROMAN) TUB	1
2.4	11344/00	ESCUTCHEON BASE, DECK TUB HANDLE, BASIC II	1
2.5	11167/00	BASE HANDLE, CONTEMP. BASIC II	1
2.6	11168/00	HANDLE LEVER, CONTEMP. BASIC II	1

ZONE	REV.	DESCRIPTION	DATE	APPROVED
REVISIONS				

1261 LOGAN AVENUE
COSTA MESA, CALIFORNIA 92626
PHONE: 714.361.4800
FAX: 714.617.3120

PHYLORICH®

Defining Luxury Since 1959

PROPRIETARY AND CONFIDENTIAL
THE INFORMATION CONTAINED IN THIS DRAWING IS THE SOLE PROPERTY OF RISS MANUFACTURING. ANY REPRODUCTION IN PART OR AS A WHOLE WITHOUT THE WRITTEN PERMISSION OF RISS MANUFACTURING IS PROHIBITED.

-	-	INTERPRET GEOMETRIC DIMENSIONING & TOLERANCING IN ACCORDANCE WITH ASME Y14.5-2009 & ASME Y14.41-2003 STANDARDS, UNLESS OTHERWISE SPECIFIED. DIMENSIONS ARE IN INCHES. TOLERANCES ARE:		
NEXT ASSY	USED ON	FRACTIONS ±1/64"	DECIMALS X.X: ±.1 X.XX: ±.01 X.XXX: ±.005	ANGULAR ±.5°
APPLICATION		MATERIAL	NAME	DATE
FINISH		DRAWN	FME	11/5/2015
DO NOT SCALE DRAWING		CHECKED	LLO	

DECK TUB SET, LEVER HANDLES, BASIC II SERIES

SIZE	ASM/PRT NO.	REV
A	230-43/00	-
SCALE: 1:4	WEIGHT: lbs.	SHEET 1 OF 2

5

4

3

2

1