

TO-PBL-74  
TO-PB2L-74

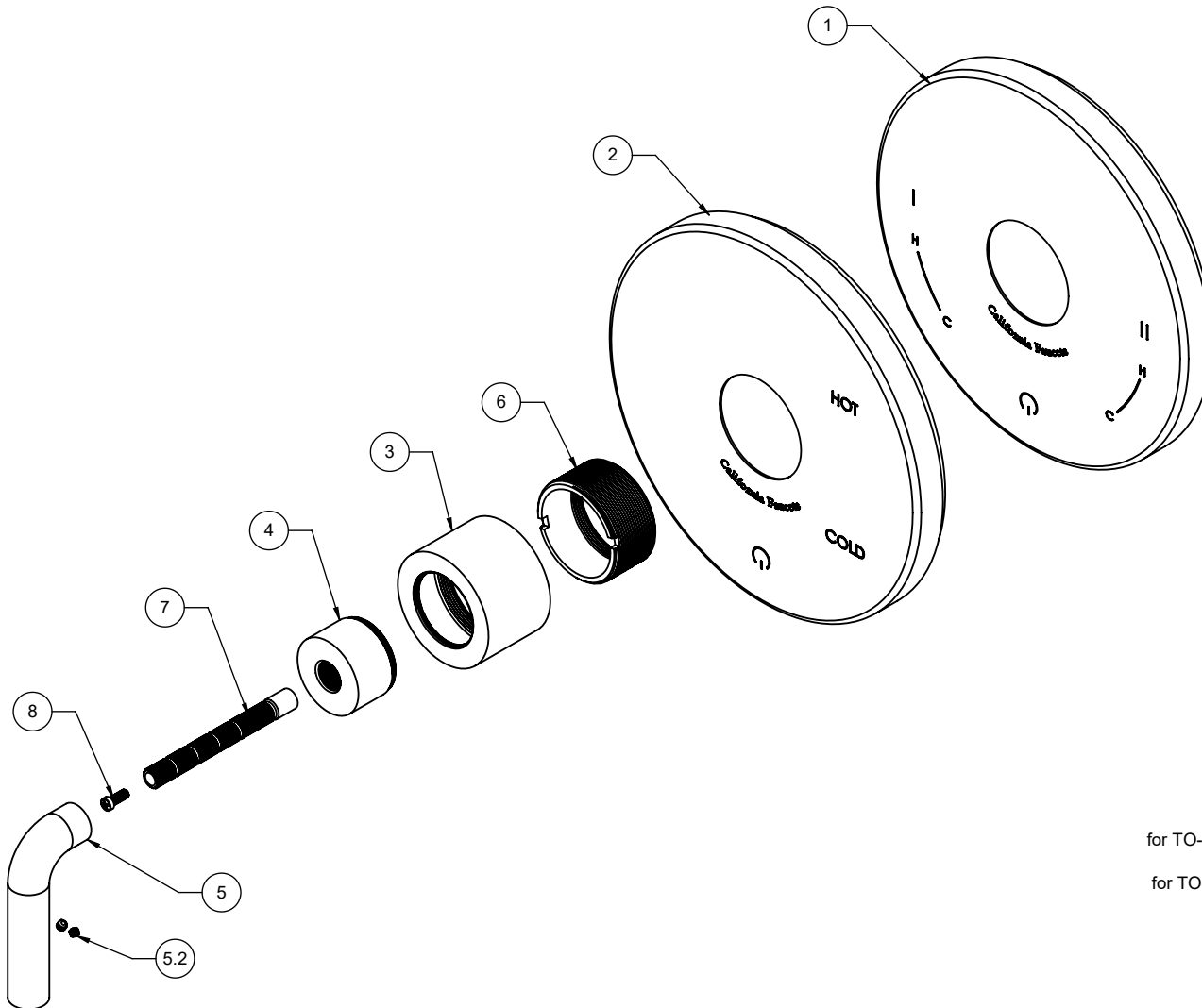

To order spare parts add and/or replace as stated below:

**SPD-** prefix added to part number(s)  
**-ZZ** replaced with finish code (see finish table)  
**-WW** replaced with **-90** (light finish) or **-96** (dark finish)

Ex: **SPD-7-100463-PC** or **SPD-86030-96**

ITEM	PART NO	DESCRIPTION	QTY.
for TO-PB2L	1	7-100547-ZZ ASM, CONT PB2 PLATE & GASKET	1
for TO-PBL	2	7-100106-ZZ ASM, CONT PB PLATE & GASKET	1
	3	10294-ZZ ESCUTCHEON, CONT, PB G2	1
	4	571380-ZZ ESCUTCHEON, 57, SERIES	1
	5	7-100146-ZZ ASM, LEVER, 74 SERIES "BROACHED" (incl. 5.2)	1
	5.2	86030-WW SETSCREW 8-32 X 1/8 SCKT HD CUP PT SS	2
	6	10292-98 BUSHING, PB G2	1
	7	880137-98 BROACH EXTENSION 3-1/4"(L) X 16T(M) X 20T(F)	1
	8	86078-90 SCREW, M4 X 0.7 X 10MM, w/Ø5.80 PHL PH HD SS	1
for ITEM 5.2	9	882042-99 KEY, ALLEN, 5/64", BLACK	1