

NOTE:  
1. XX DENOTES FINISH

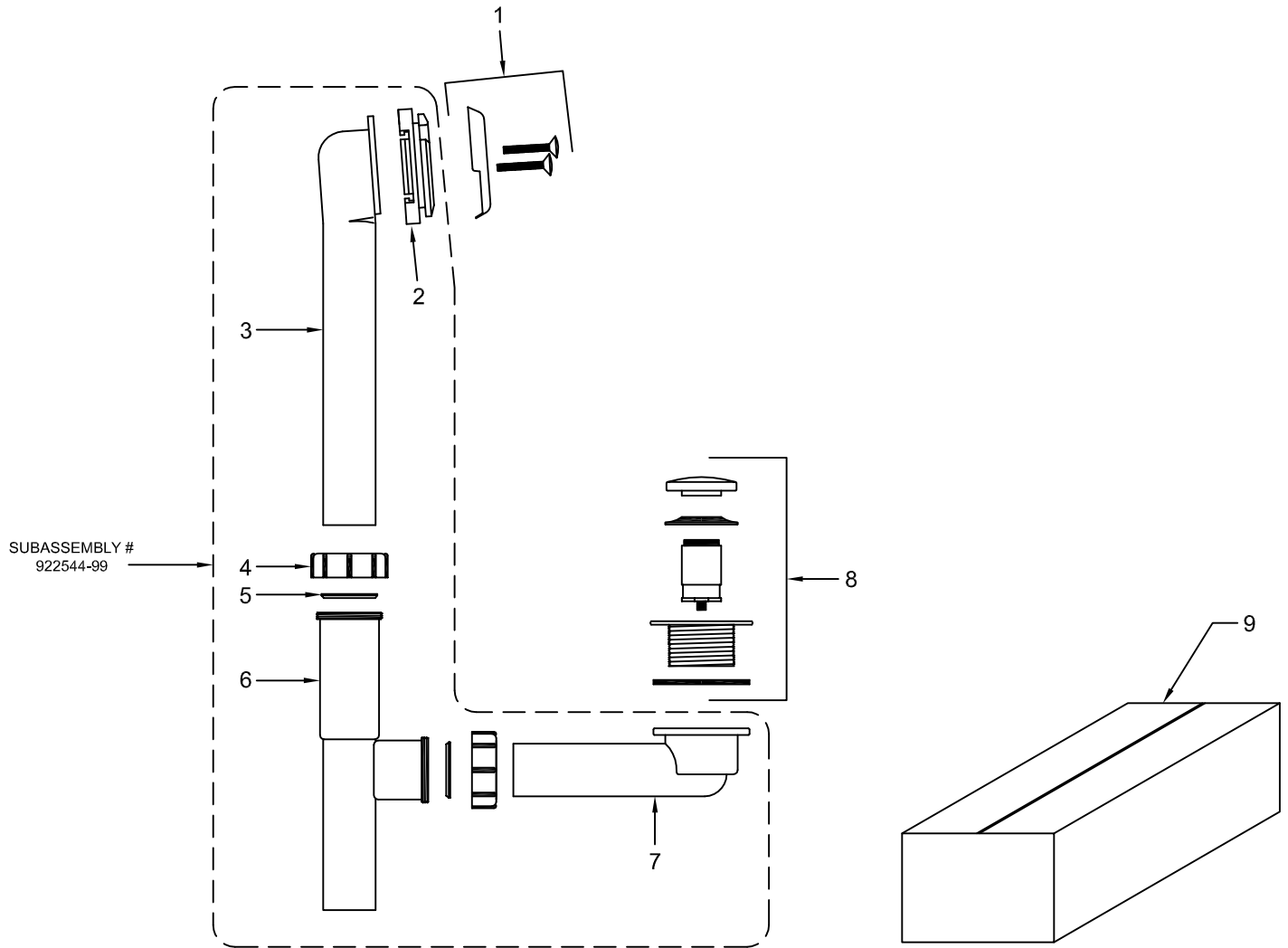

Pos.	Description	Qty.	Part #
1	FACEPLATE W/WASTE & OVERFLOW (BOXED SEPARATELY)	1	9233-XX
2	GASKET, HANDLE, OVERFLOW, 9223	1	922855-99
3	BODY, OVERFLOW, ABS, 1-1/2" X 10"	1	921786-99
4	TEE, NUT, ABS, 1-1/2"	2	921824-99
5	TEE, NYLON WASHER, 1-1/2", ID	2	921780-99
6	BODY, TEE, ABS, 9", 9223	1	921787-99
7	BODY, SHOE, 1-1/2" X 5-1/2"	1	921788-99
8	TOE ACTIVATED TUB DRAIN (BOXED SEPARATELY)	1	9238-XX
9	CARTON, 12" X 7" X 5"	1	TW 697

  
**California Faucets®**  
 info@calfaucets.com  
 www.calfaucets.com

**DESCRIPTION:**  
**TOE ACTIVATED WASTE AND OVERFLOW**  
**NEXT ASSEMBLY: 9223**      **USED ON: N/A**  
**DRAWING NUMBER: 9223**

**STARTING DATE:** 10/17/05  
**REVISION DATE:** 08/29/07  
**APPROVED BY:** J. WOJTASZEK  
**SCALE:** NONE  
**DRAWN BY:** W. LINARES

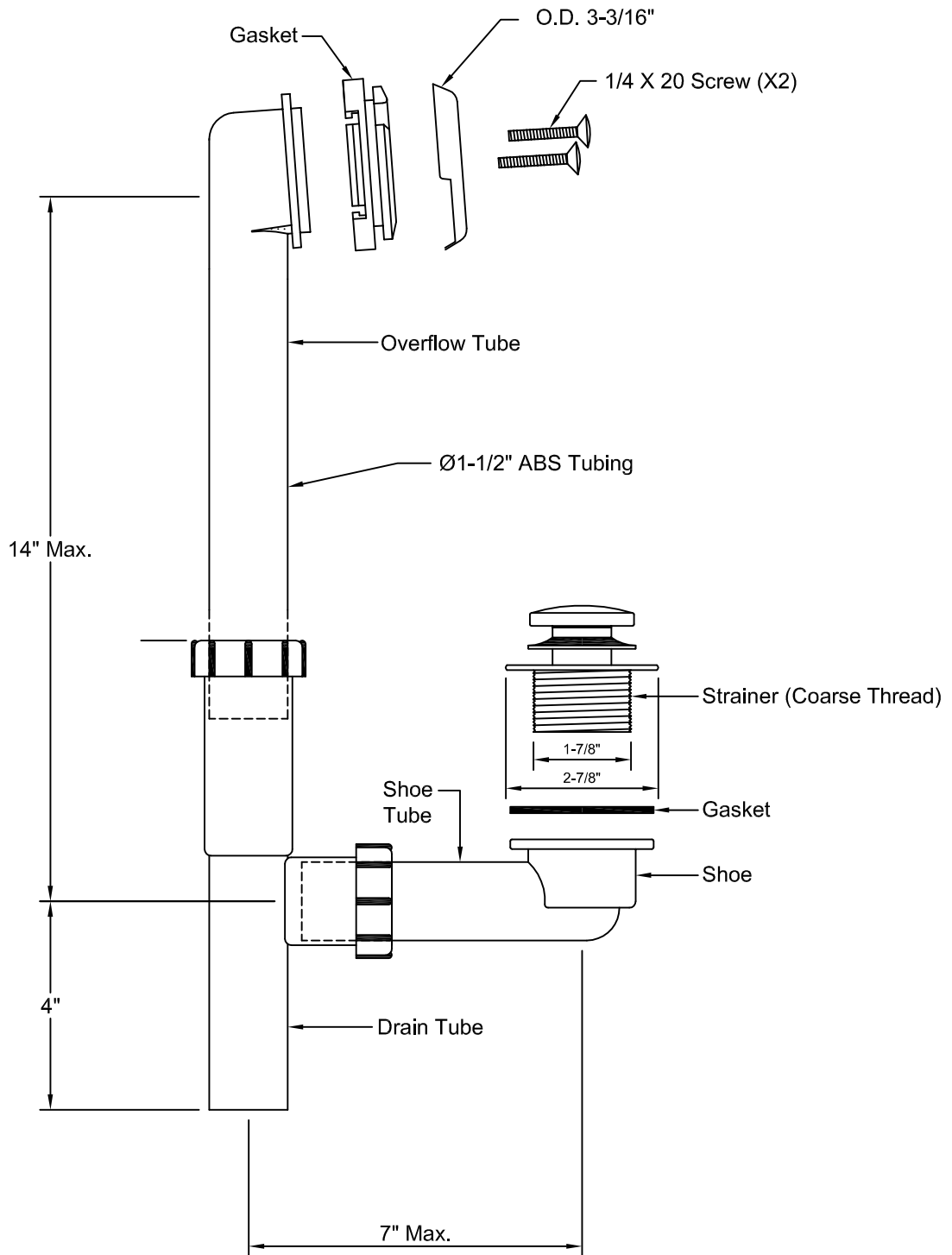

DESCRIPTION:	<b>TOE ACTIVATED WASTE AND OVERFLOW</b>	
NEXT ASSEMBLY:	<b>9223</b>	USED ON: <b>N/A</b>
DRAWING NUMBER:	<b>9223</b>	

STARTING DATE:	06/14/05
REVISION DATE:	08/30/07
APPROVED BY:	J. WOJTASZEK
SCALE:	NONE
DRAWN BY:	W. LINARES