

GROHFLEX ESSENCE

Dual function thermostatic trim with control module

MODEL # 19988001

GROHE America, Inc | 200 North Gary Avenue, Suite G, Roselle, IL 60172
Phone: +1 (800) 444-7643 | Fax: +1 (800) 225-2778 | us-customerservice@grohe.com

Pure Freude an Wasser

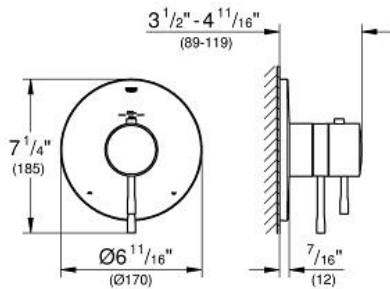

Product Description:

Dual function thermostatic trim with control module

Standard Specification:

- For shower/tubs with non-diverter tub spout or for 2 shower outlet applications
- **GROHE TurboStat** technology
- Integrated volume control
- 2-way diverter function
- 1 axis operation
- Requires GrohFlex™ universal rough-In box (35 026 000) (sold separately)
- **GROHE StarLight** finish

Applicable Codes & Standards:

- ASME A112.18.1/CSA B125.1

Color:

- 19988001 001 chrome