

**Vero Furniture washbasin # 045470..00 / 045470..30 / 045470..60**

| < 27 1/2" Inch > |

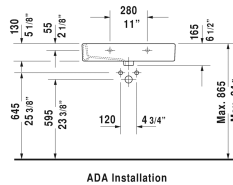
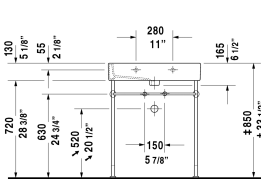
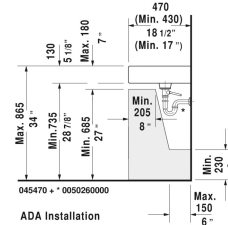
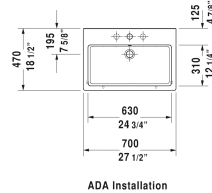
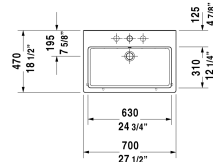

Furniture washbasin	Dimension	Weight	Order number
with tap platform, hardware included, wall-mounted, cUPC listed, 27 1/2" Inch			
<b>Colors</b>			
00 White 08 Black			
<b>Variant</b>			
● with overflow	27 1/2" x 18 1/2" Inch	46.1 lb	045470..00
●●● with overflow	27 1/2" x 18 1/2" Inch	46.1 lb	045470..30
⊗ with overflow	27 1/2" x 18 1/2" Inch	46.1 lb	045470..60
<b>Infobox</b>			
Washbasin is not ADA compliant in combination with pedestal, siphon cover or metal console			
Sanitary ceramics with the special WonderGliss surface finish will remain clean and attractive-looking for a long time to come. When ordering WonderGliss please add a "1" as eleventh digit to the model number.			
Design Siphon		3.3 lb	005036
Pop-up basin waste with horizontal lever**	2" Inch	1.1 lb	005031
Towel rail square tube 1/2", Chrome, for washbasin # 045470	25 3/4" Inch	0.9 lb	003047
<b>Suitable products</b>			
Metal console height adjustable +2", for washbasin # 045470,			003075
Vanity unit wall-mounted 1 pull-out compartment, for Vero # 045470 (not ground), 25 5/8" x 17 3/8" Inch	25 5/8" x 17 3/8" Inch		KT6684

**Vero Furniture washbasin # 045470..00 / 045470..30 / 045470..60**

|< 27 1/2" Inch >|

Vanity unit wall-mounted 2 drawers, upper drawer including cut-out for siphon and siphon cover, for Vero # 045470 (not ground), 25 5/8" x 17 3/8" Inch	25 5/8" x 17 3/8" Inch	KT6624
Vanity unit wall-mounted 1 pull-out compartment, compartment consists of glass dividers and 2 boxes (small/large), for Vero # 045470 (not ground), 25 5/8" x 17 1/2" Inch	25 5/8" x 17 1/2" Inch	XL6042
Vanity unit wall-mounted 2 drawers, upper drawer including cut-out for siphon and siphon cover, for Vero # 045470 (not ground), 25 5/8" x 17 1/2" Inch	25 5/8" x 17 1/2" Inch	XL6342
Vanity unit wall-mounted 1 opened compartment including towel rail, for Vero # 045470 (not ground), 25 5/8" x 16 7/8" Inch	25 5/8" x 16 7/8" Inch	VE6005
Vanity unit wall-mounted 1 pull-out compartment, pull-out compartment including cut-out for siphon and siphon cover, for Vero # 045470 (not ground), 25 5/8" x 16 7/8" Inch	25 5/8" x 16 7/8" Inch	VE6105
Vanity unit wall-mounted 2 drawers, upper drawer including cut-out for siphon and siphon cover, for Vero # 045470 (not ground), 25 5/8" x 16 7/8" Inch	25 5/8" x 16 7/8" Inch	VE6205

*All drawings contain the necessary measurements which are subject to standard tolerances. They are stated in inch & mm and are non-binding. Exact measurements, in particular for customized installation scenarios, can only be taken from the finished ceramic piece.*

Vero Washbasin ground # 045470..25 / 045470..27 / 045470..28

< 27 1/2" Inch >

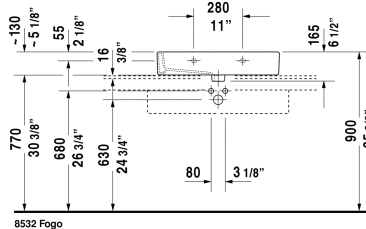
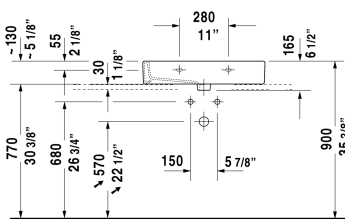
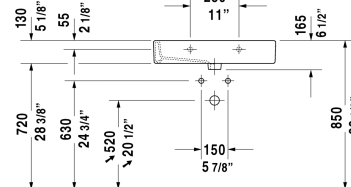
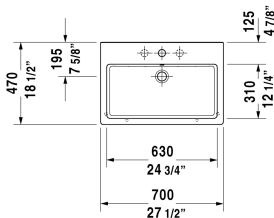

Washbasin ground	Dimension	Weight	Order number
with tap platform, hardware included, wall-mounted, cUPC listed, 27 1/2" Inch			
<b>Colors</b>			
00 White 08 Black			
<b>Variant</b>			
●●● with overflow	27 1/2" x 18 1/2" Inch	46.1 lb	045470..25
● with overflow	27 1/2" x 18 1/2" Inch	46.1 lb	045470..27
☒ with overflow	27 1/2" x 18 1/2" Inch	46.1 lb	045470..28
<b>Infobox</b>			
Washbasin is not ADA compliant in combination with pedestal, siphon cover or metal console			
Sanitary ceramics with the special WonderGliss surface finish will remain clean and attractive-looking for a long time to come. When ordering WonderGliss please add a "1" as eleventh digit to the model number.			
Design Siphon		3.3 lb	005036
Pop-up basin waste with horizontal lever**	2" Inch	1.1 lb	005031
<b>Suitable products</b>			
Vanity unit wall-mounted 1 pull-out compartment, countertop including one cut-out, for 1 above-counter basin central, 39 3/8" x 21 5/8" Inch	39 3/8" x 21 5/8" Inch		KT6695

**Vero Washbasin ground # 045470..25 / 045470..27 / 045470..28**

|&lt; 27 1/2" Inch &gt;|

Vanity unit wall-mounted 1 pull-out compartment, countertop including one cut-out, for 1 above-counter basin central, 47 1/4" x 21 5/8" Inch	47 1/4" x 21 5/8" Inch	KT6696
Vanity unit wall-mounted 2 drawers, upper drawer including cut-out for siphon and siphon cover, countertop including one cut-out, for 1 above-counter basin central, 39 3/8" x 21 5/8" Inch	39 3/8" x 21 5/8" Inch	KT6655
Vanity unit wall-mounted 2 drawers, upper drawer including cut-out for siphon and siphon cover, countertop including one cut-out, for 1 above-counter basin central, 47 1/4" x 21 5/8" Inch	47 1/4" x 21 5/8" Inch	KT6656
Vanity unit wall-mounted 1 pull-out compartment, 1 countertop including one central cut-out, 32 7/8" x 22 1/4" Inch	32 7/8" x 22 1/4" Inch	S19526
Vanity unit wall-mounted 1 pull-out compartment, countertop including one cut-out, 48 5/8" x 22 1/4" Inch	48 5/8" x 22 1/4" Inch	S19528 L/M/R
Vanity unit wall-mounted 2 pull-out compartments, 1 countertop with one cut-out or two cut-outs, 56 1/2" x 22 1/4" Inch	56 1/2" x 22 1/4" Inch	S19529 B/L/R
Vanity unit for console 1 pull-out compartment, compartment consists of glass dividers and 2 boxes (small/large), 31 1/2" x 18 7/8" Inch	31 1/2" x 18 7/8" Inch	XL6501
Vanity unit for console 1 pull-out compartment, compartment consists of glass dividers and 2 boxes (small/large), 39 3/8" x 18 7/8" Inch	39 3/8" x 18 7/8" Inch	XL6502
Vanity unit for console 2 drawers, upper drawer including cut-out for siphon and siphon cover, 31 1/2" x 18 7/8" Inch	31 1/2" x 18 7/8" Inch	XL6511
Vanity unit for console 2 drawers, upper drawer including cut-out for siphon and siphon cover, 39 3/8" x 18 7/8" Inch	39 3/8" x 18 7/8" Inch	XL6512
Vanity unit for console 1 pull-out compartment, compartment consists of glass dividers and 2 boxes (small/large), 31 1/2" x 21 31 1/2" x 21 1/2" Inch 1/2" Inch	31 1/2" x 21 31 1/2" x 21 1/2" Inch 1/2" Inch	XL6713
Vanity unit for console 1 pull-out compartment, compartment consists of glass dividers and 2 boxes (small/large), 39 3/8" x 21 1/2" Inch	39 3/8" x 21 1/2" Inch	XL6715
Vanity unit for console 2 drawers, upper drawer including cut-out for siphon and siphon cover, 31 1/2" x 21 1/2" Inch	31 1/2" x 21 1/2" Inch	XL6714
Vanity unit for console 2 drawers, upper drawer including cut-out for siphon and siphon cover, 39 3/8" x 21 1/2" Inch	39 3/8" x 21 1/2" Inch	XL6716
Vanity unit for console 1 opened compartment including glass shelf, 31 1/2" x 21 1/2" Inch	31 1/2" x 21 1/2" Inch	XL6718
Vanity unit for console 2 drawers, upper drawer including cut-out for siphon and siphon cover, 31 1/2" x 18 7/8" Inch	31 1/2" x 18 7/8" Inch	H26311
Vanity unit for console 2 drawers, upper drawer including cut-out for siphon and siphon cover, 39 3/8" x 18 7/8" Inch	39 3/8" x 18 7/8" Inch	H26312
Vanity unit for console 2 drawers, upper drawer including cut-out for siphon and siphon cover, 31 1/2" x 21 5/8" Inch	31 1/2" x 21 5/8" Inch	H26301
Vanity unit for console 2 drawers, upper drawer including cut-out for siphon and siphon cover, 23 5/8" x 21 5/8" Inch	23 5/8" x 21 5/8" Inch	H26300
Vanity unit for console 2 drawers, upper drawer including cut-out for siphon and siphon cover, 39 3/8" x 21 5/8" Inch	39 3/8" x 21 5/8" Inch	H26302

**Vero Washbasin ground # 045470..25 / 045470..27 / 045470..28**

|&lt; 27 1/2" Inch &gt;|

Vanity unit for console 1 opened compartment including towel rail, 31 1/2" x 20 1/2" Inch	31 1/2" x 20 1/2" Inch	VE6541
Vanity unit for console 1 opened compartment including towel rail, 39 3/8" x 20 1/2" Inch	39 3/8" x 20 1/2" Inch	VE6542
Vanity unit for console 1 pull-out compartment, pull-out compartment including cut-out for siphon and siphon cover, 31 1/2" x 20 1/2" Inch	31 1/2" x 20 1/2" Inch	VE6551
Vanity unit for console 1 pull-out compartment, pull-out compartment including cut-out for siphon and siphon cover, 39 3/8" x 20 1/2" Inch	39 3/8" x 20 1/2" Inch	VE6552
Vanity unit for console 1 drawer, drawer including cut-out for siphon and siphon cover, 31 1/2" x 20 1/2" Inch	31 1/2" x 20 1/2" Inch	VE6561
Vanity unit for console 1 drawer, drawer including cut-out for siphon and siphon cover, 39 3/8" x 20 1/2" Inch	39 3/8" x 20 1/2" Inch	VE6562
Vanity unit for console 2 drawers, upper drawer including cut-out for siphon and siphon cover, 31 1/2" x 20 1/2" Inch	31 1/2" x 20 1/2" Inch	VE6571
Vanity unit for console 2 drawers, upper drawer including cut-out for siphon and siphon cover, 39 3/8" x 20 1/2" Inch	39 3/8" x 20 1/2" Inch	VE6572
Vanity unit for console 1 pull-out compartment, 32 1/4" x 18 3/4" Inch	32 1/4" x 18 3/4" Inch	LC6812
Vanity unit for console 1 pull-out compartment, 40 1/8" x 18 3/4" Inch	40 1/8" x 18 3/4" Inch	LC6813
Vanity unit for console with 2 drawers, upper drawer including cut-out for siphon and siphon cover, 32 1/4" x 18 3/4" Inch	32 1/4" x 18 3/4" Inch	LC6822
Vanity unit for console with 2 drawers, upper drawer including cut-out for siphon and siphon cover, 40 1/8" x 18 3/4" Inch	40 1/8" x 18 3/4" Inch	LC6823
Vanity unit for console 1 pull-out compartment, 32 1/4" x 21 1/2" Inch	32 1/4" x 21 1/2" Inch	LC6828
Vanity unit for console 1 pull-out compartment, 40 1/8" x 21 1/2" Inch	40 1/8" x 21 1/2" Inch	LC6829
Vanity unit for console with 2 drawers, upper drawer including cut-out for siphon and siphon cover, 32 1/4" x 21 1/2" Inch	32 1/4" x 21 1/2" Inch	LC6838
Vanity unit for console with 2 drawers, upper drawer including cut-out for siphon and siphon cover, 40 1/8" x 21 1/2" Inch	40 1/8" x 21 1/2" Inch	LC6839
Console for above-counter basin and vanity basin 1 console with one cut-out, Width min. see ordering information, Width max. 78 3/4", price per section of 3 7/8", basic price until 31 1/2", 21 5/8" Inch	21 5/8" Inch	LC096C
Console for above-counter basin and vanity basin 1 console with one cut-out, Width min. see ordering information, Width max. 78 3/4", price per section of 3 7/8", basic price until 31 1/2", 18 7/8" Inch	18 7/8" Inch	LC094C
Console for above-counter basin and vanity basin 1 console with two cut-outs, Width min. see ordering information, Width max. 78 3/4", price per section of 3 7/8", basic price until 31 1/2", 21 5/8" Inch	21 5/8" Inch	LC097C



**Vero Washbasin ground # 045470..25 / 045470..27 / 045470..28**

**|< 27 1/2" Inch >|**

*All drawings contain the necessary measurements which are subject to standard tolerances. They are stated in inch & mm and are non-binding. Exact measurements, in particular for customized installation scenarios, can only be taken from the finished ceramic piece.*