

Starck 3

Mounting instructions Urinal
Instrucciones de montaje Urinario

082444..92

082544..92

Specification

Ficha técnica

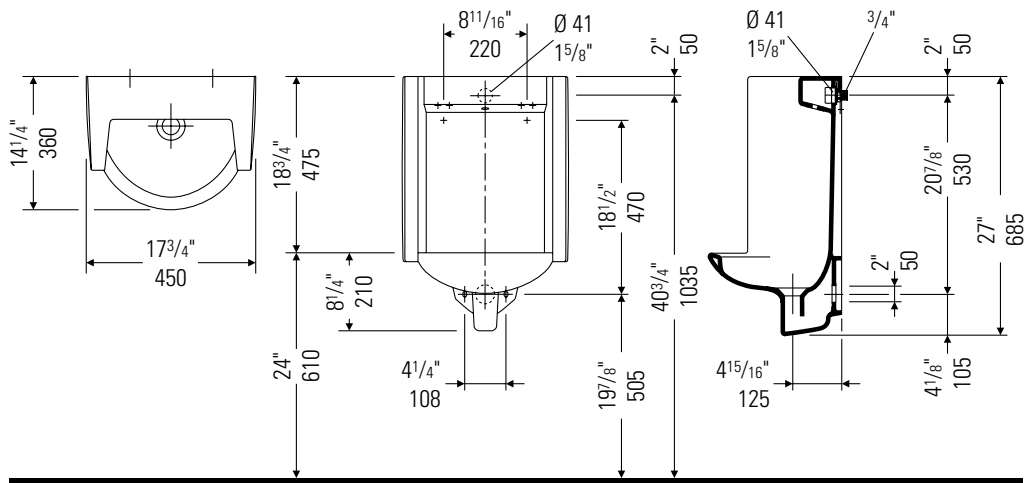

082444..92

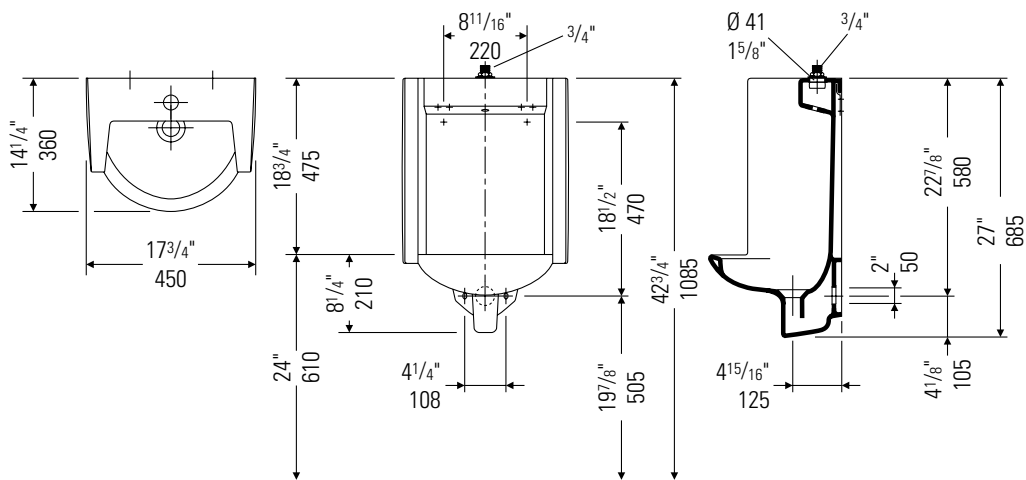

082544..92

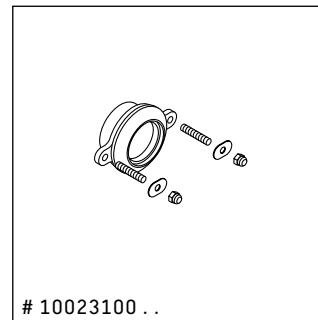
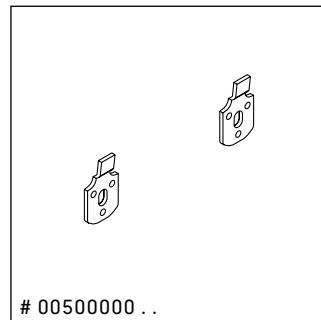
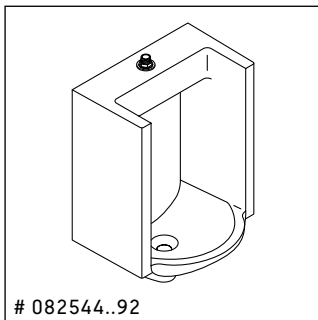

THIS CARTON CONTAINS:

1. Urinal Starck 3*
2. Installation manual
3. Fixings # 00500000 ..
4. Mounting flange # 10023100 ..

*To be installed only with a WaterSense labeled flush valve with the same flush rating.

ESTE CÁRTON CONTIENE:

1. Urinario Starck 3
2. Manual de instalación
3. Pletinas de fijación # 00500000 ..
4. Junta de montaje # 10023100 ..

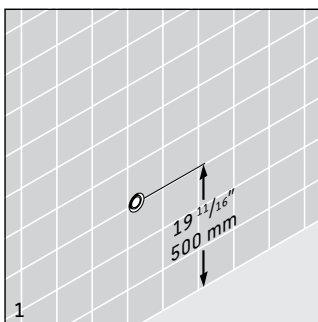

Please refer to the specification sheet for mounting dimensions.

Por favor, mire la ficha técnica para las medidas de montaje.

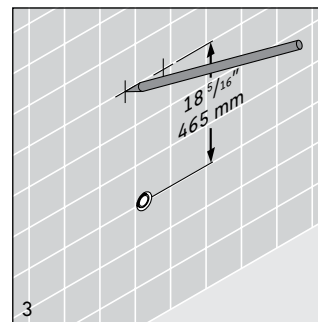
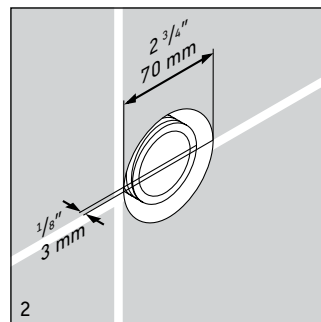

Measure and mark the position of the fixing points.

Medir y marcar las posiciones de los puntos de fijación.

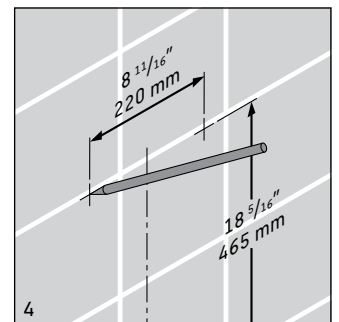

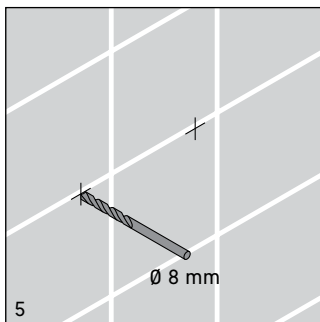

Drill two holes.

Taladrar dos agujeros.

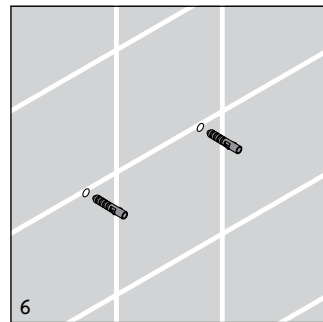

Place the anchors.

Colocar los tacos.

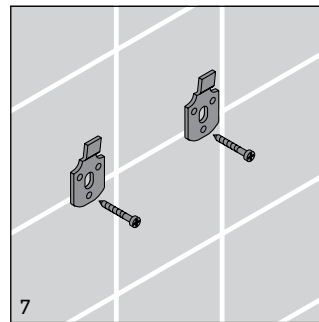

Fix the hooks, but don't tighten down the screws.

Fijar las pletinas de fijación pero dejándolas sueltas.

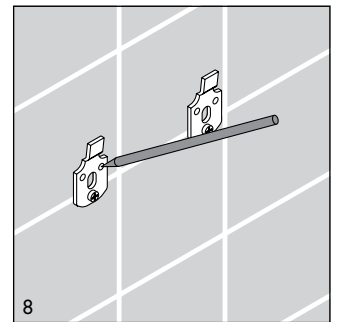

Mark the upper fixation points.

Marcar los puntos superiores de fijación.

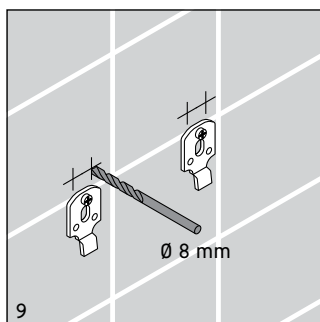

Drill the upper fixation holes.

Taladrar los agujeros superiores de fijación.

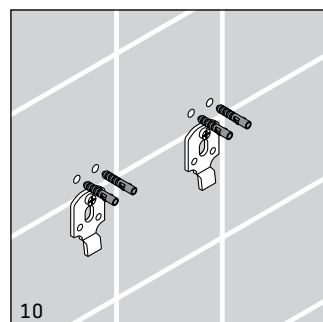

Place the anchors.

Colocar los tacos.

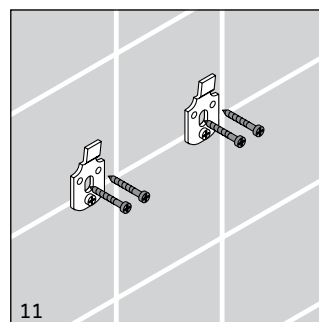

Fix the hooks and tighten down screws.

Fijar las pletinas de fijación y apretarlas fuertemente.

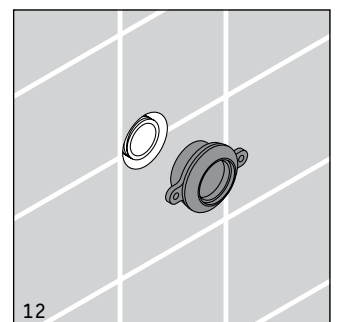

Place the outlet flange.

Colocar la junta de montaje (dasagüe)

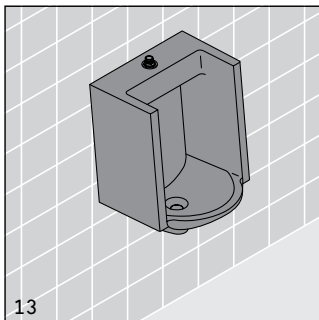

Hang the urinal.

Colocar el urinario.

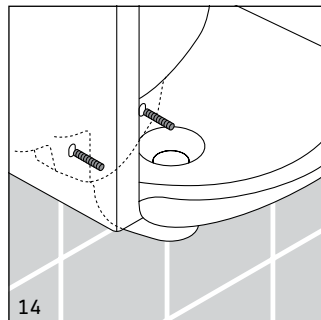

Attach screws.

Colocar los tornillos.

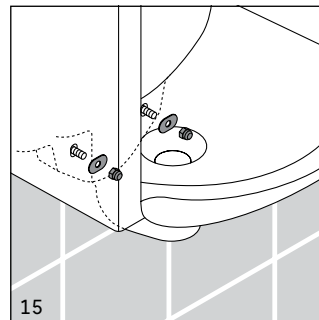

Attach the washers and nuts and tighten carefully.

Colocar también las arandelas y las tuercas y apretarlas con cuidado.

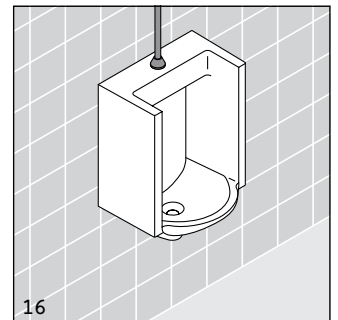

Connect flushometer according to the corresponding installation instruction.

Conectar el fluxometro según las instrucciones de montaje.

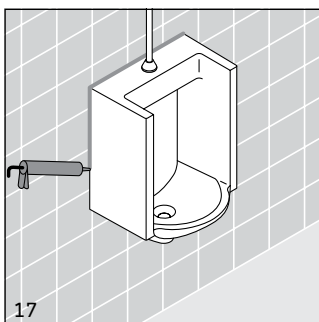

Add silicon around the base.

Sellar el urinario con silicona.

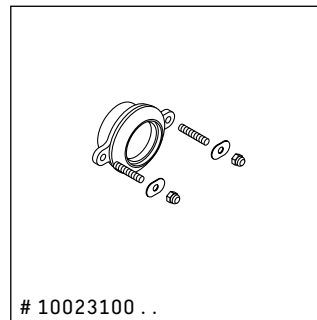
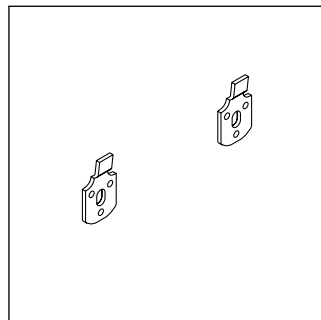
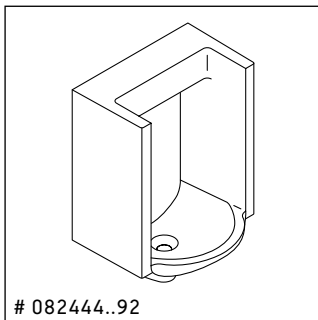

THIS CARTON CONTAINS:

1. Urinal Starck 3*
2. Installation manual
3. Fixings # 00500000 . .
4. Mounting flange # 10023100 . .

ESTE CÁRTON CONTIENE:

1. Urinario Starck 3
2. Manual de instalación
3. Pletinas de fijación # 00500000 . .
4. Junta de montaje # 10023100 . .

*To be installed only with a WaterSense labeled flush valve with the same flush rating.

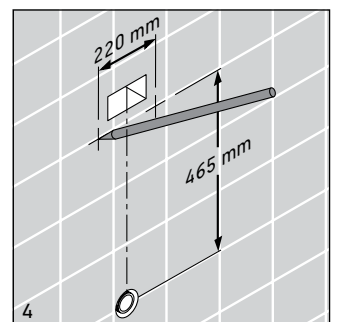
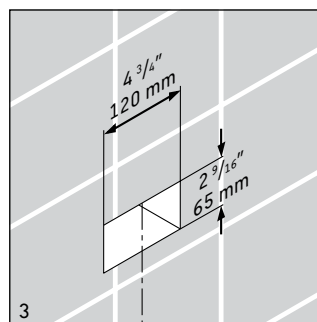
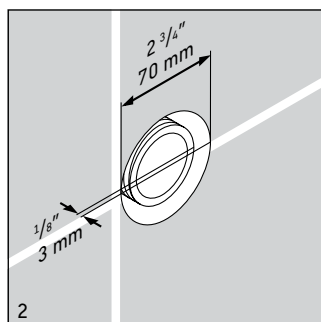
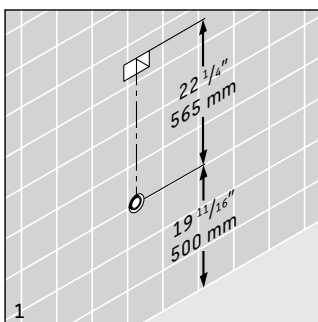

Please refer to the specification sheet for mounting dimensions.

Por favor, mire la ficha técnica para las medidas de montaje.

Measure and mark the position of the fixing points.

Medir y marcar las posiciones de los puntos de fijación.

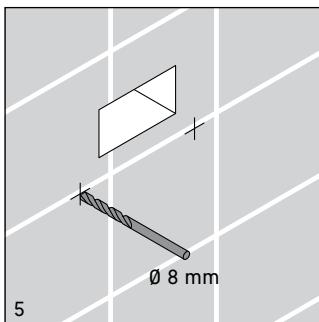

Drill two holes.

Taladrar dos agujeros.

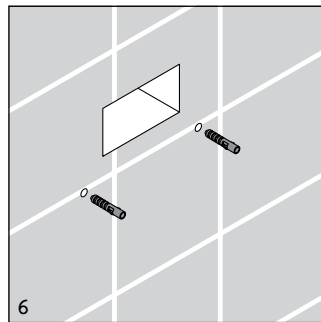

Place the anchors.

Colocar los tacos.

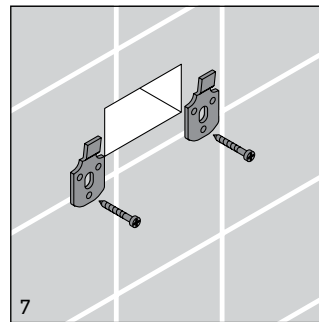

Fix the hooks, but don't tighten down the screws.

Fijar las pletinas de fijación pero dejándolas sueltas.

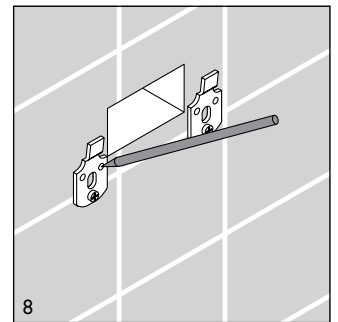

Mark the upper fixation points.

Marcar los puntos superiores de fijación.

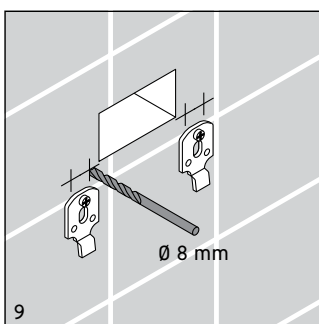

Drill the upper fixation holes.

Taladrar los agujeros superiores de fijación.

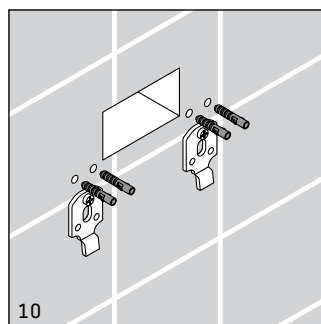

Place the anchors.

Colocar los tacos.

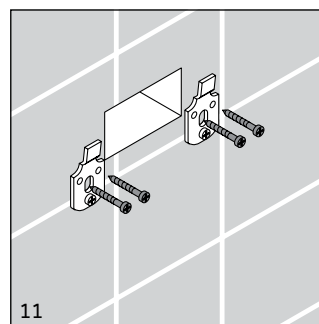

Fix the hooks and tighten down screws.

Fijar las pletinas de fijación y apretarlas fuertemente.

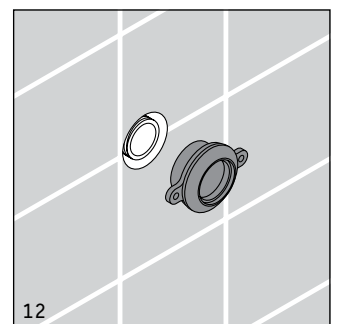

Place the outlet flange.

Colocar la junta de montaje (dasagüe)

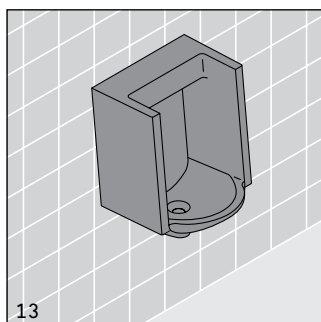

Hang the urinal.

Colocar el urinario.

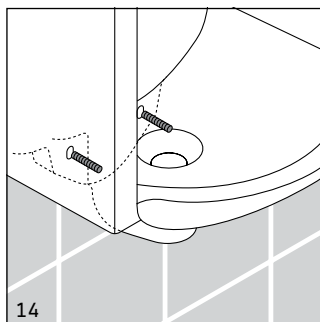

Attach screws.

Colocar los tornillos.

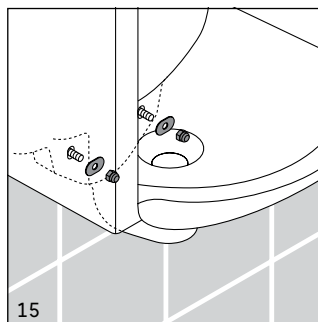

Attach the washers and nuts and tighten carefully.

Colocar también las arandelas y las tuercas y apretarlas con cuidado.

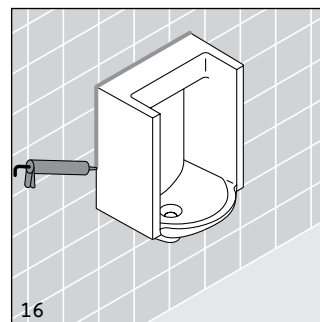

Add silicon around the base.

Sellar el urinario con silicona.