

HANDLE TRIMS

Finlandia (Code: D5)

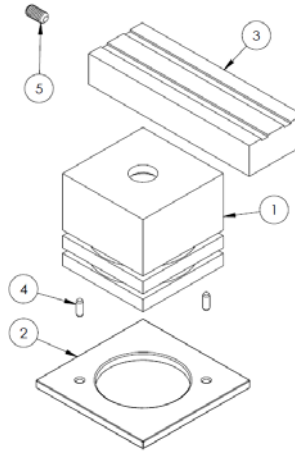

ITEM NO.	PART NUMBER	QTY.
1	D5-ESC	1
2	D5-ESC-RING	1
3	D5-LVR	1
4	ASME B18.8.2 - 0.0937x0.25	2
5	SSCUPSKT 0.164-32x0.3125-HX-S	1

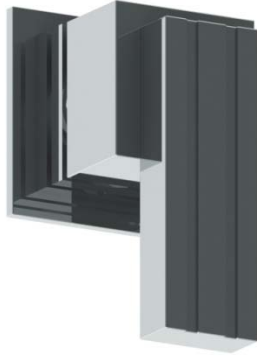
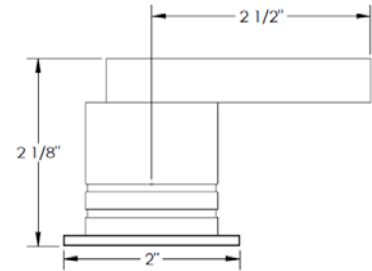

Scania (Code: D6)

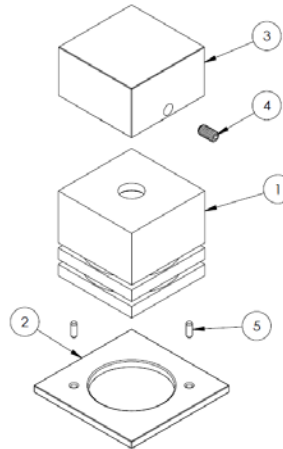

ITEM NO.	PART NUMBER	QTY.
1	D5-ESC	1
2	D5-ESC-RING	1
3	D6-KNOB	1
4	SSCUPSKT 0.164-32x0.3125-HX-S	1
5	ASME B18.8.2 - 0.0937x0.25	2

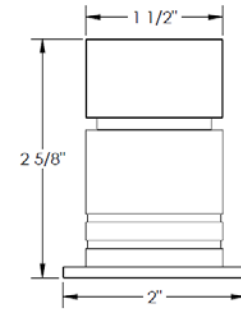

Woolworth (Code: CC11)

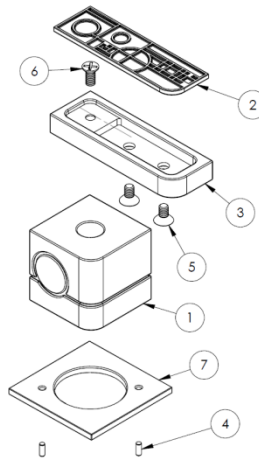

ITEM NO.	PART NUMBER	QTY.
1	CC11-POST-(RGHT/LEFT)	1
2	CC11-LVR-TOP-(RGHT/LEFT)	1
3	CC11-LVR-BASE-(RGHT/LEFT)	1
4	DPM 0.0938x0.25	2
5	SCHCSCREW 0.164-32x0.3125x0.3125-HX-S	2
6	CR-FHMS 0.164-32x0.375x0.375-S (UNDERCUT HEAD)	1
7	D5-ESC-RING	1

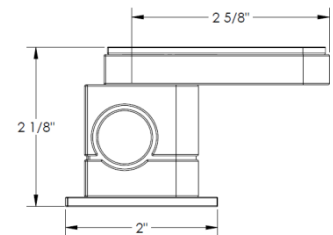

Specification from Finished Wall to Tip of Broach Stem

HANDLE TRIM #	MEASUREMENT (IN.)
D5/ D6	2 ½
CC11	2 ½

Note: When fitting handle it may be necessary to shorten broach stem and/or threaded nipple to eliminate gap between handle and escutcheon

IMPORTANT INSTALLATION INFORMATION

- USE TEFLON TAPE OR PIPE SEALANT FOR THREADED CONNECTIONS
- DO NOT USE PLUMBER'S PUTTY ON ANY OF THE BRASS COMPONENTS
This will cause the finish to tarnish and void the warranty. A non-corrosive Alkoxy Silicone is recommended.
- DURING SWEATING OF LINES DO NOT OVERHEAT CASTING
Overheating may cause damage to internal mechanism
- COPPER ADAPTORS MAY BE REQUIRED TO COMPLETE YOUR INSTALLATION

For technical support, please call 718-257-2800