

HANDLE TRIMS

Sky (Code: BL1)

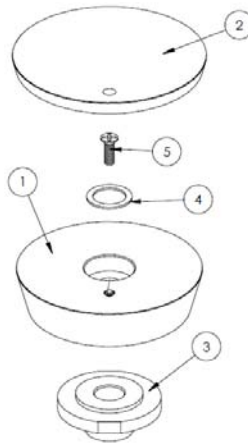

ITEM NO.	PART NUMBER	QTY.
1	WTR-BL1-KNOB	1
2	WTR-BL1-CAP	1
3	MGNT-WTR-LOCK-NUT	1
4	.760x.558x.034-PLSTC-WSHR	1
5	CR-FHMS 0.164-32x0.5x0.5-S	1

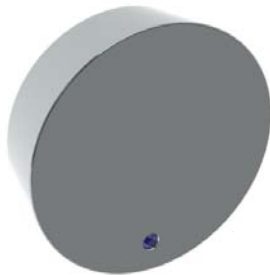
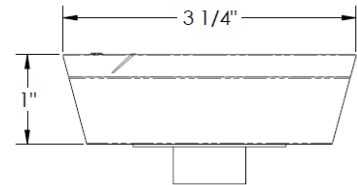

Carribean (Code: BL2)

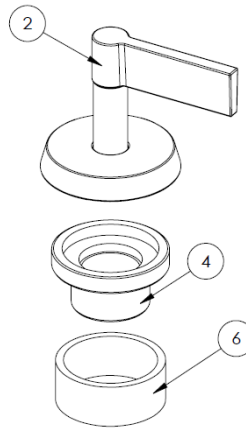

ITEM NO.	PART NUMBER	QTY.
2	SL-LVR	1
4	SL-TOP-LOCK-NUT	1
6	1.75x.125x.72-PLSTC-CLLR	1

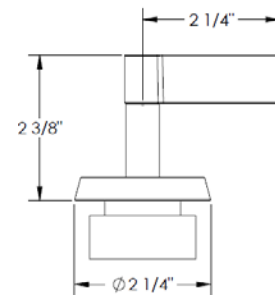

Royal (Code: BL3)

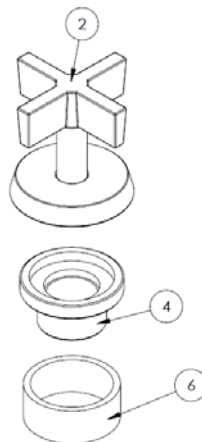
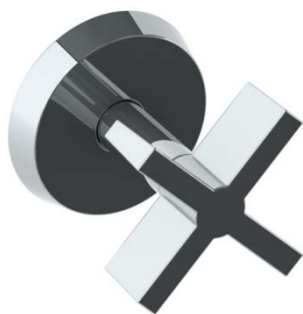

ITEM NO.	PART NUMBER	QTY.
2	SX-CRSS-HNDL	1
4	SL-TOP-LOCK-NUT	1
6	1.75x.125x.72-PLSTC-CLLR	1

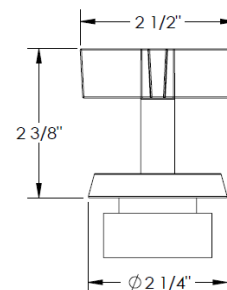

Specification from Finished Wall to Tip of Broach Stem

HANDLE TRIM #	MEASUREMENT (IN.)
BL1	1 3/8
BL2/ BL3	1 1/2

Note: When fitting handle it may be necessary to shorten broach stem and/or threaded nipple to eliminate gap between handle and escutcheon

IMPORTANT INSTALLATION INFORMATION

- USE TEFLON TAPE OR PIPE SEALANT FOR THREADED CONNECTIONS
- DO NOT USE PLUMBER'S PUTTY ON ANY OF THE BRASS COMPONENTS
This will cause the finish to tarnish and void the warranty. A non-corrosive Alkoxy Silicone is recommended.
- DURING SWEATING OF LINES DO NOT OVERHEAT CASTING
Overheating may cause damage to internal mechanism
- COPPER ADAPTORS MAY BE REQUIRED TO COMPLETE YOUR INSTALLATION

For technical support, please call 718-257-2800