

HANDLE TRIMS

Rachel (Code: SA1)

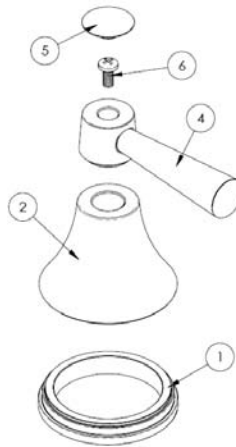

ITEM NO.	PART NUMBER	QTY.
1	SA1-ESC-RING	1
2	SA1-ESC	1
4	SA1-LVR	1
5	SA1-POST-CAP	1
6	CR-PHMS 0.164-32x0.375x0.375-S	1

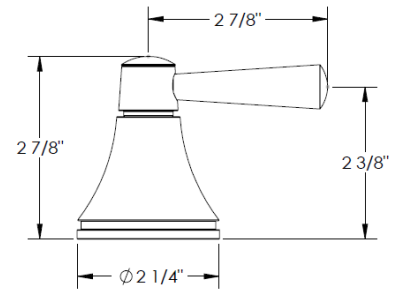

Deena (Code: SA2)

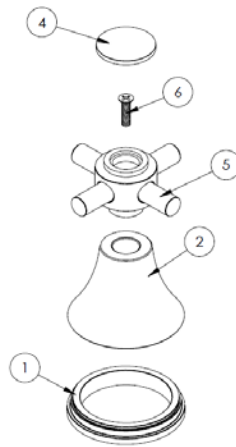

ITEM NO.	PART NUMBER	QTY.
1	SA1-ESC-RING	1
2	SA1-ESC	1
4	SA2-POST-CAP	1
5	SA2-ARM	4
6	CR-FHM1 0.164-32x0.625x0.625-S	1

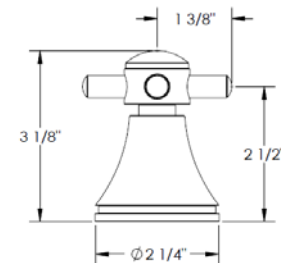

Gehry (Code: CC61)

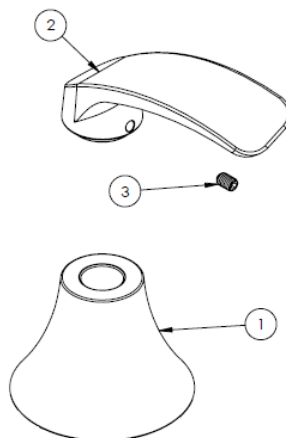

ITEM NO.	PART NUMBER	QTY.
1	SA1-ESC	1
2	CC61-LVR-(RGHT/LEFT)	1
3	SSCUPSKT 0.164-32x0.25-HX-S	1

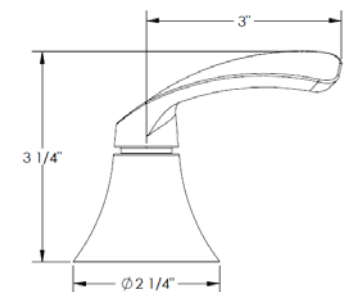

Specification from Finished Wall to Tip of Broach Stem

HANDLE TRIM #	MEASUREMENT (IN.)
SA1	2 3/4
SA2	3
CC61	2 1/2

Note: When fitting handle it may be necessary to shorten broach stem and/or threaded nipple to eliminate gap between handle and escutcheon

IMPORTANT INSTALLATION INFORMATION

- USE TEFLON TAPE OR PIPE SEALANT FOR THREADED CONNECTIONS
- DO NOT USE PLUMBER'S PUTTY ON ANY OF THE BRASS COMPONENTS
This will cause the finish to tarnish and void the warranty. A non-corrosive Alkoxy Silicone is recommended.
- DURING SWEATING OF LINES DO NOT OVERHEAT CASTING
Overheating may cause damage to internal mechanism
- COPPER ADAPTORS MAY BE REQUIRED TO COMPLETE YOUR INSTALLATION

For technical support, please call 718-257-2800