

FEATURES

- ¼ turn washerless ceramic disc valve cartridges
- Flexible hose connection for 8" to 16" spread installations
- Flow rate 1.5 gpm (5.7 lpm) maximum flow rate
- Solid brass construction
- Listed by IAPMO, CSA, NSF, and other municipalities
- Warranty:
 - Limited lifetime warranty (residential use)
 - One year (commercial use)
- Shipping weight (lbs.) 10
- Shipping dimensions (in.): 29x12x4

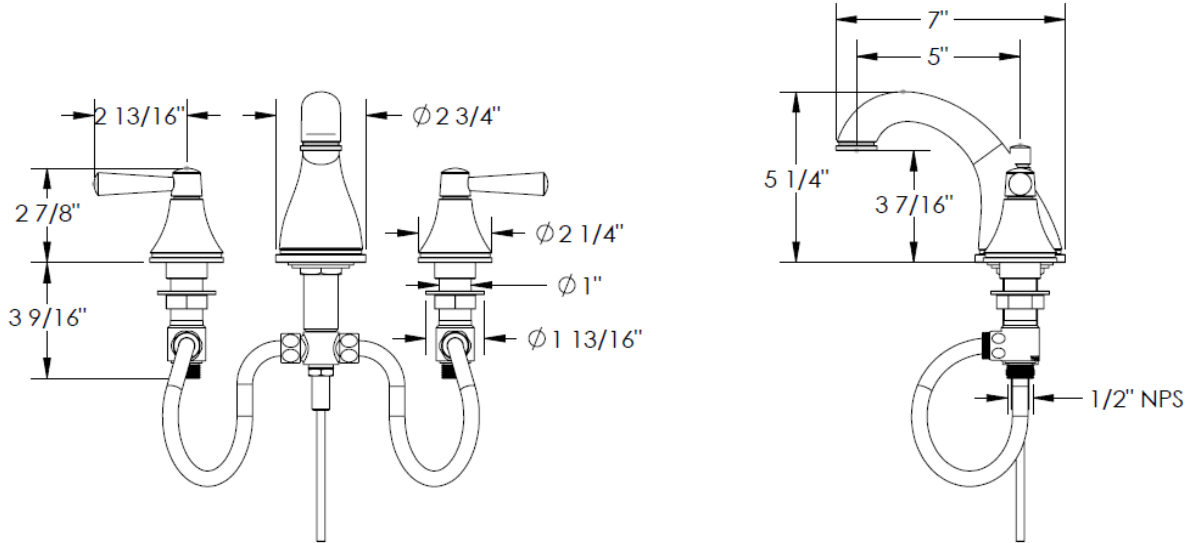

ITEM NO.	PART NUMBER	QTY.
1	32-2 SPOUT	1
2	32-2 BASE RING	1
3	NEOPERL PCA PL STD	1
4	32-2 NOSE RING	1
5	KB-292	1
6	29-2-AERATOR WASHER	1
11	502 T GASKET	1
12	502-TEE	1
13	O-018 O-RING	1
14	502 LOCK NUT	1
15	172 BRASS WASHER	1
16	2IN OD GASKET	1
18	502 FLEX HOSE	2
19	142-LOCK-NUT	2
20H/20C	SS-502 Valve Body	2
21H/21C	SS-502 Cartridge	2
22	501-HEX-NUT	1
36	L4-TOP-LOCK-NUT	2

HANDLE TRIMS

Rachel (Code: SA1)

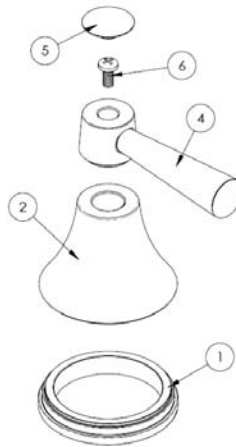

ITEM NO.	PART NUMBER	QTY.
1	SA1-ESC-RING	1
2	SA1-ESC	1
4	SA1-LVR	1
5	SA1-POST-CAP	1
6	CR-PHMS 0.164-32x0.375x0.375-S	1

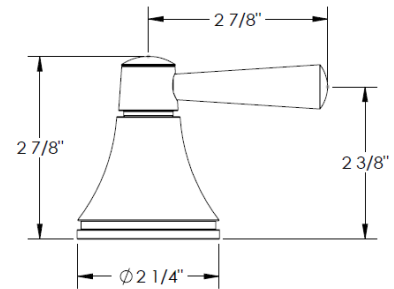

Deena (Code: SA2)

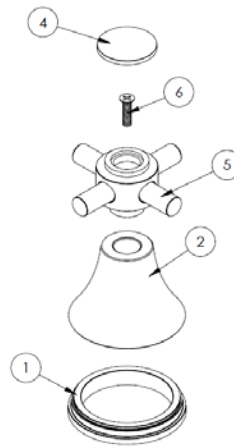

ITEM NO.	PART NUMBER	QTY.
1	SA1-ESC-RING	1
2	SA1-ESC	1
4	SA2-POST-CAP	1
5	SA2-ARM	4
6	CR-FHM1 0.164-32x0.625x0.625-S	1

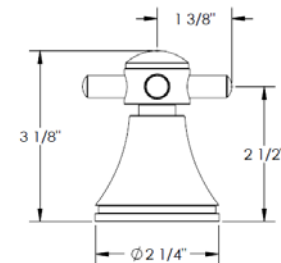

Gehry (Code: CC61)

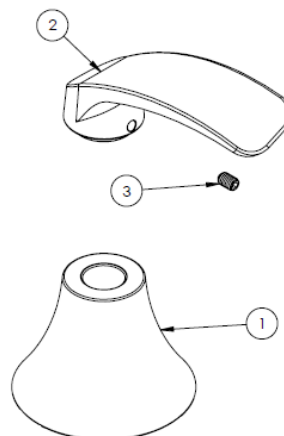

ITEM NO.	PART NUMBER	QTY.
1	SA1-ESC	1
2	CC61-LVR-(RGHT/LEFT)	1
3	SSCUPSKT 0.164-32x0.25-HX-S	1

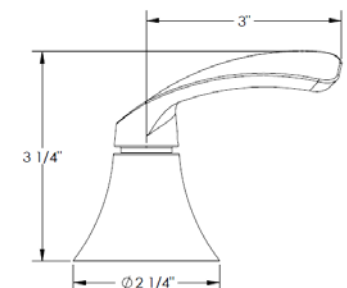

IMPORTANT INSTALLATION INFORMATION

- USE TEFLON TAPE OR PIPE SEALANT FOR THREADED CONNECTIONS
- DO NOT USE PLUMBER'S PUTTY ON ANY OF THE BRASS COMPONENTS
This will cause the finish to tarnish and void the warranty. A non-corrosive Alkoxy Silicone is recommended.
- DURING SWEATING OF LINES DO NOT OVERHEAT CASTING
Overheating may cause damage to internal mechanism
- COPPER ADAPTORS MAY BE REQUIRED TO COMPLETE YOUR INSTALLATION

For technical support, please call 718-257-2800

Rev. 1/1