

## THANK YOU FOR CHOOSING RYVYR

Please take a few minutes to review this manual before you start installation. If you encounter any installation problems, please don't hesitate to contact us. Before you begin, please observe all local building codes. Unpack the new product and inspect for damage. The appearance of your mirror may differ from the illustrations in this guide. These instructions still apply. Please ensure the finished wall is straight and plumb and the floor is flat and perpendicular to the finished wall.

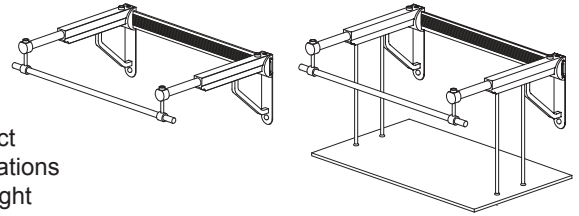

## SUGGESTED TOOLS AND MATERIALS



Flat Head Screwdriver



Phillips Screwdriver



Level



Drill



Tape Measure



Safety Glasses

## PARTS / HARDWARE INCLUDED

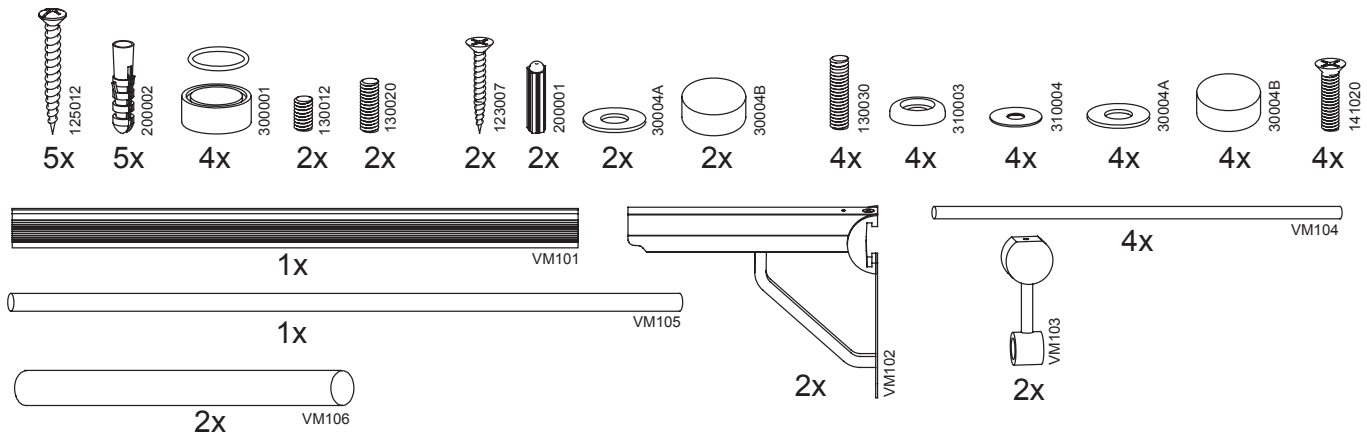

## BRACKET INSTALLATION

1

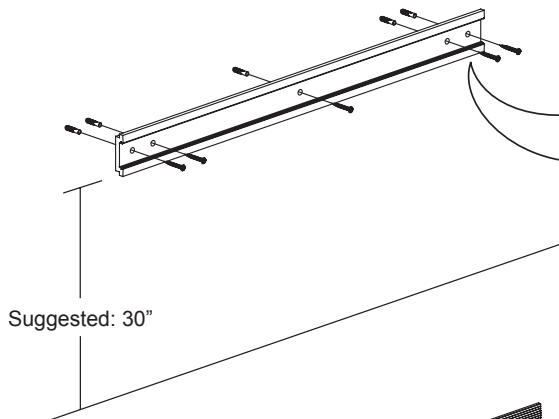

Suggested: 30"

2

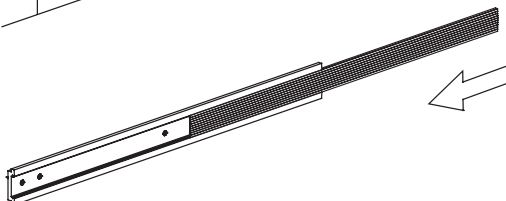

3

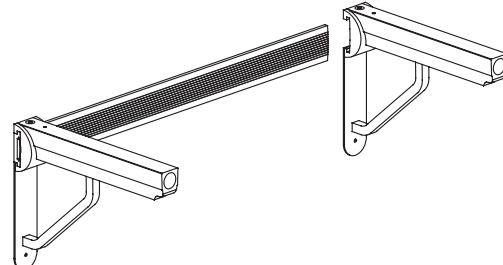

## BRACKET INSTALLATION (PAGE 2)

4

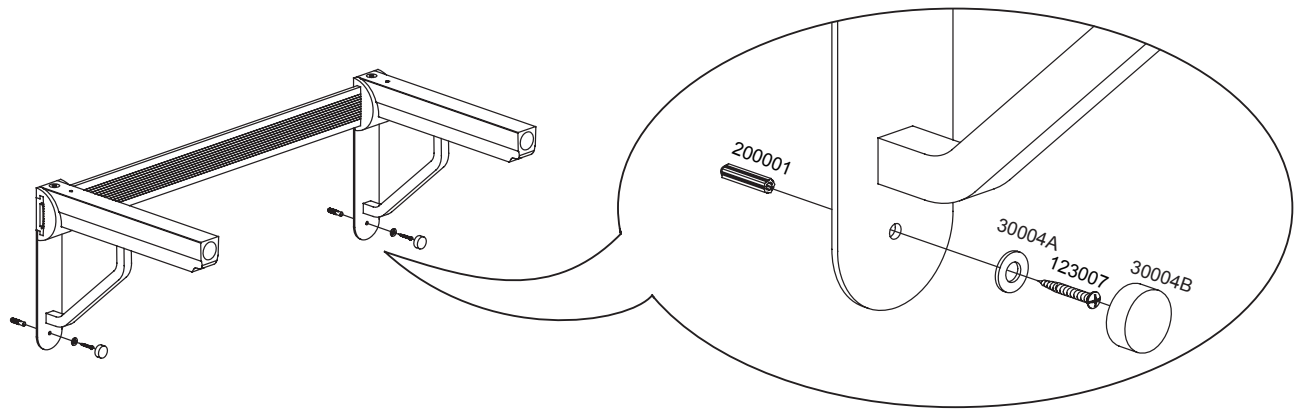

5

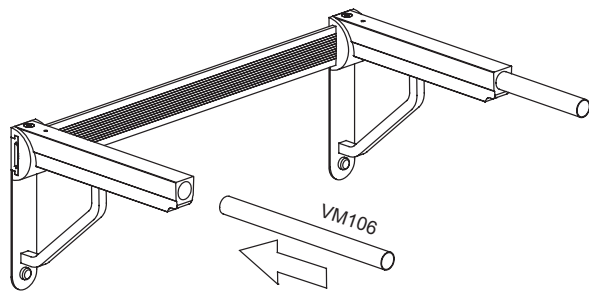

6

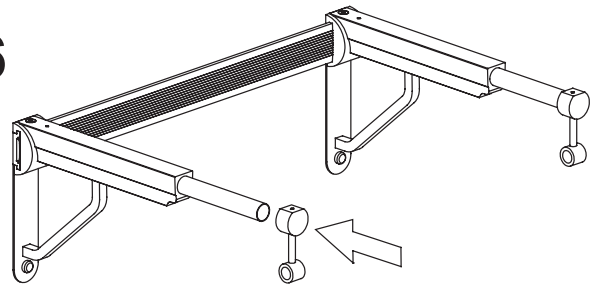

7

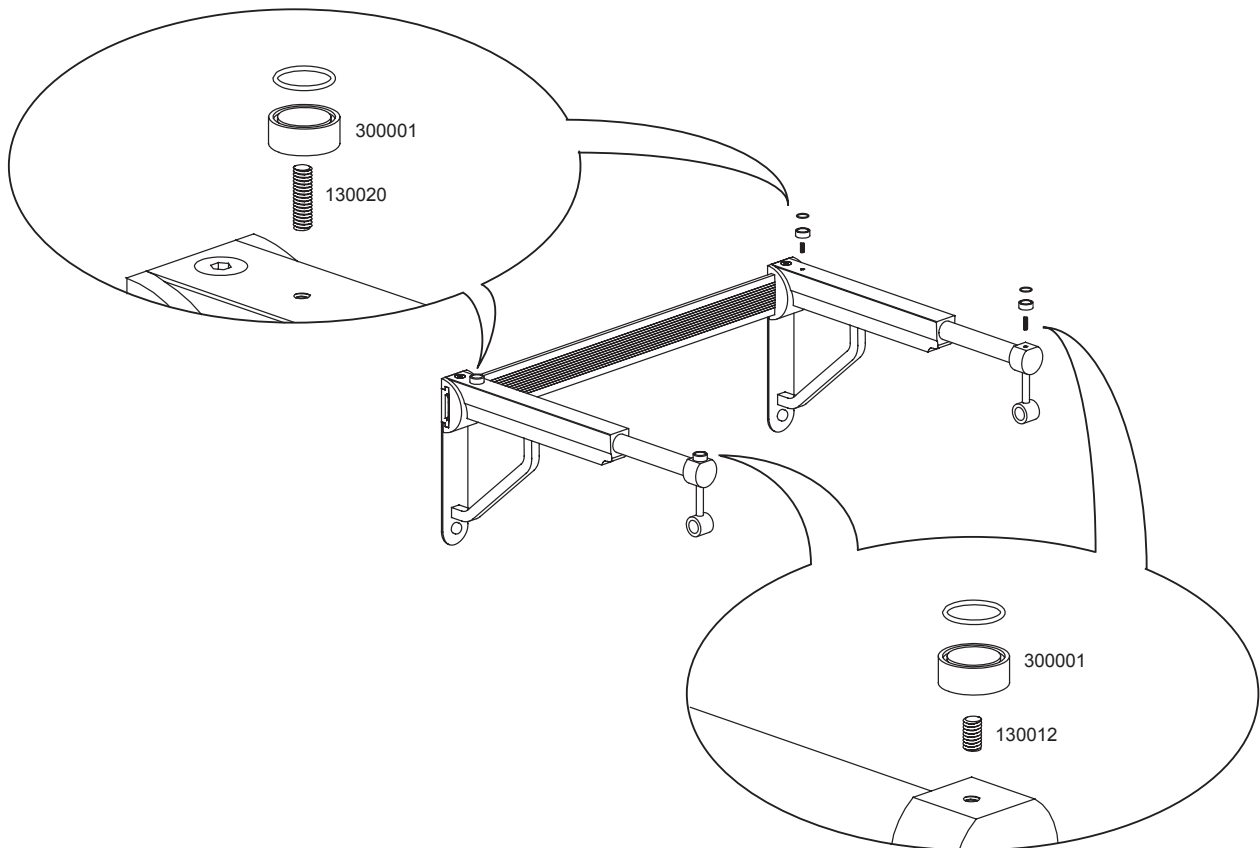

## BRACKET INSTALLATION (PAGE 3)

8

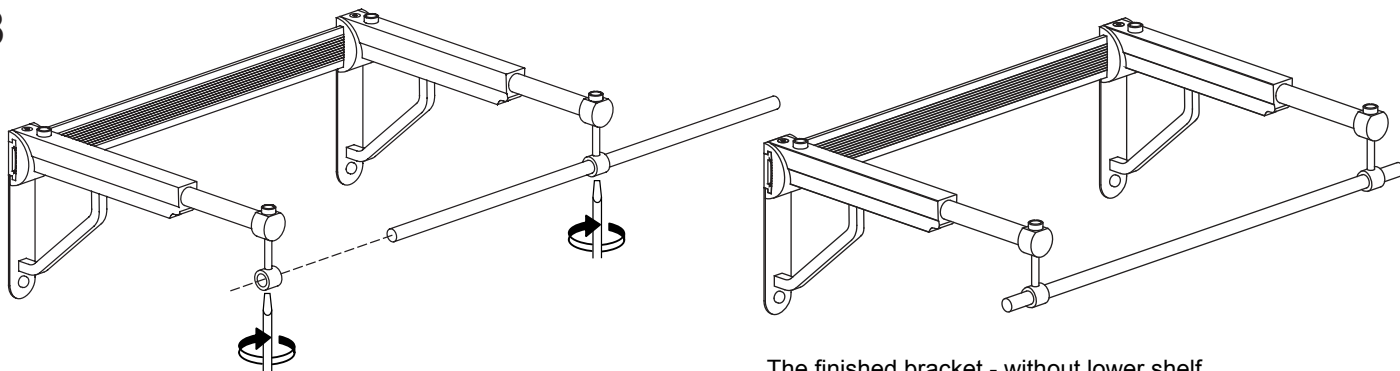

The finished bracket - without lower shelf

## LOWER SHELF INSTALLATION (Optional)

9

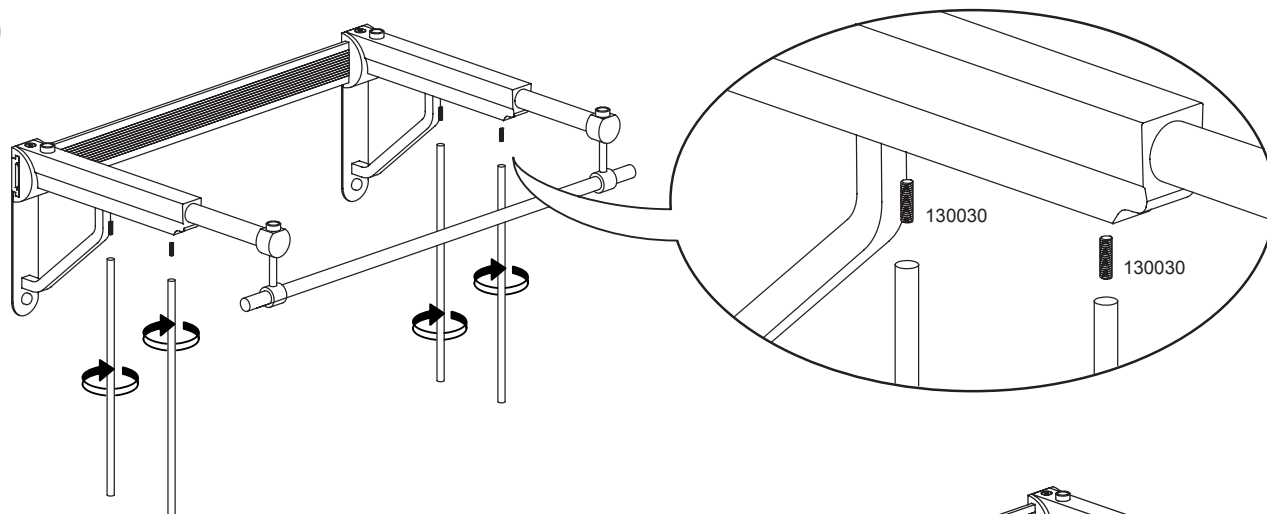

10

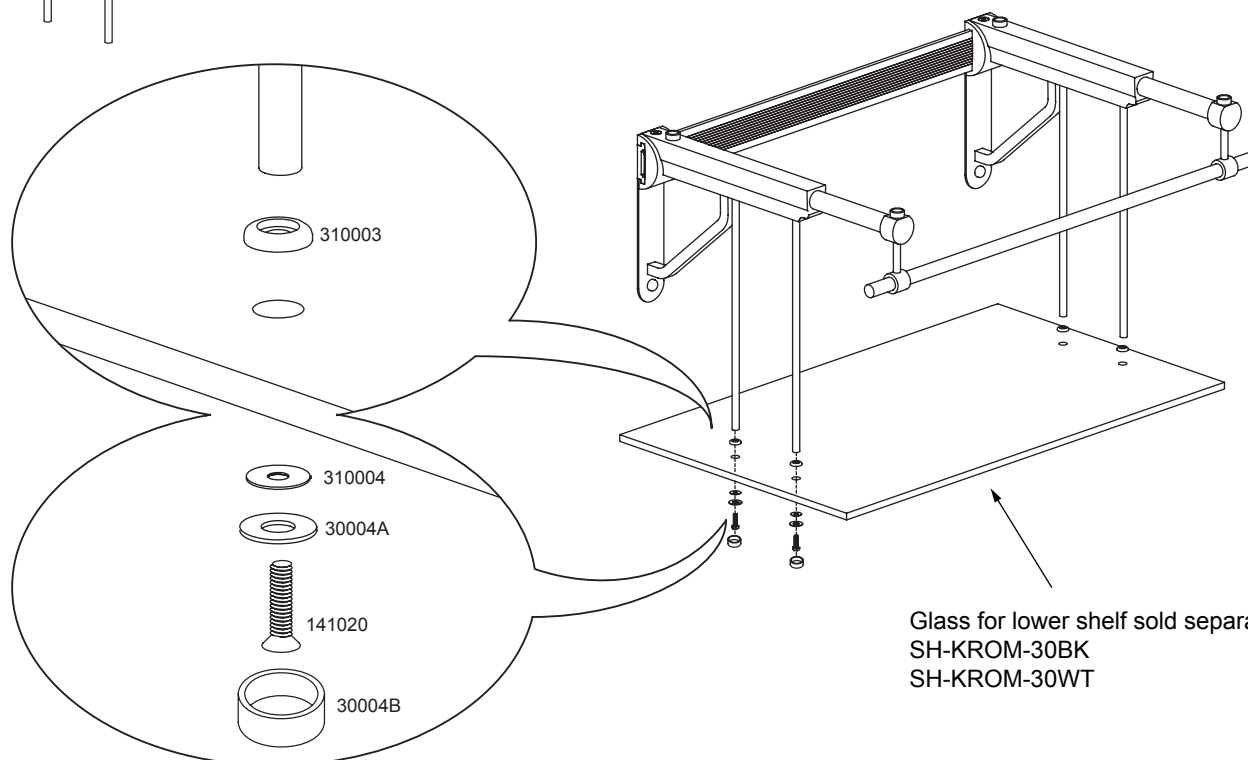

Glass for lower shelf sold separately:  
SH-KROM-30BK  
SH-KROM-30WT

## ROUGH-IN DIMENSIONS: WALL MOUNT

Shown without optional shelf

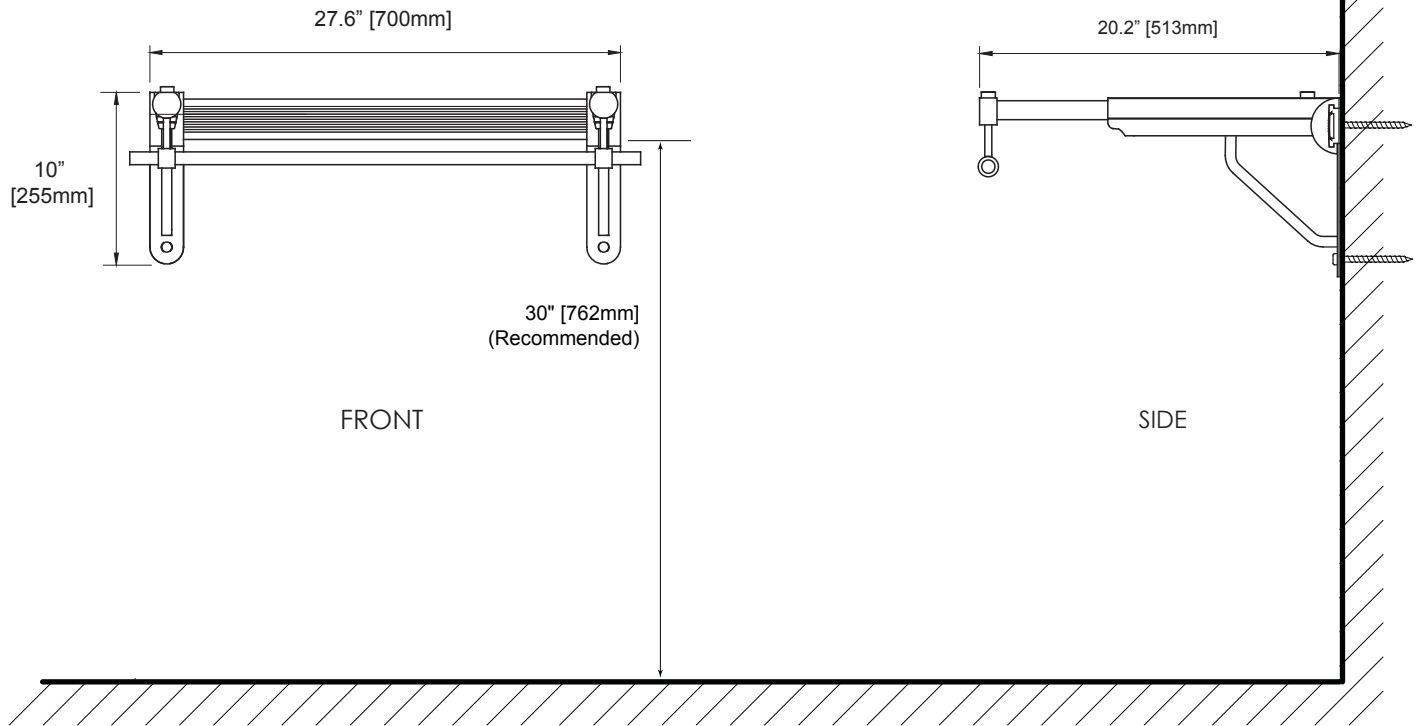

## WALL PREPARATION

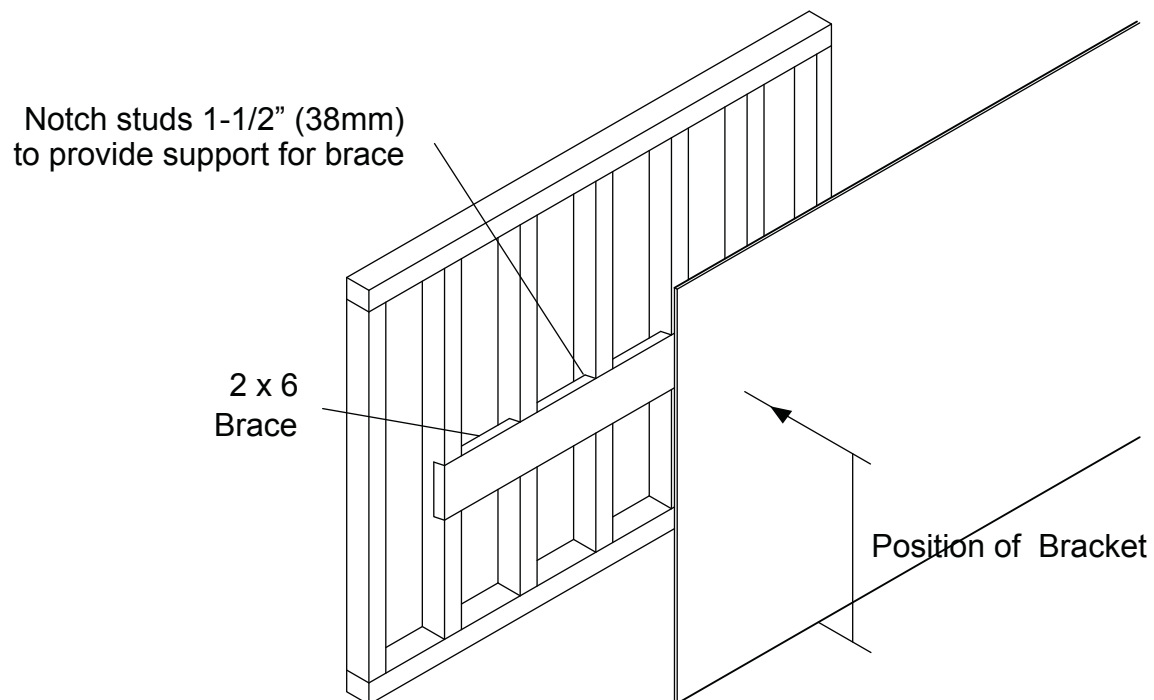

---

## SINK TOP INSTALLATION

1

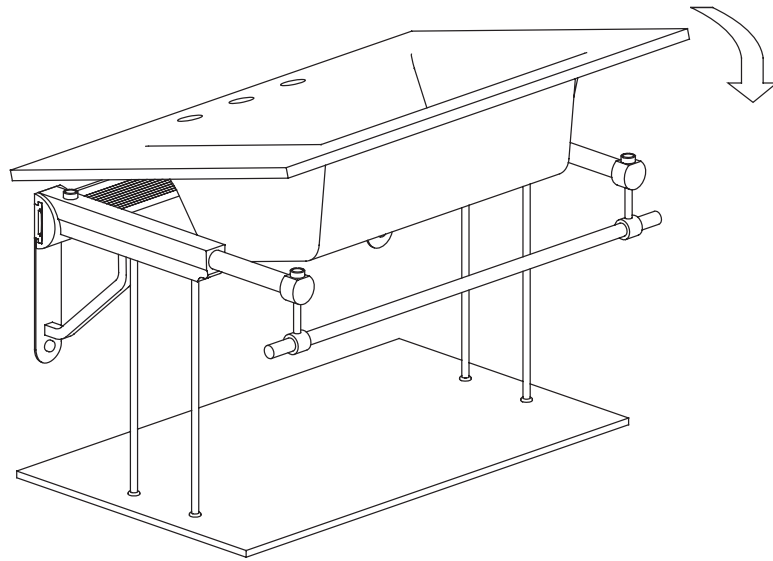

2

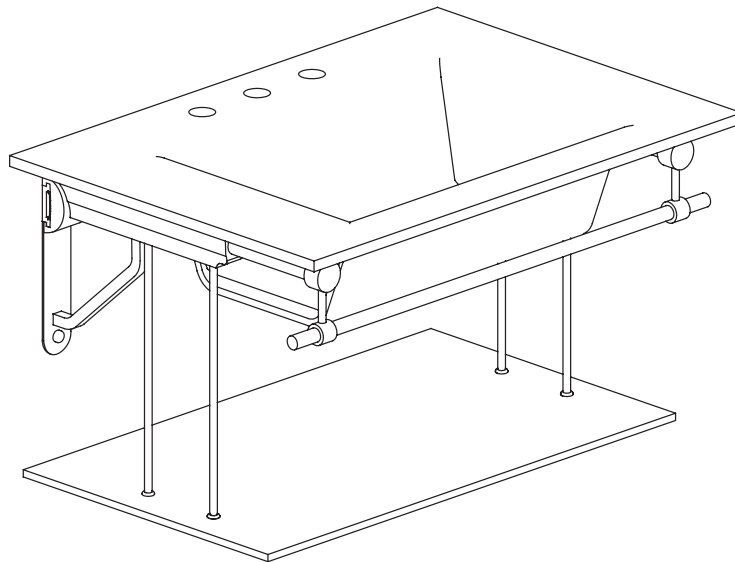

---

## CARE AND CLEANING

- Clean the bracket and shelf with a soft, slightly damp cloth. When cleaning the bracket and/or shelf, spray with a glass cleaner and wipe clean. Avoid using silicone cleaners and waxes.