

TO-PBL-48
TO-PBL-48X
TO-PB2L-48
TO-PB2L-48X

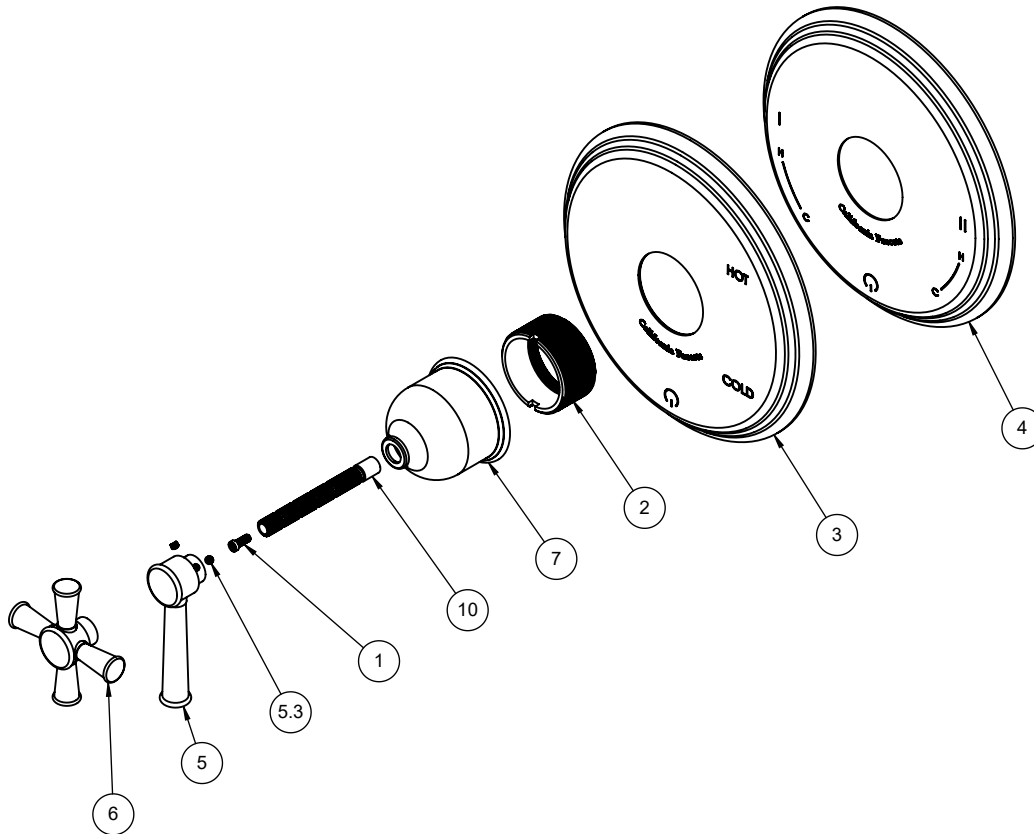

To order spare parts add and/or replace as stated below:

SPD- prefix added to part number(s)
-ZZ replaced with finish code (see finish table)
-WW replaced with **-90** (light finish) or **-96** (dark finish)

Ex: **SPD-7-100463-PC** or **SPD-86030-96**

ITEM	PART NO.	DESCRIPTION	QTY
1	86078-90	SCREW, M4 X 0.7 X 10MM, w/Ø5.80 PHL PH HD SS	1
2	10292-98	BUSHING, PB G2	1
for TO-PBL	3	7-100105-ZZ ASM, TRAD PB PLATE & GASKET	1
for TO-PB2L	4	7-100546-ZZ ASM, TRAD PB2 PLATE & GASKET	1
for 48 Series	5	7-100114-ZZ ASM, LEVER HANDLE - TRAD (incl. 5.3)	1
	5.3	86030-WW SETSCREW 8-32 X 1/8 SCKT HD CUP PT SS	2
for 48X Series	6	7-100113-ZZ ASM, CROSS HANDLE - TRAD (incl. 5.3)	1
	7	10293-ZZ ESCUTCHEON, TRAD, PB G2	1
for ITEM 5.3	8	882042-99 KEY, ALLEN, 5/64", BLACK	1
	10	880137-98 BROACH EXTENSION 3-1/4"(L) X 16T(M) X 20T(F)	1