

△ REQUIRES ITEM 7 OR 8

TO-PBL-68
TO-PBL-68-MIDX
TO-PB2L-68
TO-PB2L-68-MIDX

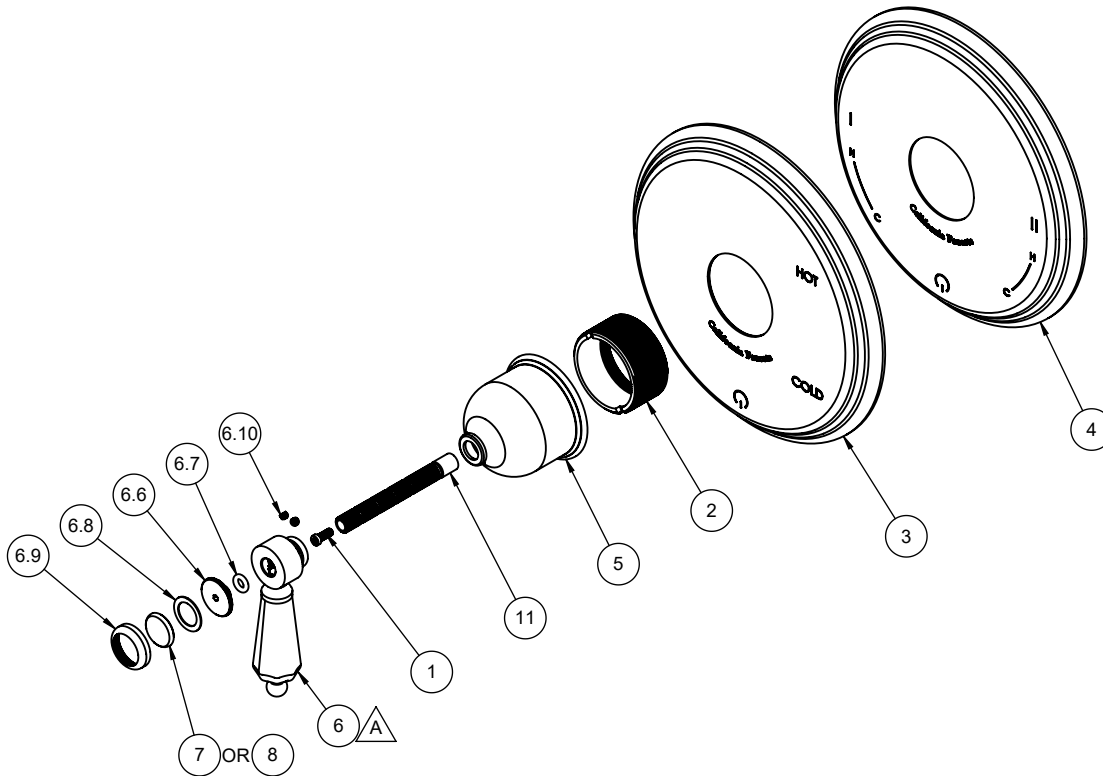

To order spare parts add and/or replace as stated below:

SPD- prefix added to part number(s)
-ZZ replaced with finish code (see finish table)
-WW replaced with **-90** (light finish) or **-96** (dark finish)

Ex: **SPD-7-100463-PC** or **SPD-86030-96**

ITEM	PART NO.	DESCRIPTION	QTY
1	86078-90	SCREW, M4 X 0.7 X 10MM, w/Ø5.80 PHL PH HD SS	1
2	10292-98	BUSHING, PB G2	1
for TO-PBL 3	7-100105-ZZ	ASM, TRAD PB PLATE & GASKET	1
for TO-PB2L 4	7-100546-ZZ	ASM, TRAD PB2 PLATE & GASKET	1
5	10293-ZZ	ESCUTCHEON, TRAD, PB G2	1
6	7-100220-ZZ	ASM, HANDLE, RD HUB & FLUTED INSERT W/BEZEL (incl. 6.6, 6.7, 6.8, 6.9, 6.10)	1
6.6	10610-15B	INSERT, THD, BEZEL HDL	1
6.7	87154-80	O-RING Ø5.23 X 2.62 (-107) BUNA-N A70	1
6.8	87136-80	WSHR Ø14.00 X Ø20.50 X 0.60MM	1
6.9	10575-ZZ	BEZEL, MULTI HANDLE	1
6.10	86030-WW	SETScrew 8-32 X 1/8 SCKT HD CUP PT SS	2
for 68 Series 7	471071-40	BUTTON, INDEX, 47, BLANK, PORC (Ø20 X 5.5MM)	1
for 68-MIDX Series 8	471168-ZZ	BUTTON, INDEX, METAL	1
for ITEM 6.10 9	882042-99	KEY, ALLEN, 5/64", BLACK	1
11	880137-98	BROACH EXTENSION 3-1/4"(L) X 16T(M) X 20T(F)	1