

GROHSAFE 2000 AUTHENTIC

Dual function pressure balance trim with control module

MODEL # 19844

Pure Freude an Wasser



GROHE America, Inc | 200 North Gary Avenue, Suite G, Roselle, IL 60172
 Phone: +1 (800) 444-7643 | Fax: +1 (800) 225-2778 | us-customerservice@grohe.com

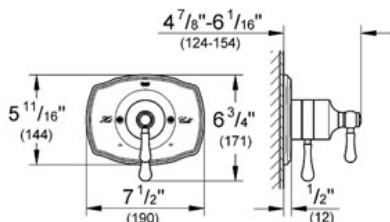
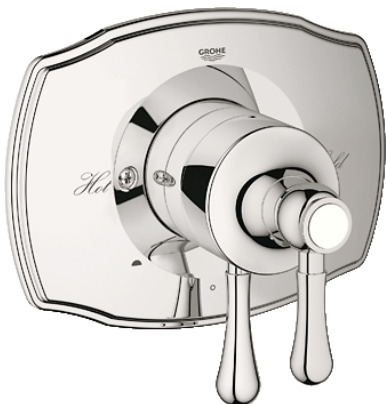

ADA

Product Description:

Dual function pressure balance trim with control module

Standard Specification:

- For shower/tubs with non-diverter tub spout or for 2 shower outlet applications
- Integrated volume control
- 2-way diverter function
- 1 axis operation
- For use with GrohFlex™ universal rough-in box 35 026 000 sold separately
- Max Flow Rate:
- Max Flow Rate 6.6 gpm at 45 psi (25 l/m)
- Code Compliance:
 - ASME/ANSI A112.18.1M
 - CSA Standard B125.1-05
 - ADA Compliant

Applicable Codes & Standards:

- Energy Policy Act of 1992
- ASME A112.18.1/CSA B125.1
- ICC/ANSI A117.1

Color:

- 19844 BE0 Sterling inf
- 19844 EN0 Brushed Nickel
- 19844 ZB0 Oil Rubbed Bronze
- 19844 000 chrome

