

GROHSAFE 2000 AUTHENTIC

Dual function pressure balance trim with control module

MODEL # 19844

Pure Freude an Wasser



GROHE America, Inc | 200 North Gary Avenue, Suite G, Roselle, IL 60172
 Phone: +1 (800) 444-7643 | Fax: +1 (800) 225-2778 | us-customerservice@grohe.com

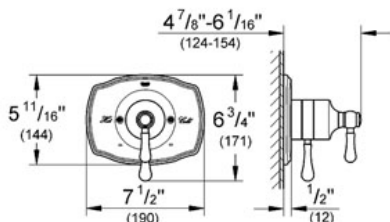

Product Description:
 Dual function pressure balance trim with control module

- Standard Specification:**
- For shower/tubs with non-diverter tub spout or for 2 shower outlet applications
 - Integrated volume control
 - 2-way diverter function
 - 1 axis operation
 - For use with GrohFlex™ universal rough-in box 35 026 000 sold separately
 - Max Flow Rate:
 - Max Flow Rate 6.6 gpm at 45 psi (25 l/m)
 - Code Compliance:
 - ASME/ANSI A112.18.1M
 - CSA Standard B125.1-05
 - ADA Compliant

- Applicable Codes & Standards:**
- Energy Policy Act of 1992
 - ASME A112.18.1/CSA B125.1
 - ICC/ANSI A117.1

- Color:**
- 19844 BE0 Sterling inf
 - 19844 EN0 Brushed Nickel
 - 19844 ZB0 Oil Rubbed Bronze
 - 19844 000 chrome

