

# GROHTHERM 2000 AUTHENTIC

## Dual function thermostatic trim with control module

MODEL # 19825

Pure Freude an Wasser



GROHE America, Inc | 200 North Gary Avenue, Suite G, Roselle, IL 60172  
 Phone: +1 (800) 444-7643 | Fax: +1 (800) 225-2778 | us-customerservice@grohe.com

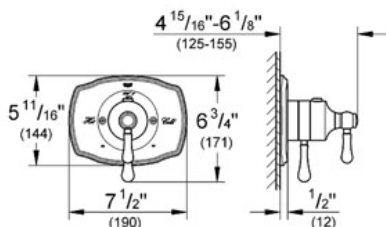

**Product Description:**  
 Dual function thermostatic trim with control module

- Standard Specification:**
- GROHE TurboStat® technology
  - For shower/tubs with non-diverter tub spout or for 2 shower outlet applications
  - Integrated volume control
  - 2-way diverter function
  - 1 axis operation
  - For use with GrohFlex™ universal rough-in box 35 026 000 sold separately
  - Max Flow Rate 6.6 at 45 psi (25 l/m)
  - Code Compliance:
    - ASME/ANSI A112.18.1M
    - CSA Standard B125.1-05

- Applicable Codes & Standards:**
- Energy Policy Act of 1992
  - ASME A112.18.1/CSA B125.1
  - ICC/ANSI A117.1

- Color:**
- 19825 ZB0 Oil Rubbed Bronze
  - 19825 EN0 Brushed Nickel
  - 19825 BE0 Sterling inf
  - 19825 000 chrome

