

GROHTHERM 2000 AUTHENTIC

Dual function thermostatic trim with control module

MODEL # 19825

GROHE America, Inc | 200 North Gary Avenue, Suite G, Roselle, IL 60172
 Phone: +1 (800) 444-7643 | Fax: +1 (800) 225-2778 | us-customerservice@grohe.com

Pure Freude an Wasser

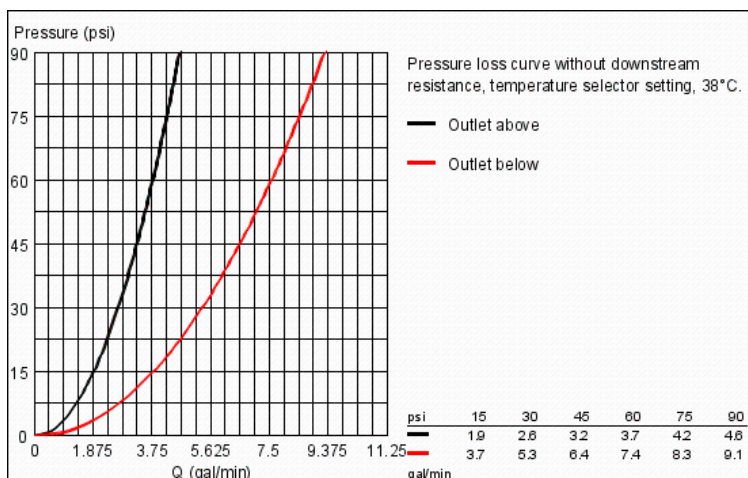
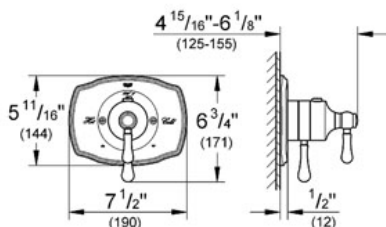

ADA

Product Description:

Dual function thermostatic trim with control module

Standard Specification:

- GROHE TurboStat® technology
- For shower/tubs with non-diverter tub spout or for 2 shower outlet applications
- Integrated volume control
- 2-way diverter function
- 1 axis operation
- For use with GrohFlex™ universal rough-in box 35 026 000 sold separately
- Max Flow Rate 6.6 at 45 psi (25 l/m)
- Code Compliance:
 - ASME/ANSI A112.18.1M
 - CSA Standard B125.1-05

Applicable Codes & Standards:

- Energy Policy Act of 1992
- ASME A112.18.1/CSA B125.1
- ICC/ANSI A117.1

Color:

- 19825 ZB0 Oil Rubbed Bronze
- 19825 EN0 Brushed Nickel
- 19825 BE0 Sterling inf
- 19825 000 chrome