

GROHFLEX 2000

Single function thermostatic trim with control module

MODEL # 19822

GROHE America, Inc | 200 North Gary Avenue, Suite G, Roselle, IL 60172
 Phone: +1 (800) 444-7643 | Fax: +1 (800) 225-2778 | us-customerservice@grohe.com

Pure Freude an Wasser

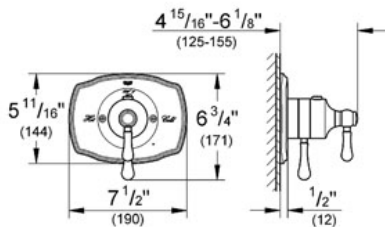

Product Description:
 Single function thermostatic trim with control module

- Standard Specification:**
- GROHE TurboStat® technology
 - For shower only or shower/tub with diverter applications
 - Integrated volume control
 - Integrated bypass option when used with diverter tub spout
 - 1 axis operation
 - For use with GrohFlex™ universal rough-in box 35 026 000 sold separately
 - Max Flow Rate:
 - Max Flow Rate 6.6 at 45 psi (25 l/m)
 - Code Compliance:
 - ASME/ANSI A112.18.1M
 - CSA Standard B125.1-05

- Applicable Codes & Standards:**
- Energy Policy Act of 1992
 - ASME A112.18.1/CSA B125.1
 - ICC/ANSI A117.1

- Color:**
- 19822 BE0 Sterling inf
 - 19822 EN0 Brushed Nickel
 - 19822 ZB0 Oil Rubbed Bronze
 - 19822 000 chrome

