

ATRIO 5-Port Diverter Trim

MODEL # 19181

Pure Freude an Wasser

GROHE

GROHE America, Inc | 200 North Gary Avenue, Suite G, Roselle, IL 60172
Phone: +1 (800) 444-7643 | Fax: +1 (800) 225-2778 | us-customerservice@grohe.com

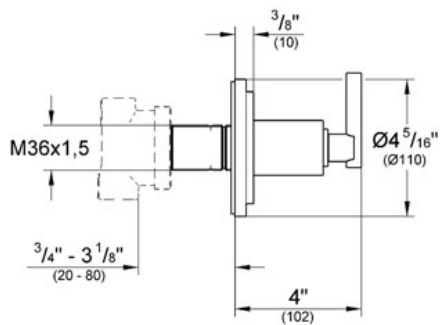

ADA

Product Description: 5-Port Diverter Trim

Standard Specification:

- GROHE StarLight® finish
- With Jota handle
- Set for final installation (for 29 714)
- Without concealed body
- Escutcheon with wall sealing
- Adjustable installation depth
- 3/4" - 3 1/8"

Applicable Codes & Standards:

- Energy Policy Act of 1992
- ASME A112.18.1/CSA B125.1
- ICC/ANSI A117.1

Color:

- 19181 000 chrome
- 19181 EN0 Brushed Nickel