



# TOTO

## Washlet E200 Installation Instructions

Before installing your Washlet, be sure to read the following installation instructions and install the product only as described in this manual.

### Safety Precautions

Follow all safety precautions and warnings when installing the Washlet.

 The  symbol indicates a prohibited use of the product.

 This symbol means "Always follow this precaution".

### DANGER

 Do not install the Washlet in a wet or damp place, such as a shower stall or bathtub area. Doing so may cause fire or electrical shock.

 This product should be used with grounded 120V, 60Hz electrical current only to avoid possible fire or shock.

 Make sure that a ground wire has been installed. Failure to install a ground wire could result in electrical shock in the event of a malfunction or short circuit.

 Only use tap water or drinkable well water (ground water). Use of water that is not safe for drinking may cause irritation or injury to the skin.

 Do not use a loose or faulty electrical outlet or plug. Doing so may cause fire or electrical shock.

 Be sure to plug the electrical cord all the way into the wall socket to avoid possible fire or electrical shock.

### WARNING

 Do not remove the drain valve and water filter with the water shutoff valve in the OPEN position.

 After cleaning the water filter, be sure to insert it into the drain valve and securely tighten the drain valve to avoid water leakage.

 Do not bend or crush the connection hose. Bending or crushing the connection hose may result in water leakage.

 Do not raise the toilet seat or seat cover while objects are resting on top of the toilet, as this could cause the main unit to become detached, resulting in injury.

 Do not install base plate to Washlet when not attached to the toilet. Fire or damage may result.

### Before Installing the Washlet

- Do not transmit electrical current or supply water to the unit until the installation process is complete.
- The power voltage is 120V/60Hz. The rated energy consumption is 410 W. Use wiring and electrical outlet appropriate for this level of power.
- The power cord is 3 feet (1m) in length. The electrical outlet should be installed on the wall to allow easy installation and removal of the Washlet.
- Use a water supply of 20 - 80 PSI (0.14Mpa ~ 0.55Mpa).
- The water temperature range should be 0 ~ 35°C (32~95°F).
- The length of the connection hose is 1.5 feet (500mm). The water supply should be installed to allow easy installation and removal of the Washlet.

### Parts and Features

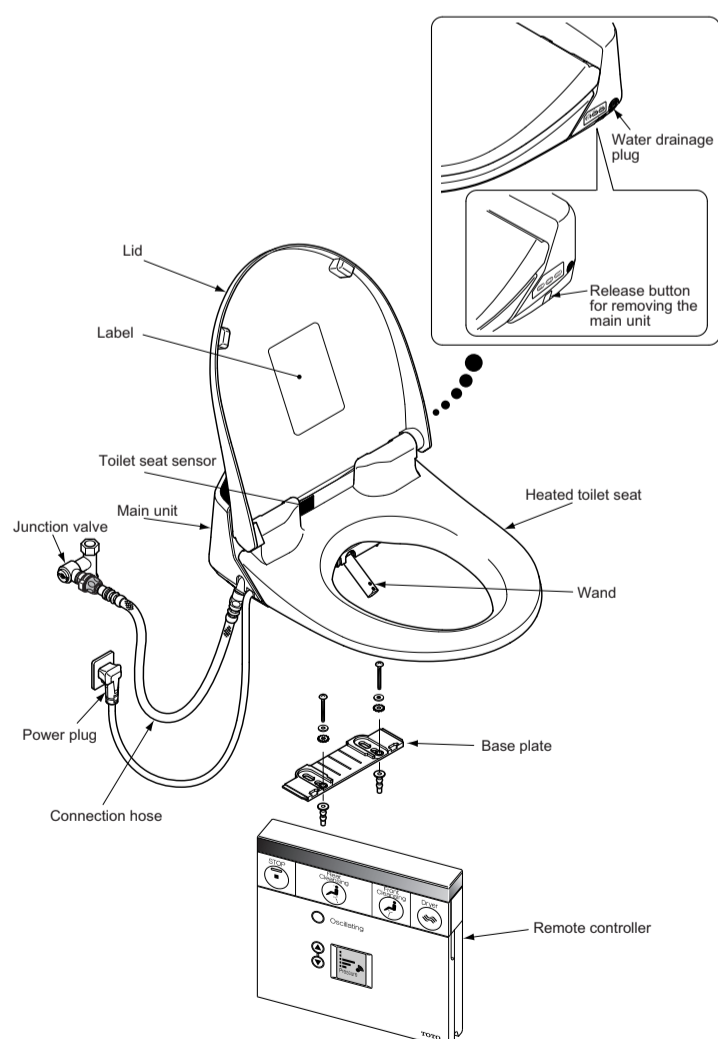

### Parts Identification

#### 1 Washlet Main Unit

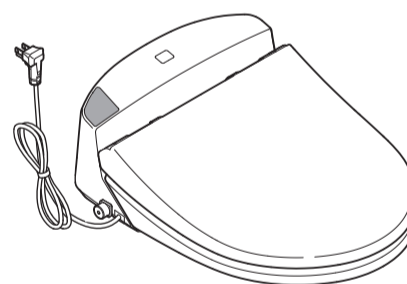

#### 2 Remote Controller Parts

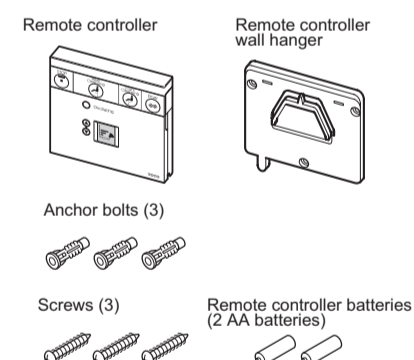

#### 3 Base Plate Parts

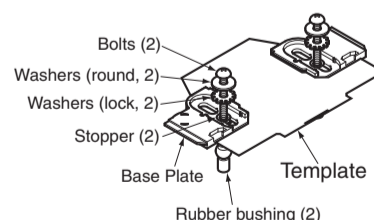

#### 4 Connection Hose (with packing washer)

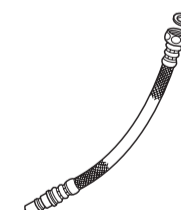

#### 5 Junction valve

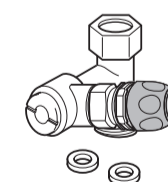

#### 6 Instruction Manual Warranty Card Installation Instructions

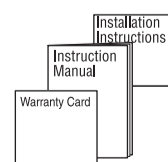

Use second set of mounting holes for decoratively curved toilets.

#### 7 Washers (2)



#### 8 Optional Elbow Joint



# Installing the Washlet

## 1 Connecting the Junction valve

The instructions and illustrations for this section are for common toilets found in most homes. Your toilet may vary in appearance. If you cannot find a described fixture or connection on your toilet, you may have a custom toilet installation that requires professional installation for the Washlet.

### Tools you will need:

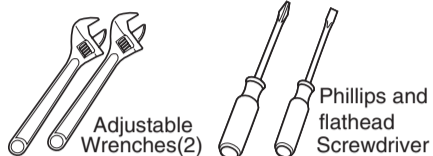

### Caution

- If you are not familiar with plumbing and installing plumbing fixtures, you may need to hire a contractor to do this installation.
- Improper tightening of a connection, either under-tightening or over-tightening can result in water leakage.

- 1 Close the water supply shut-off valve near the wall. Flush the toilet to empty the water tank, and place a container under the tank's water inlet. If water flows into the toilet or water tank, check the water supply shut-off valve to make sure it is completely closed. Failure to completely close this valve may result in flooding when the flexible tubing is disconnected in the next step.

Turn the water supply shut-off valve clockwise

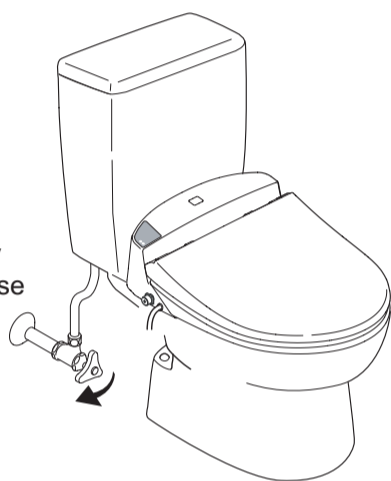

- 2 Remove the flexible tubing (or metal / copper tubing) from the tank's water inlet using an adjustable wrench. Drain the water from the flexible tubing into a container.

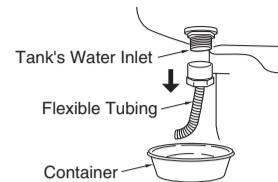

### Notes

- If your tank is connected to the water supply shut-off valve with metal or copper tubing, you must replace it with flexible tubing.
- Check the condition of the flexible tubing. If it is cracked, worn or damaged, replace it before continuing this procedure.

- 3 Place the packing washer inside the nut on the junction valve, and install the junction valve onto the tank's water inlet using an adjustable wrench. Make sure the washer is seated properly on the junction valve.

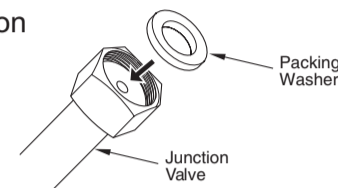

- 4 Install the flexible tubing onto the junction valve. You may need to replace the packing washer on the flexible tubing if it is worn or damaged.

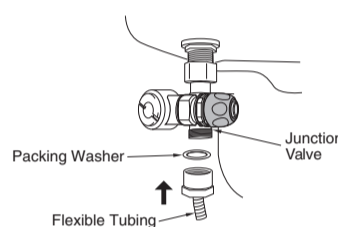

### Caution

- Do not overtighten the nuts. Overtightening can damage the connection and cause leaks. Use moderate pressure to tighten the nuts.
- When tightening the junction valve, make sure that the hose does not become bent. If the hose should become bent, the water supply may not be able to reach the Washlet.

### Notes

If you have removed the metal or copper supply tubing in step 2, you must replace it with flexible tubing.

## 2 Attaching the Washlet to the Toilet Bowl

Installation on a curved toilet is slightly different. Please refer to page 3. Attaching to an ordinary toilet bowl.

### 1 Install Base Plate

Installation Template is attached to the Base Plate. Do not remove.

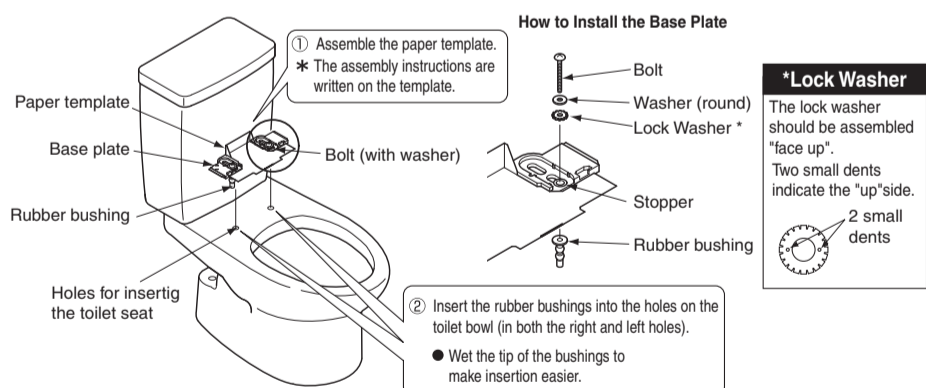

### 2 Confirm the size of the toilet bowl.

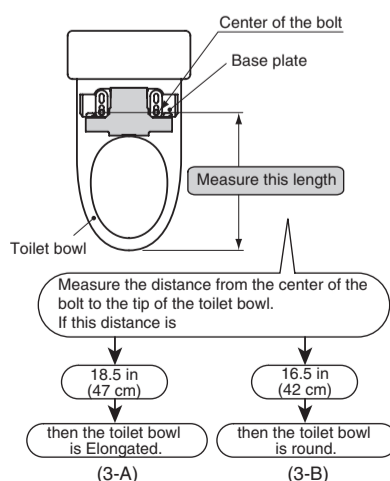

### 3 Determine the correct position for the base plate.

- 3A For an elongated toilet bowl: match up the center of the bolt with the position marked "elongated" on the paper template. [bolt-elongated-match up].

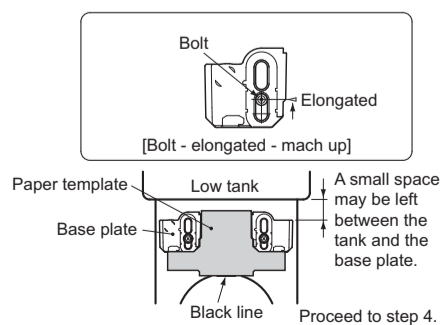

### 3B For a Round toilet bowl:

- ① Match up the center of the bolt with the position marked "round" on the paper template.

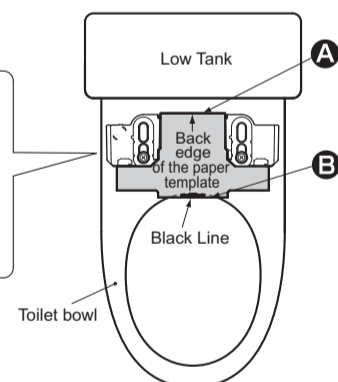
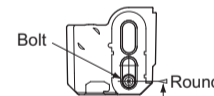

### 2 Confirm the conditions for A and B.

- A: There should be a small space between the low tank and the back edge of the paper template.
  - There is a space (it should be 2mm or more)
  - × There is no space
- B: The black line on the paper template should be lined up with or slightly in front of the edge of the toilet bowl.

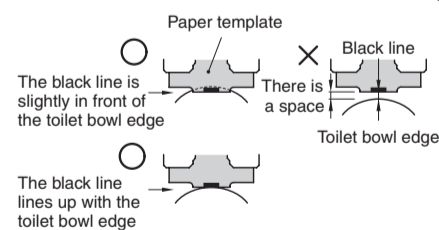

- ③ If A and B are both ○: proceed to step 4. If either A or B is ×, adjust the position of the base plate, as shown in the diagram to the right, so that both A and B are ○. After adjusting the position of the base plate, proceed to step 4.

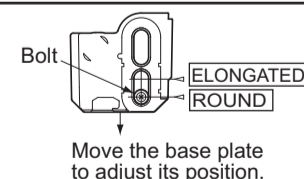

### 4 Temporarily tighten

Insert Rubber Bushing into seat mounting hole in toilet bowl. Tighten bolt to secure plate to bowl.

Tip: Wetting the Rubber Bushing will make installation into the toilet easier.

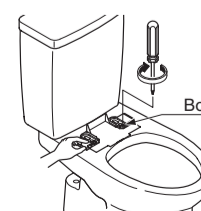

**5** Remove Template. Align Washlet in front of Base Plate. Slide Washlet onto Base Plate until there is a click.

Pull the paper template out slowly.

Click

Base plate

**6** Once it is confirmed that the Washlet is correctly installed, remove the Washlet.

- To remove the Washlet, push the side release button and slide Washlet forward.

Release button

**7** Fully tighten bolt

- Tighten bolt until Base Plate is flush against the Toilet.
- Slide Washlet onto Base Plate until there is a click.

Tighten bolt until Base Plate is flush against the Toilet.  
\* When the Washlet is attached to the toilet by the Base Plate, the Washlet will still move slightly.  
(The slight movement is due to the attachment rails on the baseplate that allow for easy attachment and removal. This is not a design flaw.)

Base plate Bolt Gasket Bowl Bowl

**In case of a decoratively curved toilet**

In case of a curved toilet (picture at right), installation is different.

[In cases where area "B" has large curves.]

Top View or From top Side View

as in the picture below, change the inserts in Base Plate to the rear holes.

Back Back

Stopper Remove Stopper Insert

[Back of Base plate]

1. Remove lock washer and insert the Metal Plate. Use front hole of Metal Plate when installing the Base Plate.

Position mounting bolt.

Bolt Washer (round) Washer (oblong) Lock washer Template Base Plate Stopper Rubber bushing

2. As indicated in instruction 5, remove template and install Washlet to bowl. Check the following things:

- Check if the back of the Washlet hits the toilet tank.
- Check if Washlet Wand hits toilet bowl.
- Check if Washlet is installed straight.

Click

Base plate

If there are no problems:

If problems are found:

Go to steps 6 & 7 at left to finish installation.

Go to step 3.

- Remove Washlet and Base Plate.
- Change bolt installation position to back hole.

Position mounting bolt.

Bolt Washer (round) Washer (oblong) Stopper Rubber bushing Base plate

- Redo steps 4 ~ 7 (For more detail, Step 4 is on the previous page, 5 ~ 7 are at left)

\* In case of pre-installed thread in mounting hole.

Installation is the same as with the decoratively curved toilet, but use the mounting bolts that were provided with the toilet. (The Washlet bolts are not used).

**3** Installing the Connection Hose

**1** Screw the hex lock nut for the connection hose into the water inlet on the Washlet main unit.

**Caution:** Be sure to use a monkey wrench to fasten the water supply inlet onto the Washlet and then connect the connection hose. (Do not apply force to the water inlet as this may break it and result in water leakage.)

**POINT!** The water inlet on the main unit should only be rotated at a vertical, downward or sideways position. For toilet bowls in which the bowl and the inlet are all one unit, rotate the inlet so that it is in a sideways position.

sideways position Vertical downward position.

**Advice**

In the case of a one piece toilet (such as the one shown at right), use of the included elbow is recommended for better hose orientation.

- Connect Elbow to water inlet on Washlet
- Connect flexible hose to Elbow.

Fixation Clockwise

Fixation Clockwise

**2** Insert the plug end of the connection hose into the water supply coupler on the junction valve.

**Caution** Before inserting the connection hose, check that the ring of the coupler is mounted at the position as shown in the diagram.

**POINT!** Insert the hose into the coupler until it clicks into place.

Junction valve Water supply coupler Plug

Click

Washlet main unit

Junction valve Water supply coupler Plug Connection hose Water inlet Hex lock nut (with gasket attached)

**3** Confirm that the length of the connection hose is long enough to allow for the Washlet to be removed and reattached while the hose is connected.

\* The water shutoff valve should be always be closed before removing detaching the connection hose.

**Removing the Connection Hose**

Follow the steps below when removing the connection hose for re-installation, etc.

- Close the water shutoff valve.
- Drain out the water in the tank.
- With your fingers, press the ring of the water supply coupler to loosen and shift it.
- Line up the indented and raised portions on the water supply coupler, push in an upward direction.
- While pushing the water supply coupler in an upward direction, pull out the connection hose.

Press the ring to loosen Shift the ring

ring Indented portion

Raised portion Water supply coupler portion

push in pull out Connection hose

Water supply coupler

## 4 Installing the Remote Controller

- 1 Open the battery compartment cover and insert the alkaline batteries.

\* Be sure to install the batteries in the correct +/- positions.

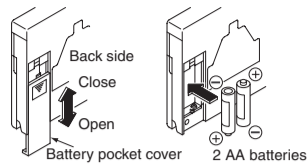

- 2 Select the desired position for hanging the remote controller.

### Caution

Before attaching the remote controller to the wall, make certain that the toilet functions, such as the rear wash, work properly from the selected mounting position.

- ▨ Suitable mounting position for the remote controller
- ▣ Easy-to-use mounting position for the remote controller.

### Caution

Sit on Washlet E200 to activate seat sensor and press "Wand Cleaning" button. If the remote does not activate the Washlet functions, please move within the mounting area or try the opposite wall.

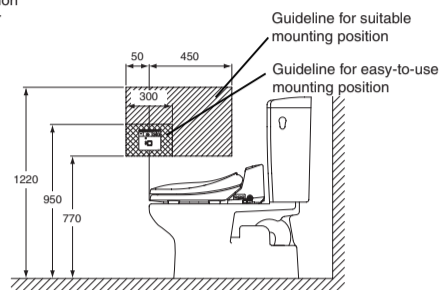

- 3 Attach the remote controller hanger to the wall using the screws provided.

- Pre-drill a 1/8" (3mm) guide hole for easier installation.
- When mounting on sheetrock or plasterboard, pre-drill a 1/4" (6mm) guide hole, 1-1/4" (33 mm) deep and use the plastic anchor bolts.

Drill a 1 5/16" (33mm) deep hole (0.25"D (6mm)) into the wall and use wall anchor.

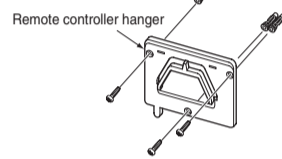

- 4 Insert the remote controller into the wall hanger.

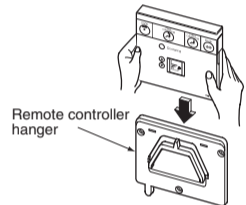

- 3 Check to make sure that the warm air dryer works properly.

- Does warm air blow out from the right of the wand when the dryer button is pushed?
- Does the dryer turn off when the STOP button is pushed?

- 4 Check to make sure the toilet seat heater works properly.

The toilet seat should get warm in 15 minutes.

- 5 Remove the white paper from the toilet seat sensor.

## Cleaning the Water Supply Filter

- A clogged water supply filter will affect the performance of the product. Be sure to clean the filter after performing Trial Operation using the procedure described below. There are two water filter that you need to clean, one is located at the main unit and the other is in the Junction valve unit.

- 1 Close the water supply shut-off valve and junction valve.

- Shut off the water valve with a flat head screwdriver.
- Drain out the water in the toilet tank to depressurize the water pipes.

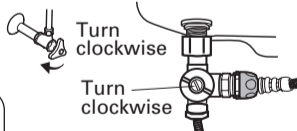

### Caution

Do not remove the water filter while the shutoff valve is open to prevent water from spewing out.

- 2 To access the water filter, pressure in both the water line and main unit must be reduced first. In order to do this, you must follow these steps.

- Flush the toilet.
- Press the "Wand Cleaning" button once on the remote control.
- Press the "Wand Cleaning" button again to retract the wand.

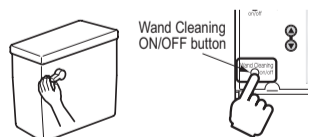

- 3 Remove the main unit.

- Press down on the main unit detach button to the right and slide the main unit forward to remove.

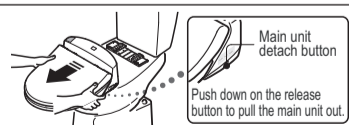

- 4 Remove the water filter and drain valve.

- Loosen the water filter and drain valve with a flat head screwdriver and pull it out.

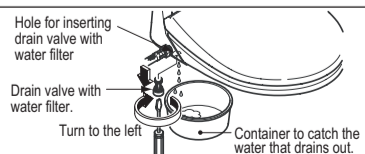

### To the Serviceman:

Provide the customer with an explanation of the Washlet functions and operating instructions. When performing installation in a new home that is unoccupied, be sure to disconnect the power plug from the wall outlet.

## Trial Operation

- Once the installation procedures are complete, perform a trial operation following these steps:

- 1 Inspect for water leakage

- Make sure that the fittings are secured tightly before supplying water to the unit.
  - Open the Water shutoff valve.
  - Open the junction valve and check to see that there is no water leakage from the fittings.
  - Check to see that there is no water leakage from the water supply fittings on the Washlet main unit.
- \* If water leakage occurs, reinstall the fittings until the leakage stops.

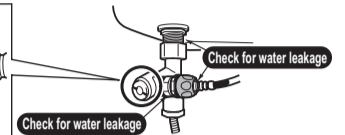
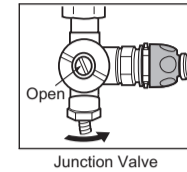
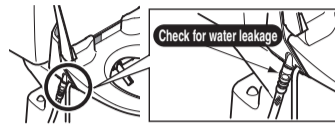
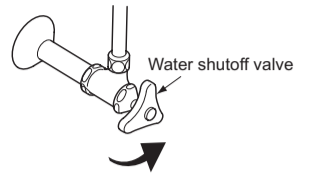

- 2 Check to make sure the power plug is securely plugged into the wall outlet

- Make sure that the power plug is plugged into a wall outlet with a 120V (60Hz) grounded electric current.
- Confirm that the wand extends and then returns to the stored position.

- 3 Checking the Functions

- 1 Cover the seat sensor with white paper.

To check functions, cover sensor with white paper.



- 2 Check to make sure that the wash functions work properly. (Cover the toilet seat sensor with white paper again.)

- It will take about 10 minutes to heat the water in the tank.
  - Does warm water spray from the wand when the front cleansing and rear cleansing buttons are pushed?
  - Does the water pressure change when the strong or soft water pressure button is pushed?
  - Confirm that there is no water leakage from the main unit
  - Does the water stop spraying when the STOP button is pushed?
- \* Catch water spray in a cup.

- 5 Clean the water filter.

- Remove the filter and clean the mesh by running it under water.
- \* Use a small brush, such as a toothbrush to remove any dirt that is lodged in the mesh.
- \* Remove any dirt that may have deposited inside the hole for inserting the drain valve with a cotton swab.

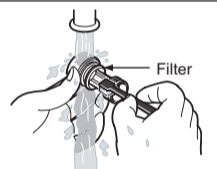

- 6 Reinstall the water filter and drain valve.

- Insert the water filter and drain valve and tighten securely with the screwdriver.

### Caution

Be sure to tighten the drain valve securely into the hole to avoid possible water leakage.

- 7 Reattach the main unit.

- ① Line up the center of the main unit with the center of the base plate.
  - ② Slide the main unit along the top of the toilet bowl rim until it clicks into place.
- \* The Washlet will not operate if the main unit is not inserted correctly into the base plate.

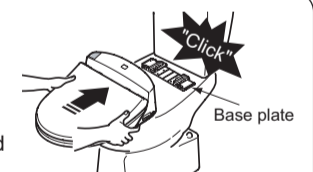

- 8 To access the "junction valve" filter, the junction valve cover must be removed. Use a large flathead screwdriver or coin and turn the valve cover counter-clockwise.

- Place a container underneath the junction valve. After removing the junction valve cover, gently pull the filter out. Do not remove the water filter while the shutoff valve is open to prevent water from spewing out.

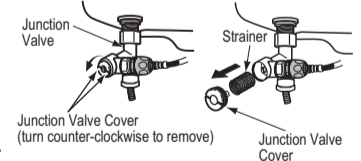

- 9 Clean the strainer.

- Remove sediment from the filter using a toothbrush.



- 10 Insert the junction valve cover with strainer.

- Push the junction valve cover with strainer into the junction valve and turn it clockwise. Be sure to tighten it securely.

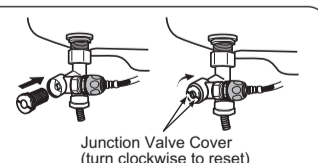

- 11 Open the water shutoff valve and junction valve.

- 12 Make sure that there is no water leakage from the drain valve.