

NOTE(S):

1. PART NUMBER, "/00" DENOTES PART SHALL HAVE FINISH.
2. APPLY NSF COMPLIANT GREASE TO ANY O-RING, SEALING JOINTS, AND/OR PIVOTAL POINTS.
3. APPLY NSF COMPLIANT LOCTITE TO THREADED AREA.
4. ~~APPLY NSF COMPLIANT REMOVABLE (BLUE) LOCTITE TO THREADED AREA.~~
5. SILVER SOLDER JOINTS SHALL BE FULLY WETTED VIA CAPILLARY ACTION AND COMPLETELY NON-POROUS.

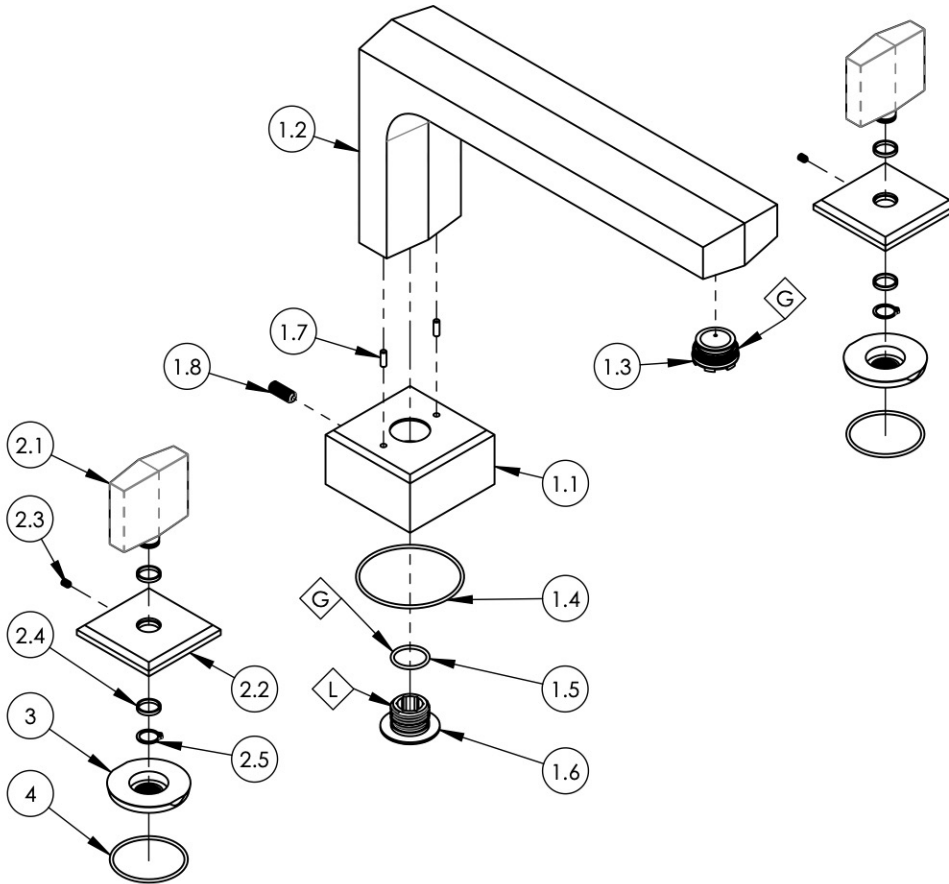

ITEM NO.	PART NUMBER	DESCRIPTION	QTY.
1	3-592/00	ASSY, SPOUT, DECK TUB, DIAMA	1
1.1	11767/00	ESCUTCHEON, SPOUT, DECK TUB, DIAMA	1
1.2	11774/00	SPOUT, DECK TUB, DIAMA	1
1.3	P05051	AERATOR, CACHE COINED SLOT M24X1.0 FULL FLOW	1
1.4	90034	O-RING, 2-1/8"ID X 2-1/4"OD X 1/16"THK, AS-568-034	1
1.5	90017	O-RING, 11/16"ID X 13/16"OD X 1/16"THK, AS-568-017	1
1.6	11220	SPUD SCREW, 1/2"-NPSM CONNECTOR	1
1.7	92158	DOWEL PIN, 1/8" X 3/8"L	2
1.8	92262	SET SCREW, CUP PT 1/4"-20 X 5/8"L	1
2	3-595/00	ASSY, BLADE HANDLE, DIAMA	2
2.1	11762/00	BLADE HANDLE, DIAMA	1
2.2	11764/00	ESCUTCHEON, HANDLE, DIAMA	1
2.3	92005	SET SCREW, CUP PT 6-32 UNC THREAD 3/16"L	1
2.4	92176	WEAR WASHER	2
2.5	92177	RETAINING RING, 7/16" SHAFT	1
3	11003	SLEEVE MOUNT, WALL MT WIDESPREAD	2
4	90029	O-RING, 1-5/8"ID X 1-3/4"OD X 1/16"THK, AS-568-029	2



ALL	A	UPDATE TEMPLATE, ADD CALL OUTS	6/12/2020	AMM
ZONE	REV.	DESCRIPTION	DATE	APPROVED
REVISIONS				

1261 LOGAN AVENUE
COSTA MESA, CALIFORNIA 92626
PHONE: 714.361.4800
FAX: 714.617.3120

PHYLIRICH®
Defining Luxury Since 1959

PROPRIETARY AND CONFIDENTIAL
THE INFORMATION CONTAINED IN THIS DRAWING IS THE SOLE PROPERTY OF PHYLIRICH. ANY REPRODUCTION IN PART OR AS A WHOLE WITHOUT THE WRITTEN PERMISSION OF PHYLIRICH IS PROHIBITED.
DO NOT SCALE DRAWING

DECK TUB, BLADE HANDLES, DIAMA

SIZE A	ASM/PRT NO. 184-40/00	REV A
SCALE: 1:4	WEIGHT: lbs.	SHEET 1 OF 2