

- NOTE(S):
 1. PART NUMBER, "/00" DENOTES PART SHALL HAVE FINISH.
 2. APPLY NSF COMPLIANT GREASE TO ANY O-RING, SEALING JOINTS, AND/OR PIVOTAL POINTS.
 3. APPLY NSF COMPLIANT LOCTITE TO THREADED AREA.
 4. APPLY NSF COMPLIANT REMOVABLE (BLUE) LOCTITE TO THREADED AREA.
 5. SILVER SOLDER JOINTS SHALL BE FULLY WETTED VIA CAPILLARY ACTION AND COMPLETELY NON-POROUS.
 6. APPLY TWO STAGE EPOXY TO JOINT AREA.

- ◇ G
- ◇ L
- ◇ B
- ◇ S
- ◇ E

| ITEM NO. | PART NUMBER | DESCRIPTION | QTY. |
|----------|-------------|---|------|
| 1 | 2-098 | MOUNTING KIT FOR MIX/EDGE SERIES | 1 |
| 1.1 | 30042 | WALL MOUNTING PLATE | 1 |
| 1.2 | 92043 | SCREW, FLAT HD #10 SIZE W/ #2 PHIL DRIVE, 2"L | 2 |
| 1.3 | 92046 | ANCHOR SCREW 3/8" HOLE, TOGGLER AF10 | 2 |
| 2 | 10639/00 | ESCUTCHEON, WALL MOUNT CONTEMP. | 1 |
| 3 | 30492/00 | TISSUE PAPER HOLDER | 1 |
| 4 | 30527/00 | END CAP, TISSUE PAPER HOLDER, TRANSITION | 1 |
| 5 | 92008 | SET SCREW, CUP POINT 8-32, 3/16" L. | 1 |
| 6 | 92437 | BUTTON HEAD HEX DRIVE SCREW, M6 X 1.0, 12MM L | 1 |

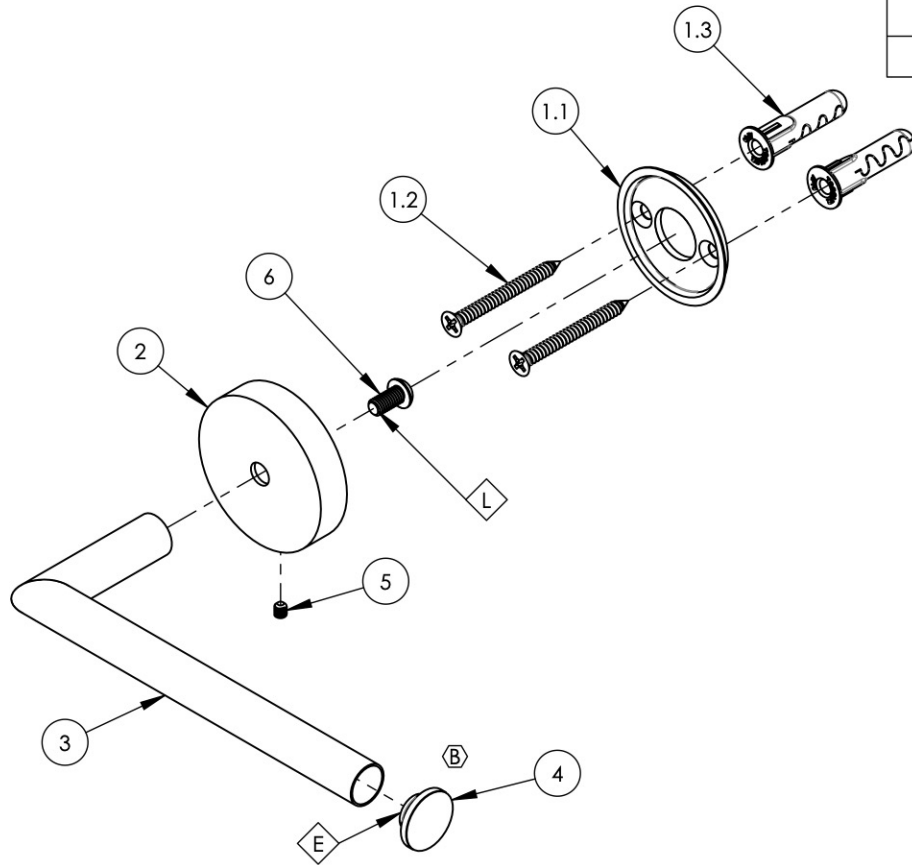

| ZONE | REV. | DESCRIPTION | DATE | APPROVED |
|-----------|------|------------------------|-----------|----------|
| B4 | B | ADDED PART# TO END CAP | 9/30/2020 | RAH |
| REVISIONS | | | | |

1261 LOGAN AVENUE
 COSTA MESA, CALIFORNIA 92626
 PHONE: 714.361.4800
 FAX: 714.617.3120

PHYLIRICH[®]
 Defining Luxury Since 1959

PROPRIETARY AND CONFIDENTIAL
 THE INFORMATION CONTAINED IN THIS DRAWING IS THE SOLE PROPERTY OF PHYLIRICH. ANY REPRODUCTION IN PART OR AS A WHOLE WITHOUT THE WRITTEN PERMISSION OF PHYLIRICH IS PROHIBITED.
DO NOT SCALE DRAWING

PAPER HOLDER (SINGLE POST),
 TRANSITION

| SIZE | ASM/PRT NO. | REV |
|--------------|--------------|--------------|
| A | 120-74/00 | B |
| SCALE: 1:2.5 | WEIGHT: lbs. | SHEET 1 OF 2 |