

# artos<sup>®</sup>

## F9 73NSV0

## INSTALLATION GUIDE

thermostatic valve with 3-way  
non-shared diverter

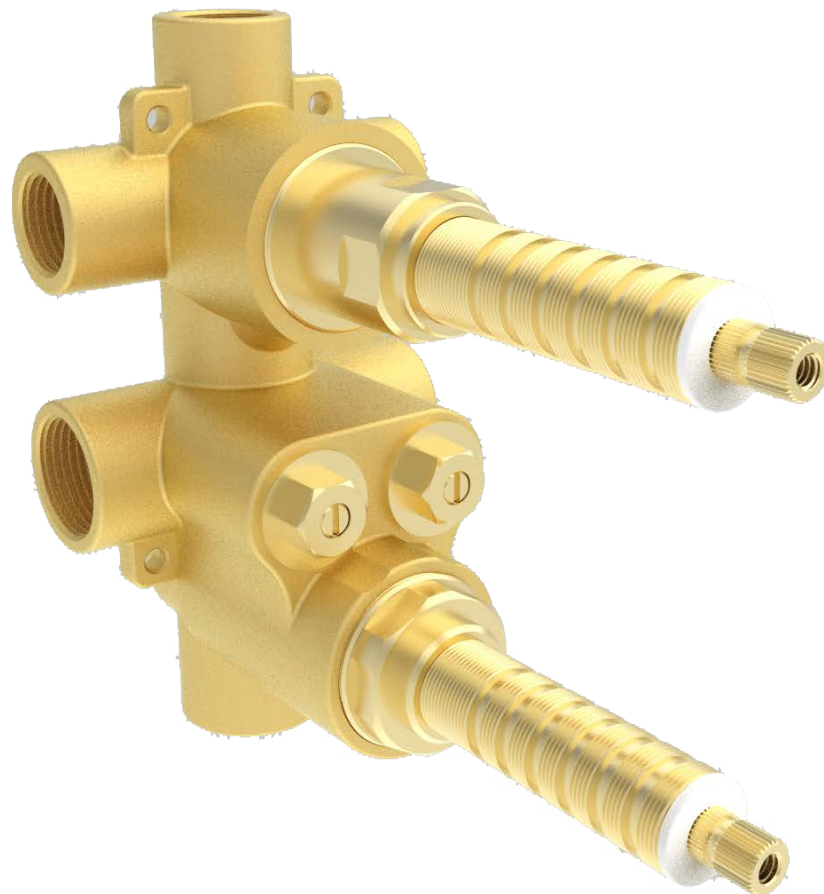

# artos<sup>®</sup>

## F973NSV0

## OPERATING SPECIFICATIONS

thermostatic valve with 3-way  
non-shared diverter

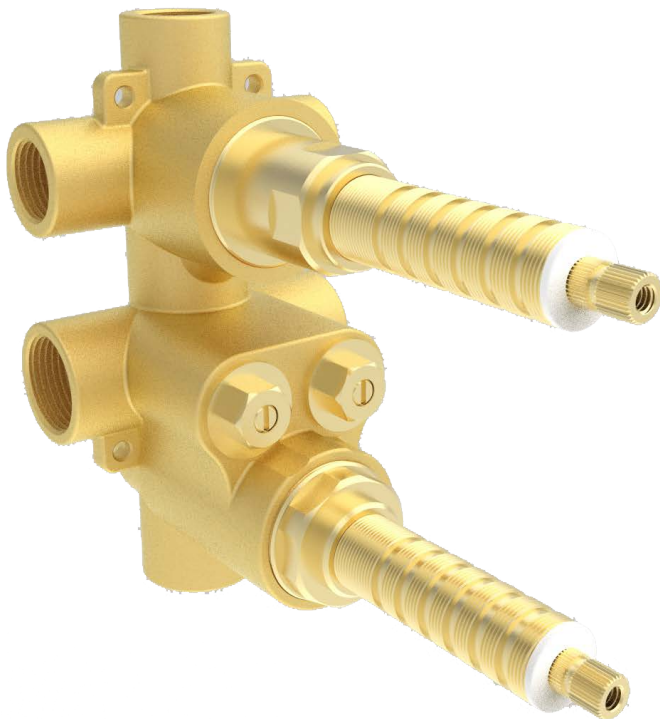

### MIXED WATER TEMPERATURE

Maximum: 120°F

### HOT WATER SUPPLY TEMPERATURE

Maximum: 180°F

Minimum: 50°F

Advisable: 150°F- 160°F

Minimum difference between hot mixed temperature 50°F

### OPERATING PRESSURE

Maximum: 125psi

Minimum: 20psi

Recommended: 30psi- 95psi

Operating pressures (on hot and cold lines) should be kept as balanced as possible, in order to assure the maximum efficiency.

### STANDARDS

ASSE 1016.ASME A112.18.1/CSA B123.1

### APPROVALS



# artos<sup>®</sup>

## F973NSV0

## TECHNICAL SPECIFICATIONS

thermostatic valve with 3-way  
non-shared diverter

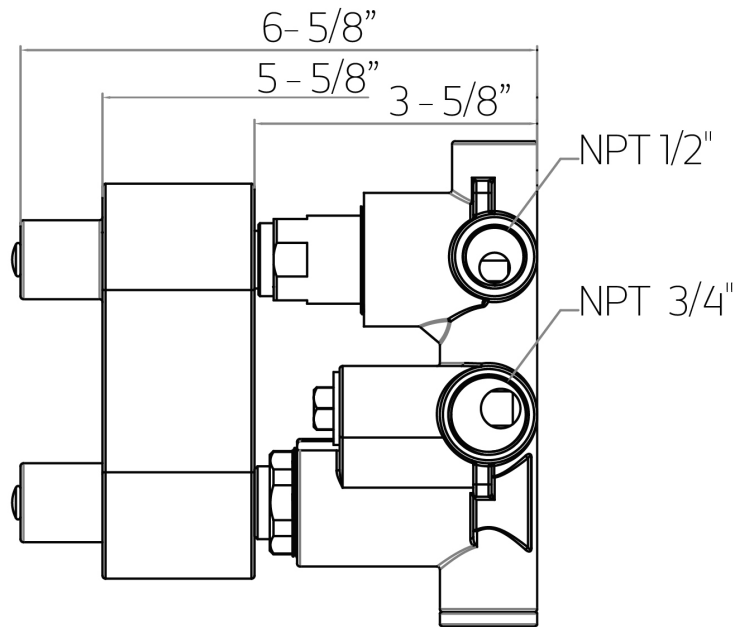
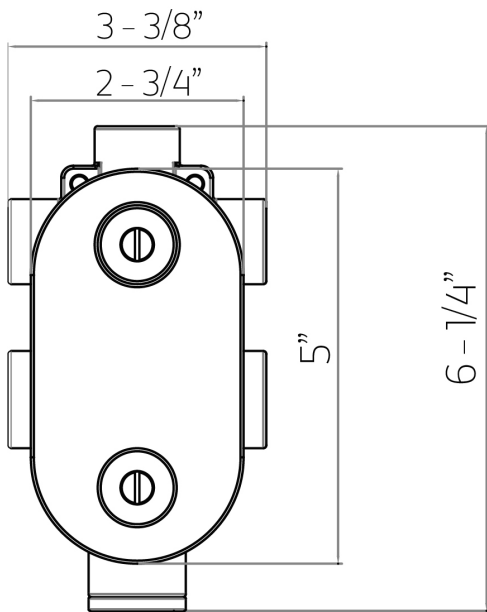

thermostatic valve with 3-way  
non-shared diverter

### STEP 1

**IMPORTANT: IF USING HEAT NEAR THE VALVE BODY PLEASE REMOVE CARTRIDGES.**

### TWO OUTLETS

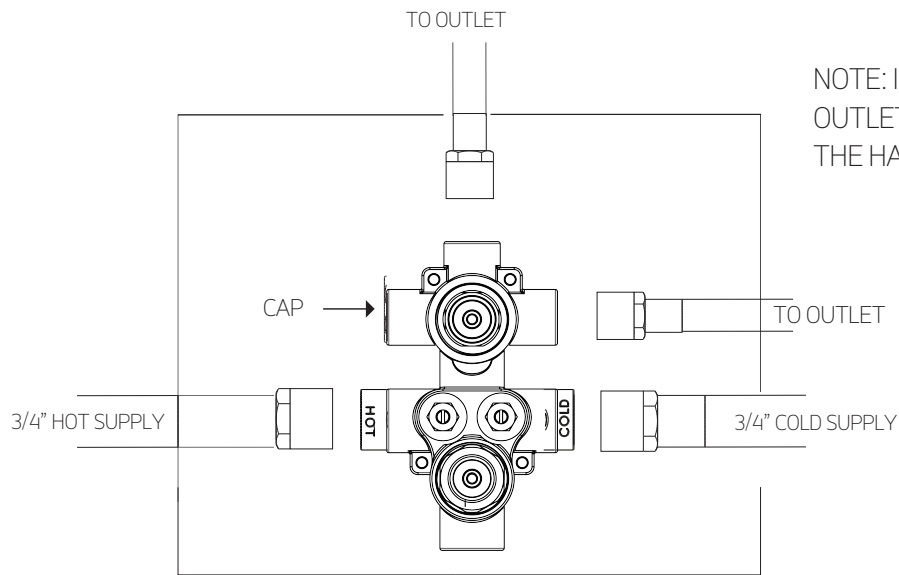

### THREE OUTLETS

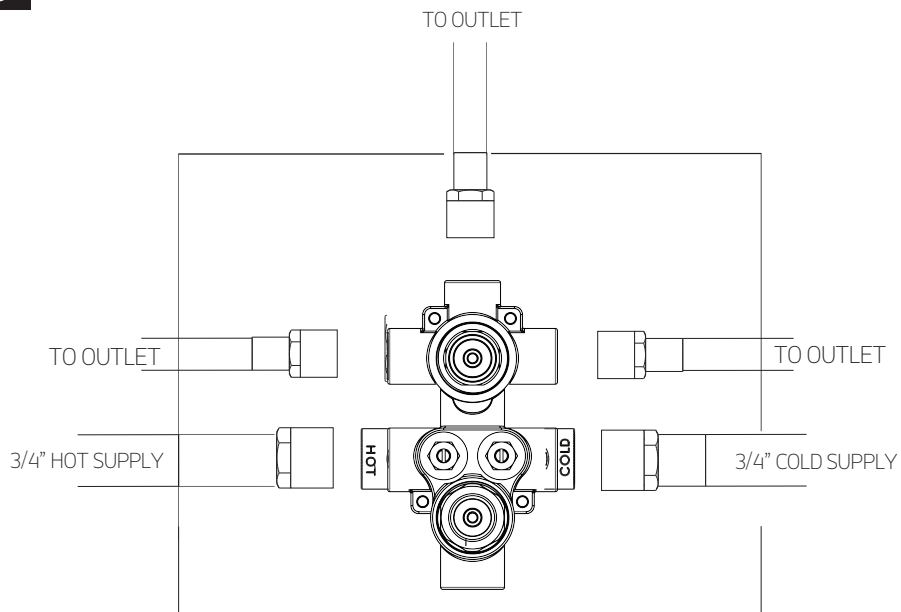

# artos<sup>®</sup>

F973NSV0

## INSTALLATION STEPS

thermostatic valve with 3-way  
non-shared diverter

### STEP 2

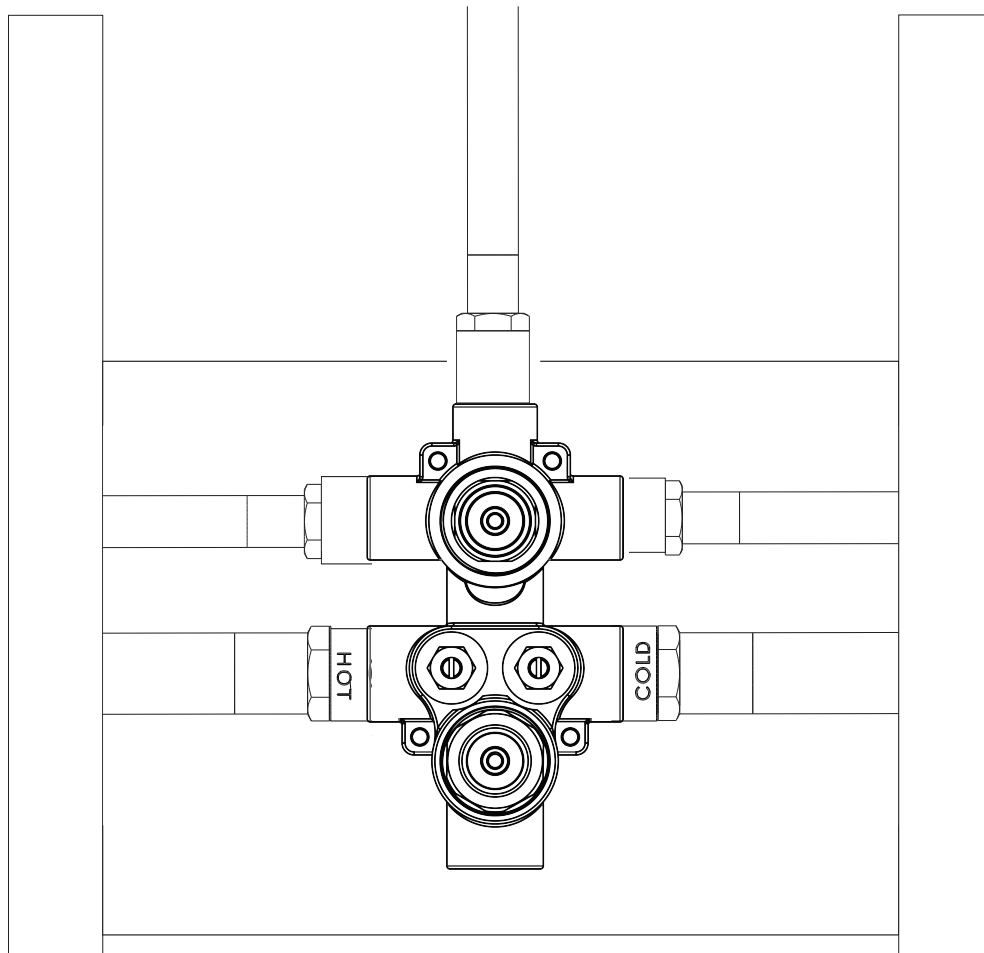

**2"X 4" WALLS**

USE 3/4" PLYWOOD BACKER

**2"X 6" WALLS**

USE 2"X 6" BACKER

F973NSV0

## INSTALLATION STEPS

thermostatic valve with 3-way  
non-shared diverter

### WALL WITH 2X4" STUDS

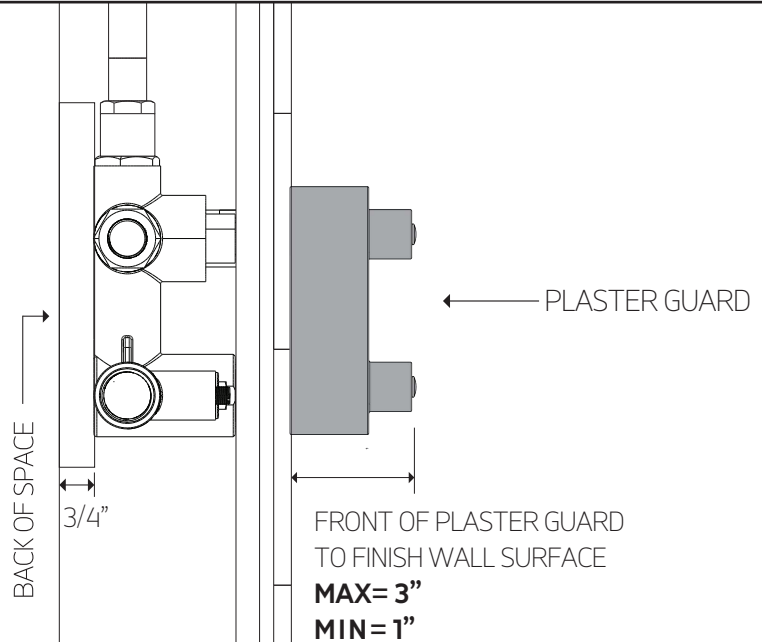

### WALL WITH 2X6" STUDS

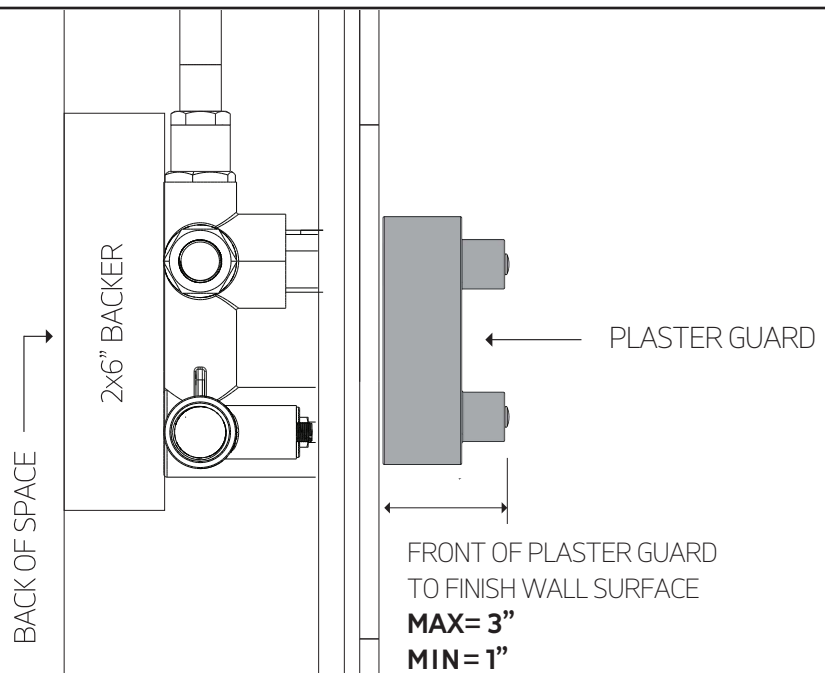

thermostatic valve with 3-way  
non-shared diverter

### STEP 3

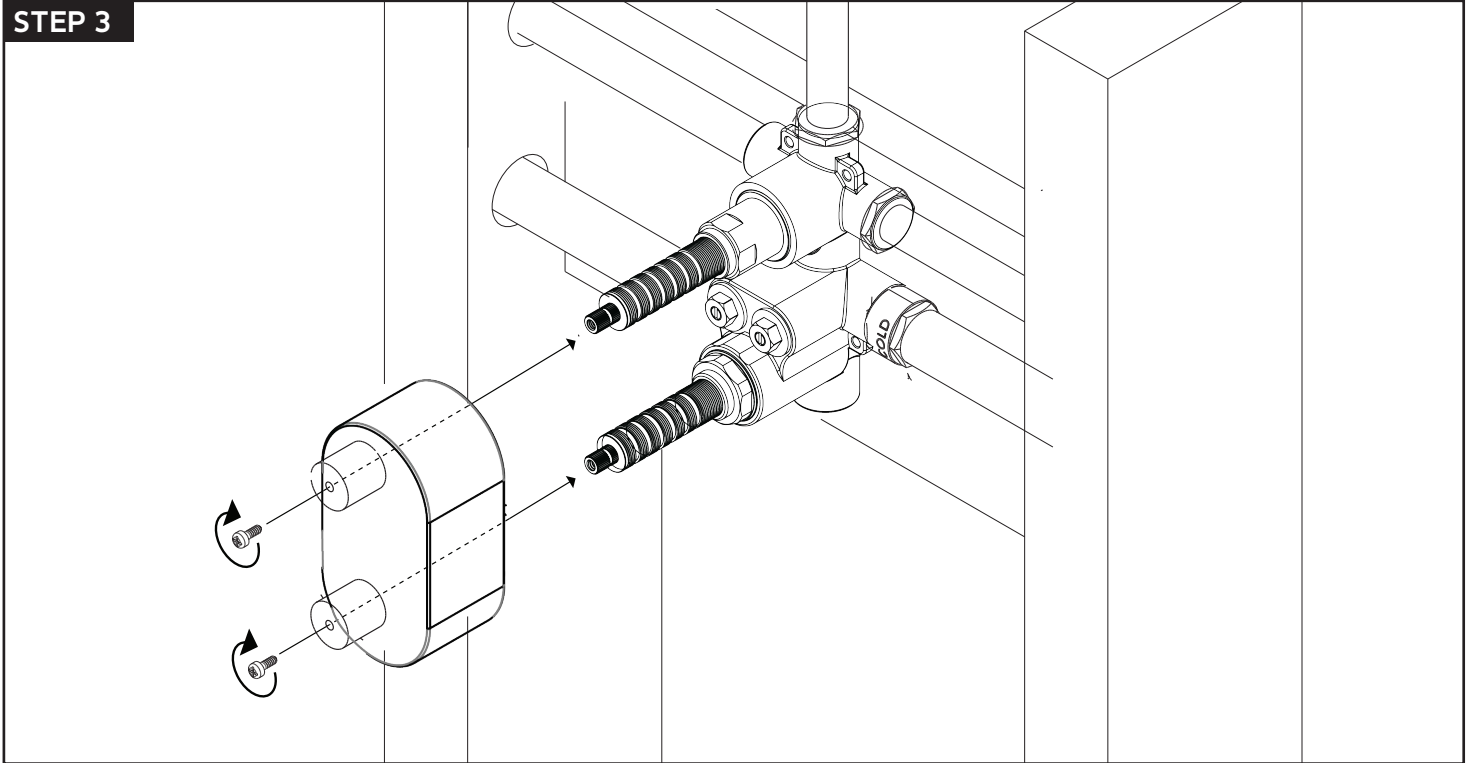

### STEP 4

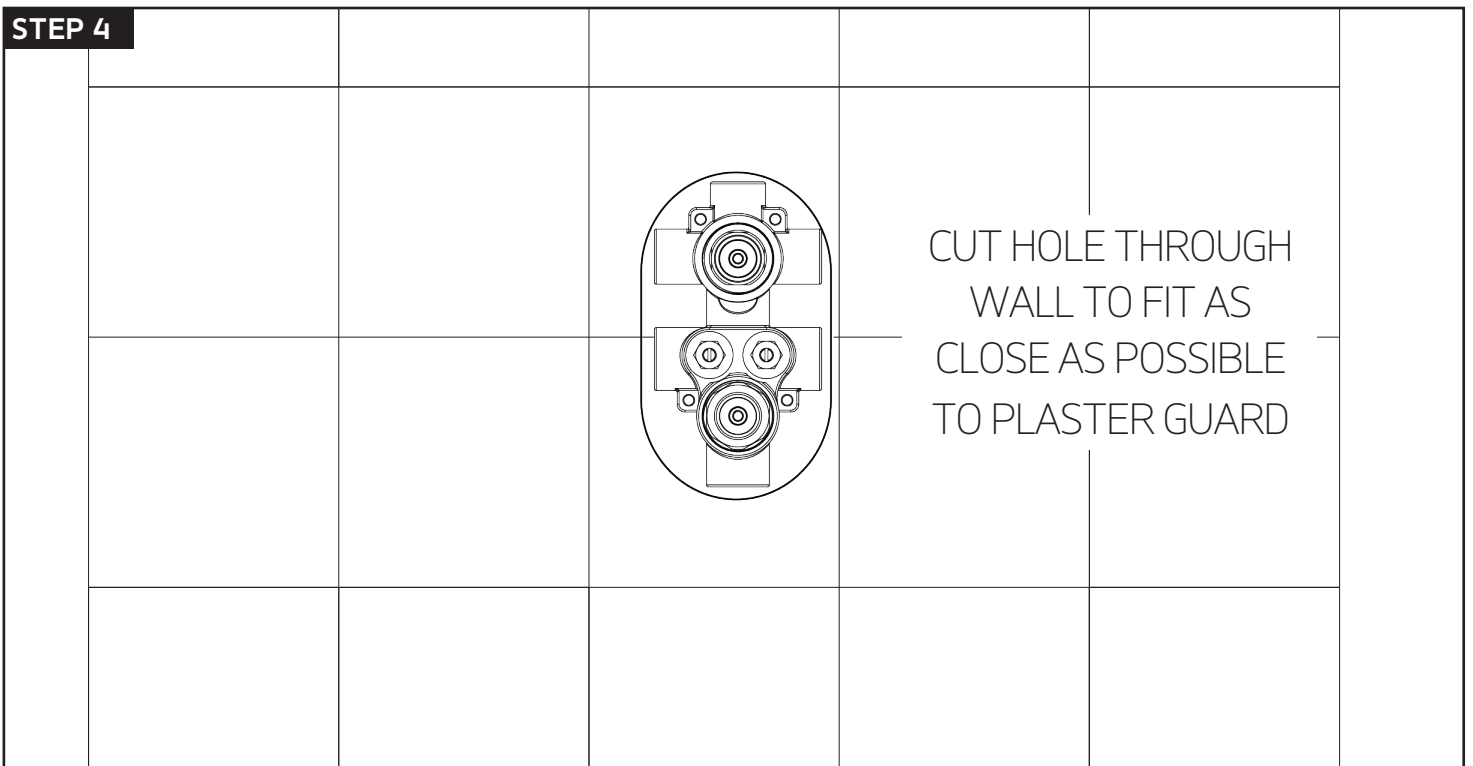

thermostatic valve with 3-way  
non-shared diverter

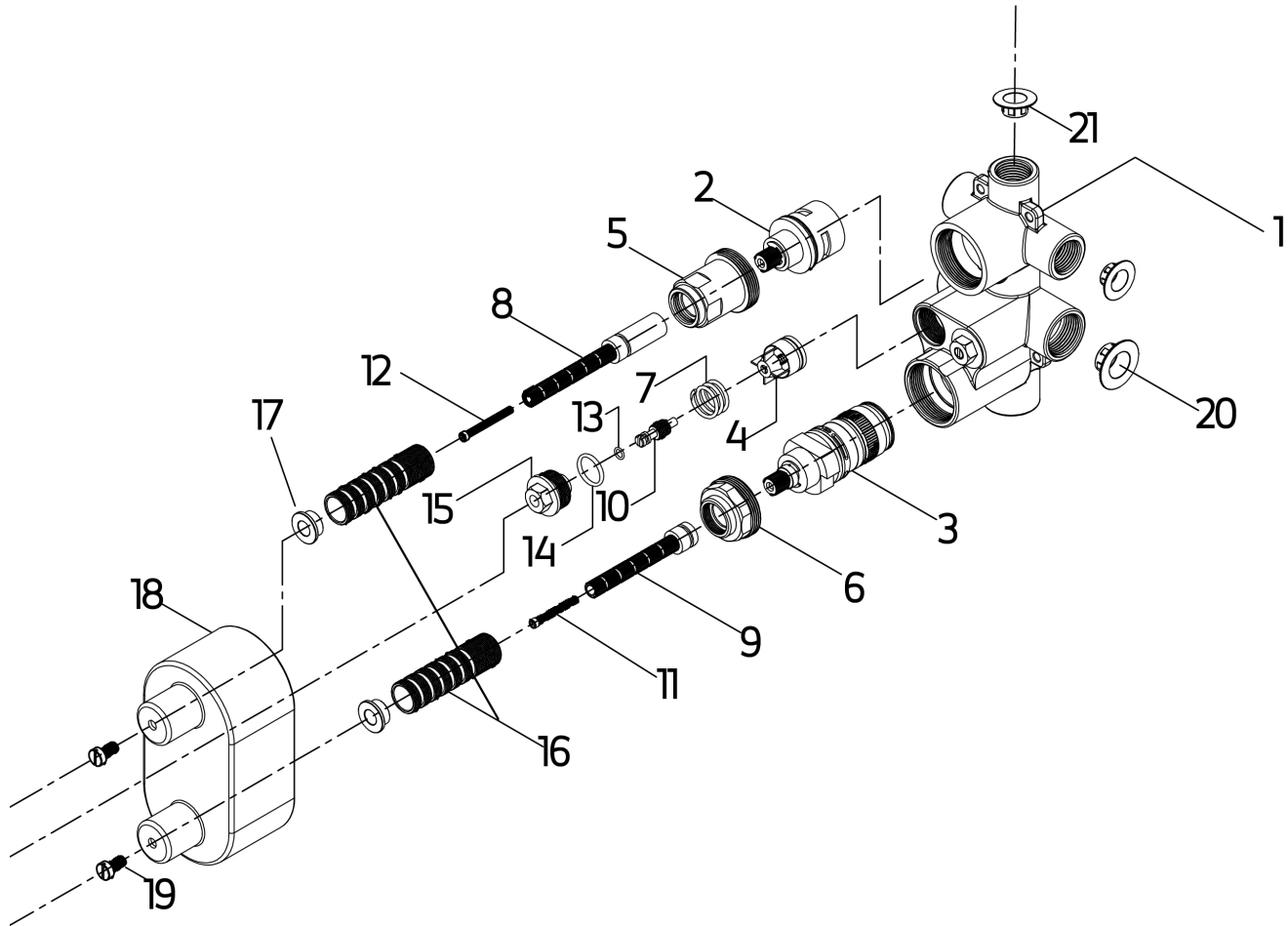

- |   |                               |   |                      |
|---|-------------------------------|---|----------------------|
| ① | VALVE BODY                    | ⑭ | 17 X 2 O RING        |
| ② | NON SHARED DIVERTER CARTRIDGE | ⑮ | NRV NUT X2           |
| ③ | VERNET THERMOSTATIC CARTRIDGE | ⑯ | OUTER SPINDLE X2     |
| ④ | NEOPERL AERATOR X2            | ⑰ | SLEEVE BUSH X2       |
| ⑤ | DIVERTER CARTRIDGE NUT        | ⑱ | PLASTER GUARD        |
| ⑥ | THERMOSTATIC CARTRIDGE NUT    | ⑲ | 3/16" X 1/2" BOLT X2 |
| ⑦ | NRV SPRING X2                 | ⑳ | 3/4" DUST CAP X2     |
| ⑧ | DIVERTER INNER SPINDLE        | ㉑ | 1/2" DUST CAP X3     |
| ⑨ | THERMOSTAT INNER SPINDLE      |   |                      |
| ⑩ | NRV SPINDLE X2                |   |                      |
| ⑪ | 10 X 2 O RING                 |   |                      |
| ⑫ | SPACER WASHER X2              |   |                      |
| ⑬ | 4 X 1.6 O RING X2             |   |                      |



thermostatic valve with 3-way  
non-shared diverter

artos® faucets:

- Use a soft, dampened sponge or cloth. On no account should you use an abrasive material such as a brush, scouring pad or steel wool to clean surfaces.
- Test your cleaning agent solution on an inconspicuous area before applying to the entire faucet.
- Wipe surfaces clean and rinse completely with water immediately after applying cleaning agent.
- An ideal cleaning technique is to rinse faucet thoroughly and blot dry any water from the surface after each use.

## LIMITED LIFETIME WARRANTY

### ARTOS FAUCET LIFETIME LIMITED WARRANTY (Residential – Canada/U.S)

Westover, Inc. dba ARTOS ("we, us, our") warrants our sink faucets to the original consumer purchaser only ("you, your") to be free of leaks and defects in materials or workmanship for as long as you own the faucet and live in the residence in which the faucet is originally installed.

This warranty is effective from the date of sale as shown on your proof of purchase and is not transferable to a subsequent owner. There is an exception for electronic components which are warranted for three years.

#### What We Will Do to Fix the Problem

We will free of any charge to you, replace any faucet part, or component that is defective or if the faucet cannot be economically repaired, replace the faucet with the same or a comparable model faucet or if a the same or a comparable model faucet is not available, make a reasonable monetary adjustment taking into account the age of the defective faucet.

In no event will our liability exceed the price you paid for the faucet (including tax and shipping, if applicable).

We will pay all shipping charges including the cost to return a faucet to us for inspection (if we make that request.) Replaced faucets, faucet parts, or components assume the remaining term of this warranty but not less than ninety (90) days from the date on which the replacement faucets, parts, or components are shipped by us.

#### Limitation on the Duration of Implied Warranties

The duration of implied warranties (including those of merchantability and fitness for purpose) created by state, provincial, or territorial law is limited to the term of the warranty set out in this document. Some states, provinces, and territories do not allow the exclusion or limitation of implied warranties, so the above exclusions or limitations may not apply to you.

#### How to Make a Warranty Claim

To make a warranty claim, simply telephone customer service at (402)–397-3344, e-mail us [customerservice@artos.us.com](mailto:customerservice@artos.us.com), or write to us

at Westover, Inc, 13305 B Street, Omaha, NE 68144. Please provide your daytime telephone number and e-mail address. Once you have initiated a warranty claim, we will guide you through the rest of the claim process. You will need a proof of purchase (usually a sales receipt) from an authorized ARTOS dealer.

#### What This Warranty Does not Include

This warranty does not include:

Leaks or defects caused by abuse, misuse, accident, maintenance or cleaning other than in accordance with our care and maintenance instructions; installation not in accordance with our installation guide or with industry standards; mineral accumulation; Acts of God or the government; intentional, reckless, or negligent acts; and ordinary wear and tear.

Any industrial, commercial, and/or business use including use in a rental property (unless occupied by the original purchaser).

Labor charges including but not limited to labor required to uninstall, install, or reinstall a faucet, to disassemble and reassemble the faucet, or to install or affix replacement parts or components. Incidental or consequential damages. Some states, provinces, and territories do not allow the exclusion of incidental or consequential damages, so the above exclusions may not apply to you. Faucets purchased from an unauthorized source or in violation of our minimum advertised pricing policy.

#### Your Rights Under State, Provincial, or Territorial Consumer Law

This warranty gives you specific legal rights and you may also have other rights that vary from state to state, province to province, and territory to territory.

Effective Date of This Warranty

This warranty applies to faucets sold in or delivered into Canada or the United States on or after July 1, 2021.