

### PRODUCT SPECIFICATIONS

Elkay Stainless Steel 18" x 14-1/2" x 11" 18 Gauge Hand Sink with Dual Side Splashes and Faucet. Sink is manufactured from 18 gauge Stainless Steel with a #4 Finish finish, Center drain placement.

|                           |                     |
|---------------------------|---------------------|
| <b>Material:</b>          | Stainless Steel     |
| <b>Finish:</b>            | #4 Finish           |
| <b>Gauge:</b>             | 18                  |
| <b>Number of Bowls:</b>   | 1                   |
| <b>Sink Dimensions:</b>   | 18" x 14-1/2" x 11" |
| <b>Bowl 1 Dimensions:</b> | 14" x 10" x 5"      |
| <b>Drain Size:</b>        | 1-1/2" (38mm)       |
| <b>Drain Location:</b>    | Center              |
| <b>Mounting Hardware:</b> | Included            |

**Special Note:** Splash Mount, Goose Neck Facuet Included

|   |  |
|---|--|
| <b>Custom Options</b>                             |  |
| <input type="checkbox"/> Type 316 Stainless Steel |  |
| <b>Drain Location</b>                             |  |
| <input type="checkbox"/> Right Rear               | <input type="checkbox"/> Left Rear         |
| <input type="checkbox"/> Center                   | <input type="checkbox"/> Center Rear       |
| <b>Overflow Location</b>                          |  |
| <input type="checkbox"/> Front                    | <input type="checkbox"/> Rear              |
| <b>Alternate Punching</b>                         |  |
| <input type="checkbox"/> Faucet Model:            | <input type="checkbox"/> Punch Required:   |
| <b>Sink Size</b>                                  |  |
| <input type="checkbox"/> Bowl Depth:              | <input type="checkbox"/> Drainboard Width: |



**Included with Product:** Side splashes and faucet.

AMERICAN PRIDE. A LIFETIME TRADITION.

Like your family, the Elkay family has values and traditions that endure. For almost a century, Elkay has been a family-owned and operated company, providing thousands of jobs that support our families and communities.

**Product Compliance:** ASME A112.19.3/CSA B45.4  
NSF 2  
**Faucet:** ASME A112.18.1/CSA B125.1  
NSF 372 (lead free)  
NSF 61  
**Accessory:** ASME A112.18.2/CSA B125.2

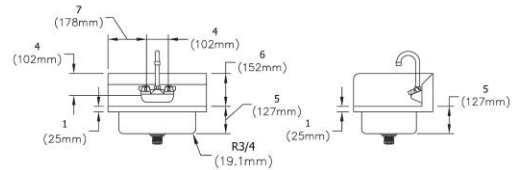
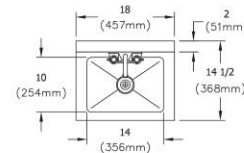

PART: \_\_\_\_\_ QTY: \_\_\_\_\_

PROJECT: \_\_\_\_\_

CONTACT: \_\_\_\_\_

DATE: \_\_\_\_\_

NOTES: \_\_\_\_\_

APPROVAL: \_\_\_\_\_

*In keeping with our policy of continuing product improvement, Elkay reserves the right to change product specifications without notice. Please visit [elkay.com](http://elkay.com) for the most current version of Elkay product specification sheets. This specification describes an Elkay product with design, quality, and functional benefits to the user. When making a comparison of other producers' offerings, be certain these features are not overlooked.*