

Operation manual 14"LED Flush mount light Drum

**Models :62-985,62-986,62-987,62-988,
62-989,62-990**

With Integrated Dimmable Driver



Thank you for purchasing our product. This fixture has been manufactured from components with advanced optoelectronics to ensure high reliability and long life. Before assembling please read this Operation Manual carefully and save in a safe place for future reference. Please note that all electrical connections must be in accordance with local and National Electrical Code standards as well as local building codes. In case you are not familiar with proper wiring connections and building codes, consult a qualified electrician.

Safety recommendations

1. RISK OF ELECTRIC SHOCK – THIS PRODUCT MUST BE INSTALLED IN ACCORDANCE WITH APPLICABLE INSTALLATION CODES BY A PERSON FAMILIAR WITH MENTIONED ABOVE CODES AND HAZARDS INVOLVED. DISCONNECT POWER AT CIRCUIT BREAKER OR FUSE BEFORE INSTALLING OR SERVICING.
2. Before use of the product carefully read the whole Operation Manual.
3. THE PRODUCT IS PURPOSED FOR INTERIOR USE ONLY, SUITABLE FOR DAMP LOCATIONS.
4. Protect the product against direct contact with water.
5. Assemble the product only with the use of parts provided and the housing; improper assembly may result in device failing which could damage the product, personal property or cause injury.
6. Assembly shall follow with accessories delivered with the set only.
7. The device is not a toy, KEEP OUT OF REACH OF CHILDREN.

Specifications:

Models: 62-985,62-986,62-987,62-988
62-989,62-990
Operating Voltage:120 VAC
Dimming: 120V Triac only
Power consumption: 16.5W
Color Temp.: 2700K/3000K/4000K/5000K
Life span: 40,000h
Illumination authorization <5%
per 10,000h



As an ENERGY STAR partner, Satco has determined that this product meets the ENERGY STAR® guidelines for energy efficiency

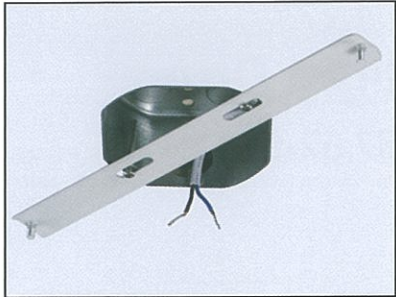

Step 1

Attach installation bracket to junction box using two screws (provided)

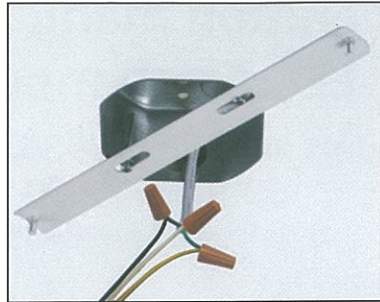

Step 2

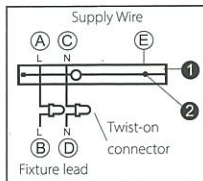

1. Connect live supply wire (A) (typically black or the smooth, unmarked side of the two-conductor wires) to live fixture lead (B) with appropriately sized twist-on connector.
2. Connect neutral supply wire (C) (typically white or the ribbed, marked side of the two-conductor wires) to neutral fixture lead (D).
3. For positive grounding in a 3-wire electrical system, fasten the fixture ground (E) (typically copper or green plastic coated) to the fixture mounting strap (1) with the ground screw (2).

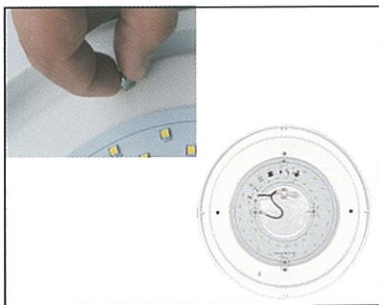

Step 3

Attach base of fixture to mounting bracket using two nuts (provided).



Step 4

Align decorative drum with locking ramps to fixture pins and twist until it locks into place.

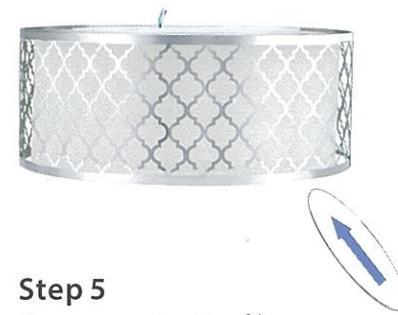

Step 5

Remove protective film on diffuser (provided). Tilt the diffuser and slide into drum. Gently rest it on bottom of drum.



Enjoy your light!

Dimming

This product is compatible with most residential type dimmers available on the market. The dimming performance will depend on kind of dimmer and dimmer settings. Visit www.satco.com for an up to date list of compatible dimmers.

Cleaning

- Clean with a soft or damp cloth. While cleaning with the damp cloth make sure the power is OFF.
- Do not clean with liquids or abrasives.

5 Year limited warranty

The purchased product is covered with a 5 year warranty with respect to any defect in material or workmanship after purchase date.

Satco shall bear no responsibility on account of guarantee, as well as shall bear no liability for any faults, in case of improper operation, use, negligence, accident or exposure to any natural hazard, or excessive use over the limits specified for the unit, or if any unauthorized alteration or repair was made after purchase.