

# KINGSTON BRASS

THE TRADITION OF FINE BRASS

## Hose Bibb Vacuum Breaker Installation

### Installation instruction:

Your Vacuum breaker should be installed on a 3/4" male hose thread connection located at least 6" above the ground.

Loosen side screw, thread Vacuum breaker onto hose bibb, once hose bibb has been properly fastened, tighten side screw, this will prevent the HVB from coming loose when removing hose.

Thread hose onto HVB.

Thread hose onto hose bibb

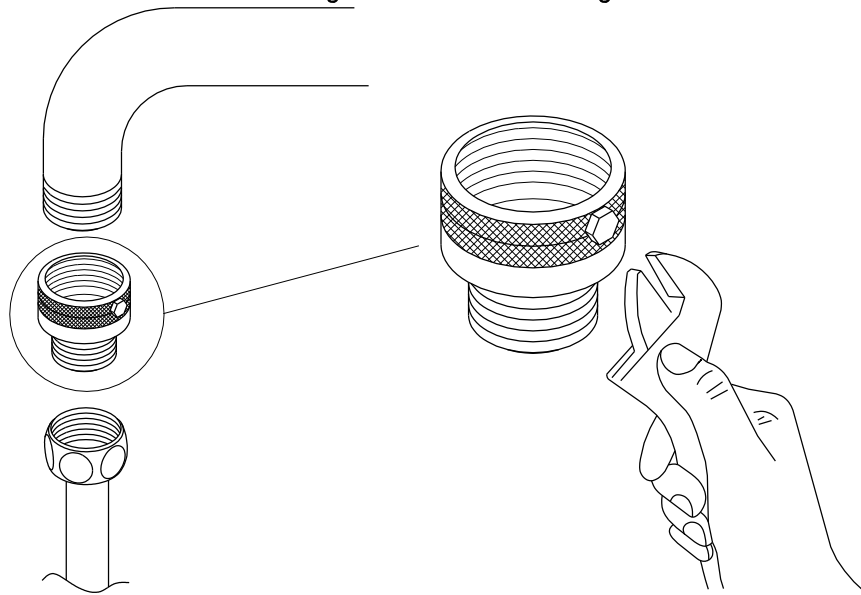

### Maintenance & Care:

Hose Bibb vacuum breaker do not require much maintenance as they are made of brass and there are few moving parts.

However there are things you can do to make sure that your vacuum breaker is working at its optimum performance.

1. Check for leaks during normal operation by visual inspection.
2. Verify that the check valve closes and the atmospheric vent opens reliably whenever the water supply is shut off. It is very simple to do this if a nozzle that can be shut off is used on the end of the hose. With the nozzle shut off, turn on the faucet and allow the hose to pressurize. Then, shut off the faucet while the hose is pressurized. After a few seconds, the hose pressure should be released in a small spray as the atmospheric vent suddenly opens.

Leaks during normal operation may indicate the presence of chemical precipitates or particulate matter which prevent components from seating properly, or defective O-rings or washers. If leaks are detected, shut off the water supply, remove and inspect the entire HVB-faucet assembly. Replace it if components are defective. Clean it by flushing water through it while working the spring mechanism to dislodge loose particles.

If cleaning does not restore it to proper operation, then replace it. If the atmospheric vent does not operate when the faucet is shut off while the hose is pressurized, it may be because buildup of precipitates is causing this valve to stick.

Disconnect the hose and exercise the valve and the spring by moving the plunger up and down and from side to side. If this does not free up the valve so that it operates properly, replace it.

Because an HVB is difficult to remove after installation on a hose bibb, it may be necessary to replace both components at the same time. However, because of the high reliability of HVB's, this should not occur frequently. Fortunately, hose bibbs are also not very expensive (less than \$5).

[www.kingstonbrass.com](http://www.kingstonbrass.com)

TOLL-FREE CUSTOMER SERVICE: 1-877-2-KBRASS

TECHNICAL SUPPORT E-mail: [service@kingstonbrass.com](mailto:service@kingstonbrass.com)

12775 Reservoir Street, Chino, CA91710

©2015-08-TK Kingston Brass