

# 71000 & 72000 ACA (American Cylinder Above) - shown & ACB (American Cylinder Below)

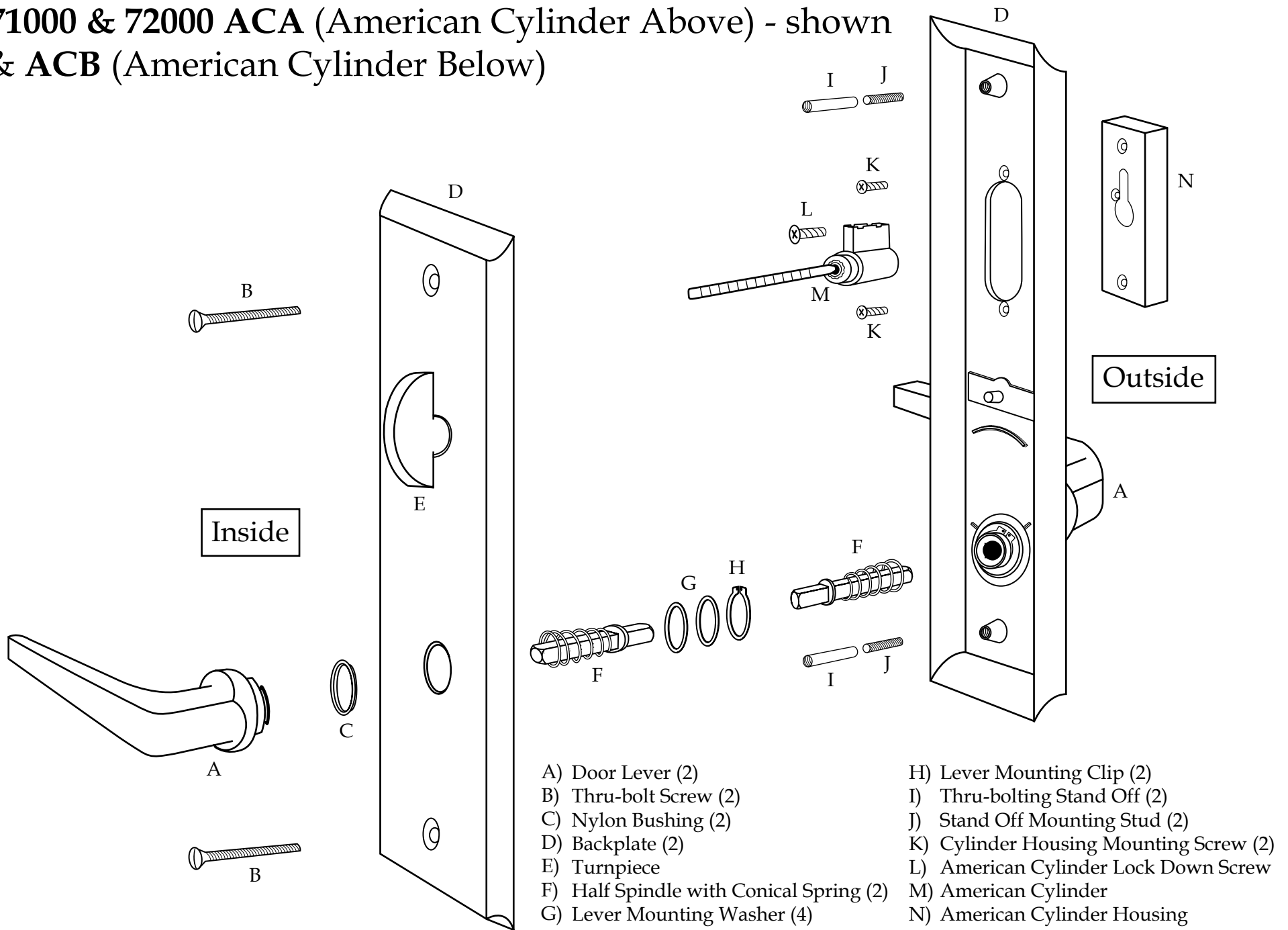

- A) Door Lever (2)
- B) Thru-bolt Screw (2)
- C) Nylon Bushing (2)
- D) Backplate (2)
- E) Turnpiece
- F) Half Spindle with Conical Spring (2)
- G) Lever Mounting Washer (4)
- H) Lever Mounting Clip (2)
- I) Thru-bolting Stand Off (2)
- J) Stand Off Mounting Stud (2)
- K) Cylinder Housing Mounting Screw (2)
- L) American Cylinder Lock Down Screw
- M) American Cylinder
- N) American Cylinder Housing

# 71000 & 72000 ECB (European Cylinder Below)

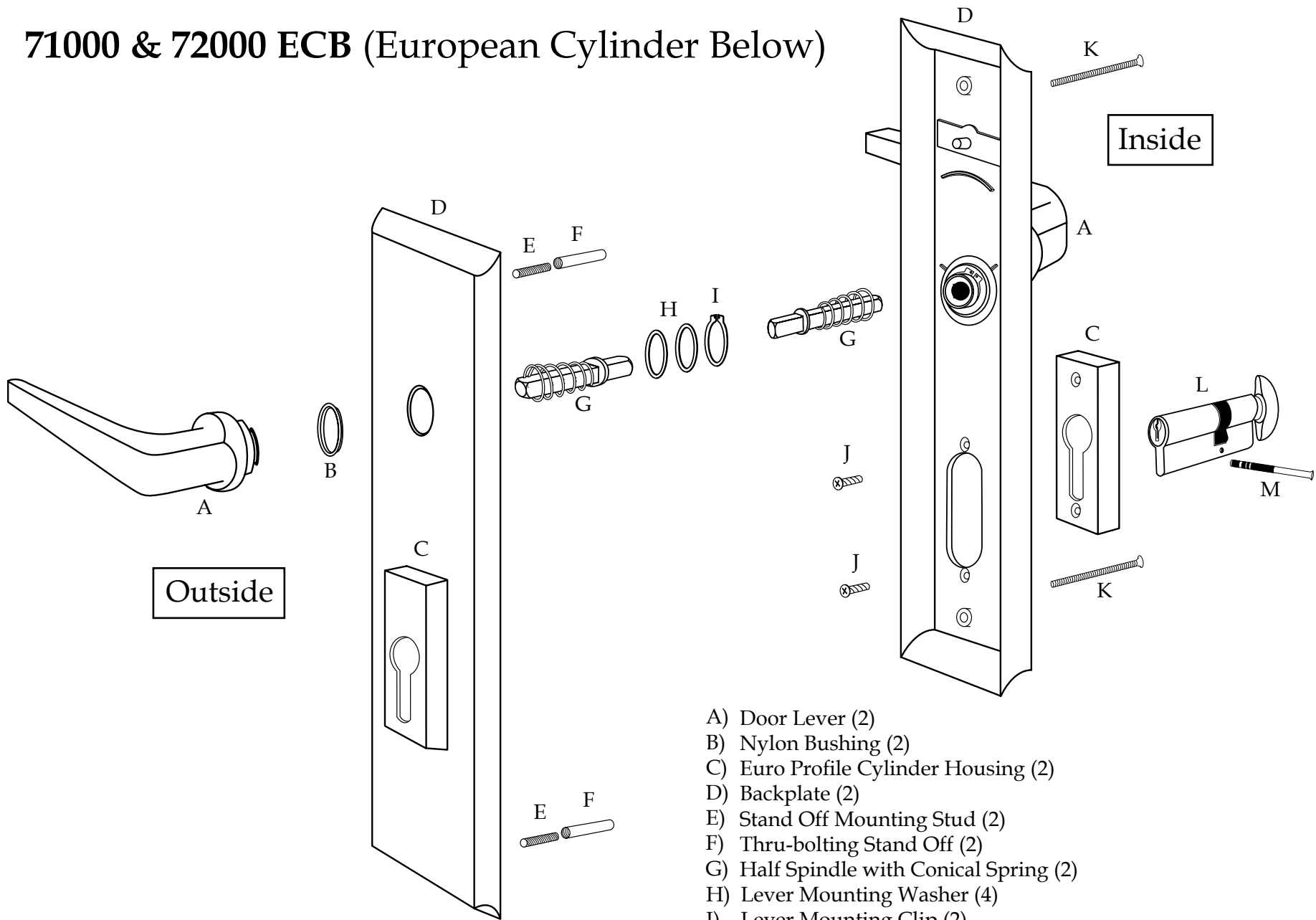

- A) Door Lever (2)
- B) Nylon Bushing (2)
- C) Euro Profile Cylinder Housing (2)
- D) Backplate (2)
- E) Stand Off Mounting Stud (2)
- F) Thru-bolting Stand Off (2)
- G) Half Spindle with Conical Spring (2)
- H) Lever Mounting Washer (4)
- I) Lever Mounting Clip (2)
- J) Cylinder Housing Mounting Screw (2)
- K) Thru-bolt Screw (2)
- L) Euro Profile Cylinder
- M) Cylinder Lock Down Screw