

Marchio / Brand ZUCCHETTI

Classe / Class

ON

## ON

### ZON646

Termostatico incasso doccia deviatore 2/3 vie. / Built-in thermostatic shower mixer and 2/3 way diverter



Termostatico incasso doccia da 1/2" e deviatore a 2/3 vie con apertura/chiusura acqua.

1/2" built-in thermostatic shower mixer and 2/3 way diverter with water on/off function.

R97810

Parte incasso termostatico 2 vie / Built-in part -  
2 way thermostatic mixer



R97815

Parte incasso termostatico 3 vie / Built-in part -  
3 way thermostatic mixer



## Finiture / Finishes



Cromo / Chrome



Nickel Spazzolato /  
Brushed Nickel

C3

## ON

ZON646

Disegno Complessivo / Overall Drawing

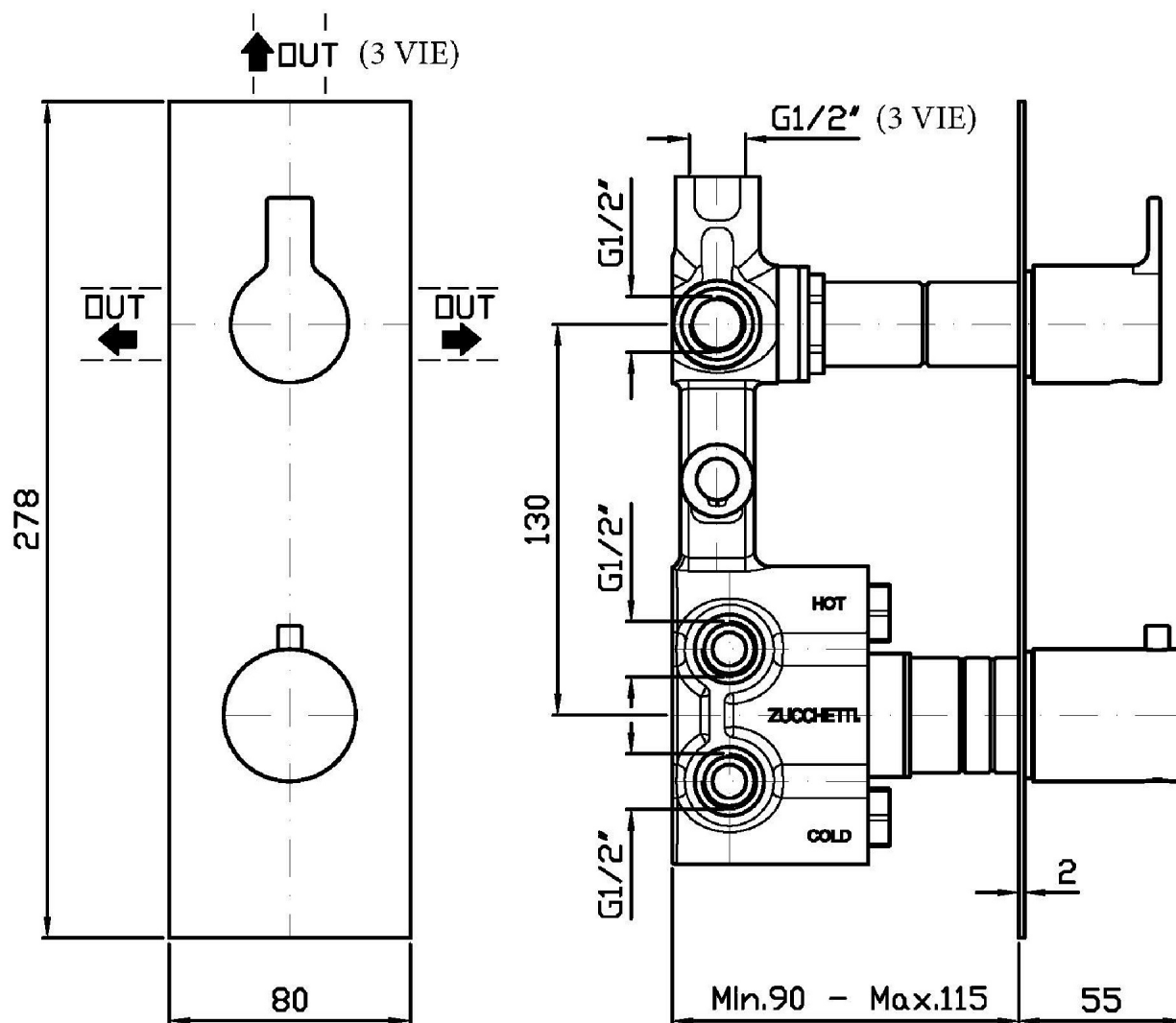

## ON

ZON646

Esplosi / Exploded

R97416: PER DEVIATORE A 2 VIE R97810 (2 way diverter R97810)  
R97417: PER DEVIATORE A 3 VIE R97815 (3 way diverter R97815)

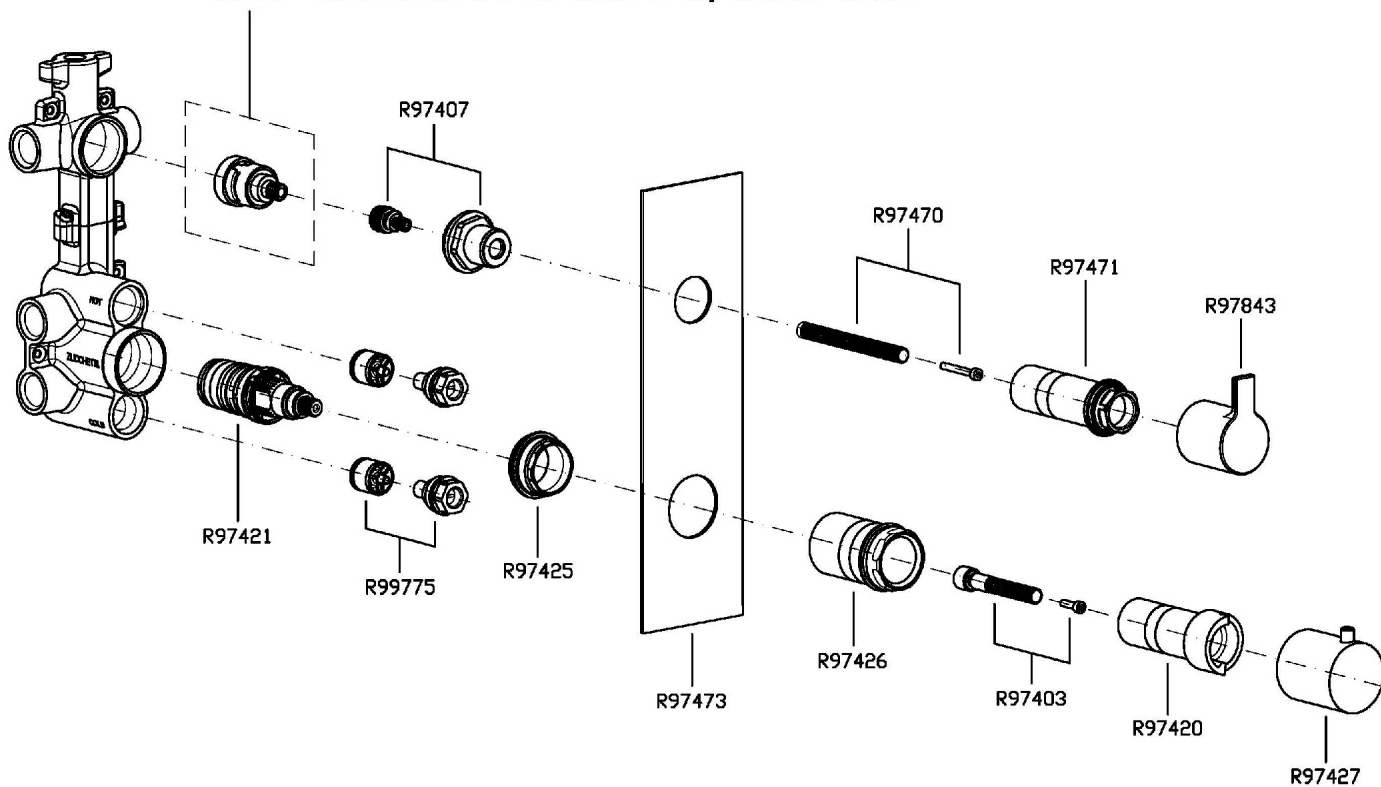

Marchio / Brand ZUCCHETTI

Classe / Class

ON

## ON

### ZON646 Certificazioni / Certifications

CINA\_HONG\_KONK

GB test report

## ON

### ZON646 Portate / Flowrates (lt/min)

| PRESSIONE<br>PRESSURE | 1 BAR | 2 BAR | 3 BAR | 4 BAR | 5 BAR |
|-----------------------|-------|-------|-------|-------|-------|
| DEVIATORE<br>DIVERTER | 11,5  | 16,2  | 19,5  | 23,2  | 26    |
| P1                    |       |       |       |       |       |
| P2                    |       |       |       |       |       |
| P3                    |       |       |       |       |       |
| P4                    |       |       |       |       |       |
| P5                    |       |       |       |       |       |

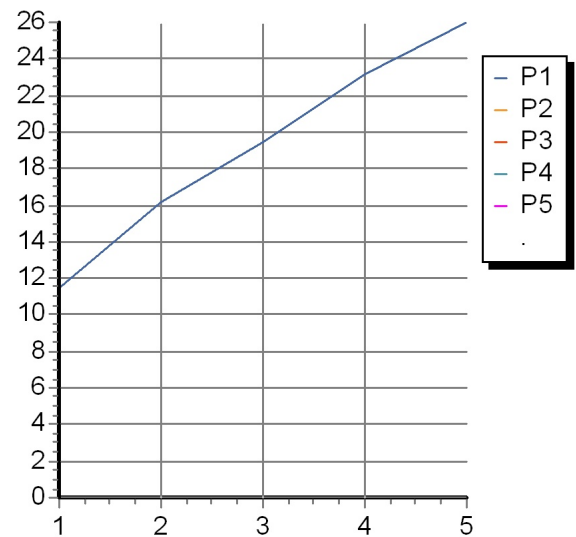

## ON

### ZON646 Pesì e Misure / Weights and Sizes

|                           |              |                  |
|---------------------------|--------------|------------------|
| Peso ( Kg ) Weight ( lb ) | 1,369 ( Kg ) | 3,0180974 ( lb ) |
| Volume ( dc3 ) - ( in3 )  | 5,68 ( dc3 ) | 0,000347 ( in3 ) |
| h ( mm ) - ( in )         | 75 ( mm )    | 2,9527575 ( in ) |
| L1 ( mm ) - ( in )        | 180 ( mm )   | 7,086618 ( in )  |
| L2 ( mm ) - ( in )        | 420 ( mm )   | 16,535442 ( in ) |

