

ELENA 600 WALL HUNG BASIN

Cat. No
4-93X



Faucet not included

W: 23- $\frac{5}{8}$ "
D: 18- $\frac{1}{8}$ "
H: 7- $\frac{1}{4}$ "

Back of basin to center of faucet: 2- $\frac{1}{2}$ "
Back of basin to center of drain: 8"
Mount holes cc: 11"

Interior Dimensions:

Basin Interior: 18 x 12"
Basin Depth: 5- $\frac{1}{2}$ "
Spout hole: 1- $\frac{3}{8}$ "

Features:

- ▶ Wall hung basin
- ▶ Made of Vitreous China
- ▶ Pre-drilled overflow hole
- ▶ Available with 1-hole (4-931) or 8" widespread (4-938)
- ▶ Can be install using toggle bolts or molly bolts (Not Included)

Colors

WH White

Meets or exceeds the following specifications: ASME A112.19.2 2013 and CSA B45.1-13 for ceramic plumbing fixtures.

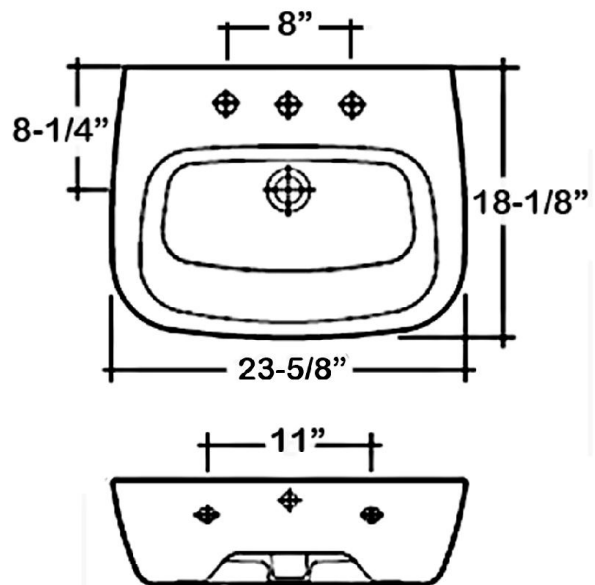

Dimensions of fixture are nominal and may vary within the range of tolerances established by ASME Standard A112.19.2.2013 Dimensions and specifications subject to change without notice.