

KARLA 650 WALL HUNG BASIN

Cat. No
4-85X



Faucet not included



Mounting hardware

W: 25-5/8"
D: 20-1/8"

Back of basin to center of faucet: 2-3/4"
Back of basin to center of drain: 8"

Interior Dimensions:

Basin Interior: 21-1/2" x 13"
Basin Depth: 6"
Spout hole: 1-3/8"

Features:

- ▶ Wall hung basin
- ▶ Made of Vitreous China
- ▶ Pre-drilled overflow hole
- ▶ Available with 1-hole (4-851) , 4"cc (4-854) or 8" widespread (4-858)
- ▶ Mounting hardware included

Colors

WH White

Meets or exceeds the following specifications: ASME A112.19.2 2013 and CSA B45.1-13 for ceramic plumbing fixtures.

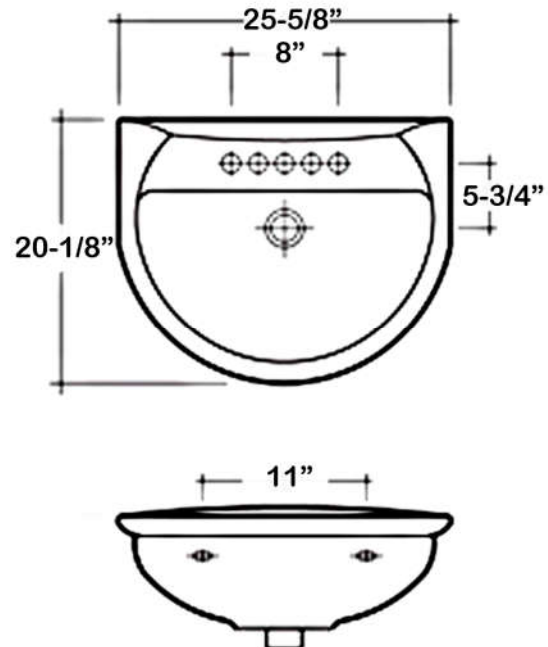

Dimensions of fixture are nominal and may vary within the range of tolerances established by ASME Standard A112.19.2.2013 Dimensions and specifications subject to change without notice.