

# KARLA 505 WALL HUNG BASIN

Cat. No  
4-82X



Faucet not included



Mounting hardware

W: 20"  
D: 16"

Back of basin to center of faucet: 2-½"  
Back of basin to center of drain: 7-½"

## Interior Dimensions:

Basin Interior: 16" x 10"  
Basin Depth: 4-½"  
Spout hole: 1-⅜"

## Features:

- ▶ Wall hung basin
- ▶ Made of Vitreous China
- ▶ Pre-drilled overflow hole
- ▶ Available with 1-hole (4-821) 4" cc (4-824) or 8" widespread (4-828)
- ▶ Mounting hardware included

## Colors:

WH White

Meets or exceeds the following specifications: ASME A112.19.2 2013 and CSA B45.1-13 for ceramic plumbing fixtures.

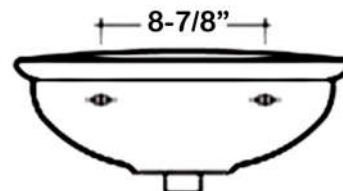
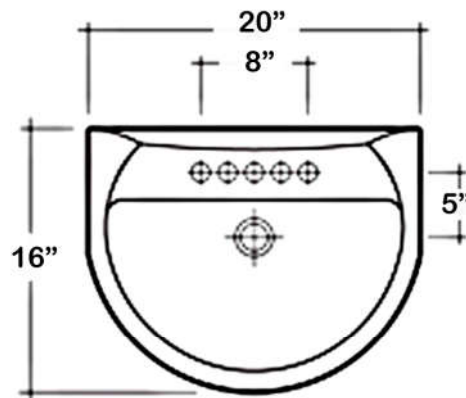

Dimensions of fixture are nominal and may vary within the range of tolerances established by ASME Standard A112.19.2.2013. Dimensions and specifications subject to change without notice.