

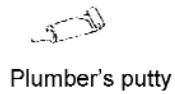

Widespread Lavatory Faucet LFW104

INSTALLATION INSTRUCTIONS

Tools You Will Need:



Plumber's putty

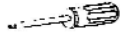

Philips Screwdriver



Pipe tape



Pliers



Adjustable wrench

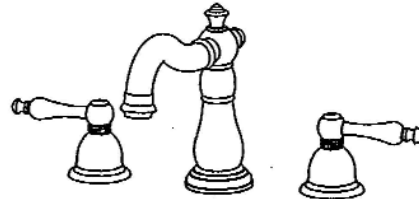

Available Handle Options

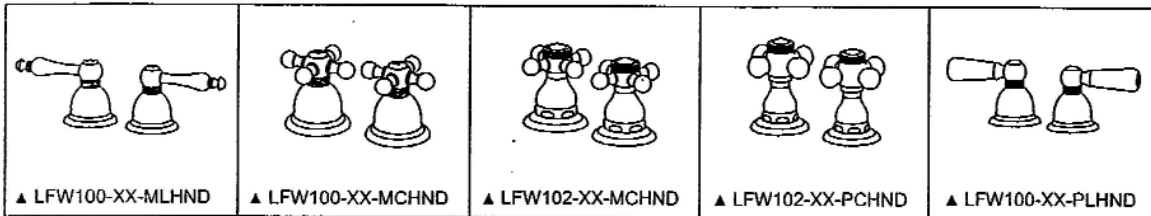

Two-handle Lavatory Faucet

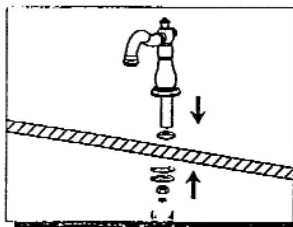

1. Apply silicone sealant around bottom of spout, place spout in center hole of sink. Secure with pictured parts.

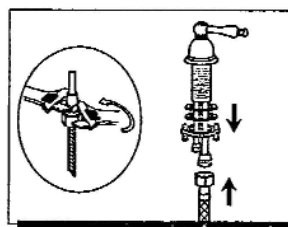

2. Remove mounting hardware from handle body. Connect water supply tube to valve body and tighten with lock nut. Do not allow the water supply brass tube to twist. Use two wrenches, as shown in the diagram. Tighten wrench tight.

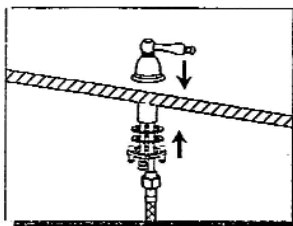

3. Place the handle body through right hole. Re-assemble the parts and screw with lock nut.

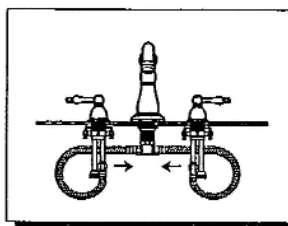

4. Connect handle body and faucet body with water supply tube and tighten with lock nut.

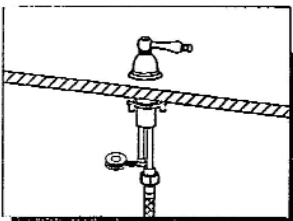

5. Apply pipe tape on the thread of inlet port.

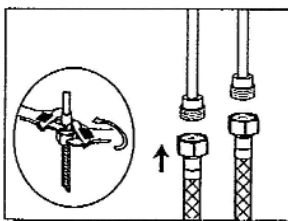



Widespread Lavatory Faucet LFW104

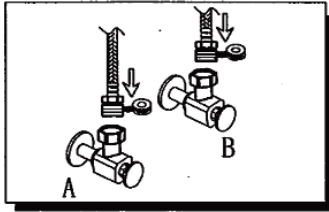

7. Connect water supply tube and tighten with lock nut.

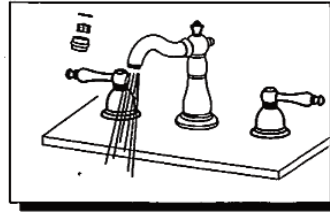

8. After installing faucet, remove aerator and turn on water to remove any left over debris. Re-assemble aerator.

Exploded Drawing:

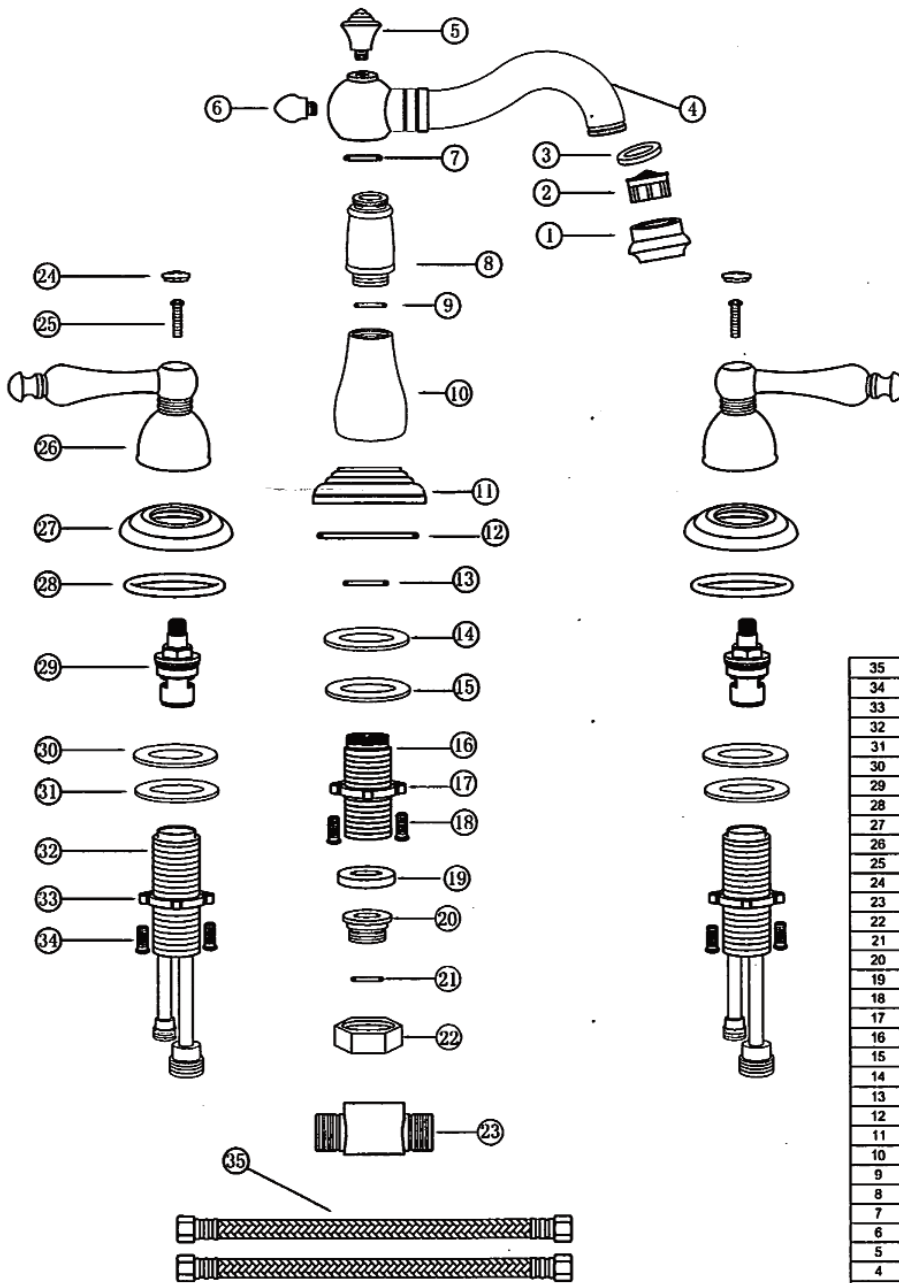

35	Braded Hose	2
34	Screw	4
33	Lock Nut	2
32	Valve Body	2
31	Metal Washer	2
30	Rubber Washer	2
29	Ceramic Disc Cartridge	2
28	O-ring	2
27	Handle Trim Ring	2
26	Handle	2
25	Screw	2
24	Handle Cap	2
23	Adapter	1
22	Lock Nut	1
21	O-ring	1
20	Nut	1
19	Gasket	1
18	Screw	4
17	Lock Nut	1
16	Spout Shank	1
15	Metal Washer	1
14	Rubber Washer	1
13	O-ring	1
12	O-ring	1
11	Spout Trim Ring	1
10	Spout Connection	1
9	O-ring	1
8	Spout Connection	1
7	O-ring	1
6	Spout Trim End	1
5	Spout Trim Cap	1
4	Spout Assembly	1
3	Gasket	1
2	Aerator	1
1	Aerator cover	1
No.	Part Description	Quantity