

MAURICE 71" CAST IRON DOUBLE SLIPPER TUB

Cat. No.
CTDSN71



Features:

- ▶ Inside finish is white enamel
- ▶ Faceted jewel feet are cast iron
- ▶ No Faucet holes
- ▶ Continuous rolled rim
- ▶ Pre-drilled overflow
- ▶ Tub is thoroughly inspected before shipment



WARNING: This product can expose you to chemicals, including lead which is known to the State of California to cause cancer or birth defects or other reproductive harm, for more information, go to www.p65warnings.ca.gov

Custom Colors Available (inside of tub is always white enamel):
Painted bathtubs are considered "special order" and are not returnable
\$160 Bisque or Black \$250 Designer Color

L: 70-7/8"
W: 30-1/2"
H: 27-1/8" (from floor to top of tub)

Water depth: 19-3/8" to top of tub
Water depth: 15-1/8" to overflow

The following is recommended for
CTDSN71 tubs:

- Fauce: part #4601, 4604 or 7082
- Rigid, freestanding supplies: part #4502
- Leg tub drain: part #5599

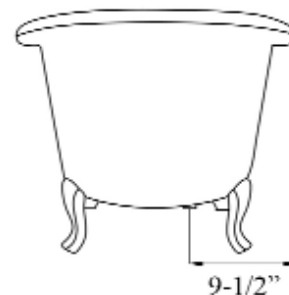
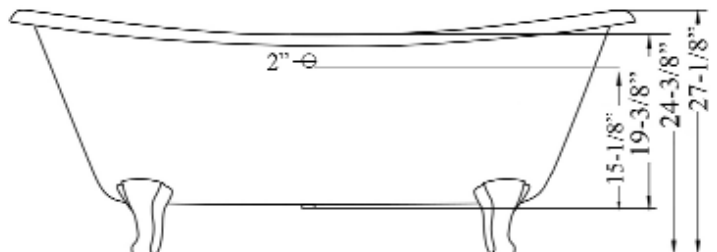
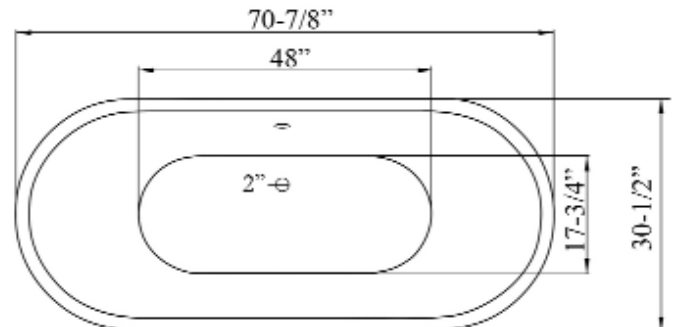

Gallon Capacity:	50
Shipping Weight:	490 lbs.
Empty Weight:	390 lbs.
Filled Weight:	808 lbs.