

Doyle 67" Cast Iron Double Roll Top Tub with Base

Cat. No.
CTDRN67BP-PI



L: 67-³/₄"
W: 31"
H: 23-¹/₄" (from floor to top of tub)
18-¹/₂" (from bottom of tub to top)

Water depth: 15" to overflow

The following is recommended for CTDRN67BP-PI tubs with deck holes:

- Faucet part #4602, 4604 or 4022
- Rigid, freestanding supplies: part #4502
- Freestanding filler: part #7934, 7952 or 7918
(Does not need bath supplies)
- Leg tub drain: part #5599

Note

To prevent the accumulation of standing water under your tub base we recommend using a bead of silicone between the base and the floor.

Gallon Capacity: 55
Shipping Weight: 570 lbs.
Empty Weight: 450 lbs.
Filled Weight: 909 lbs.



WARNING: This product can expose you to chemicals, including lead which is known to the State of California to cause cancer or birth defects or other reproductive harm, for more information, go to www.p65warnings.ca.gov

Features:

- ▶ Inside finish is white enamel
- ▶ Tub exterior is Polished
- ▶ No faucet holes with tub deck
- ▶ Pre-drilled overflow
- ▶ Non-skid Strips
- ▶ Tub and base combination ships in one pallet
- ▶ Cutout in base for waste and overflow
- ▶ Tub is thoroughly inspected before shipment



This tub is raw cast iron with a polished finish showing all the flaws of the natural metal. Call our Customer Service department if you would like to see additional closeup images before purchase.

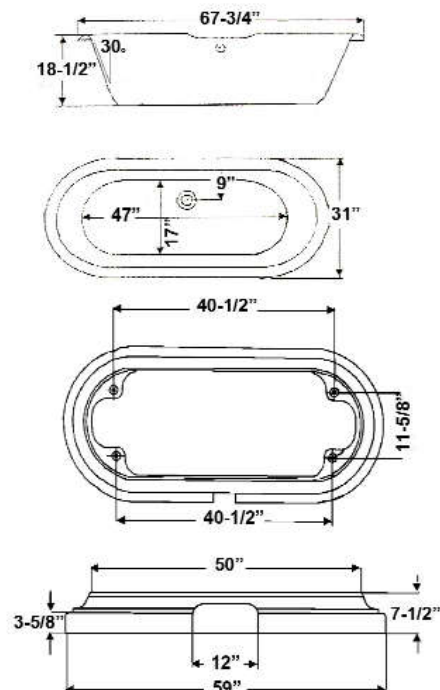

Dimensions and specifications subject to change without notice.