

## **INSTALLATION INSTRUCTIONS**

### **Tools Needed**

- Pencil • Tube Cutter • Socket Wrench • Saw • Wrench • Hammer • Screwdriver • Drill & 3/8" Bit •

### **Materials Needed**

- Sink • Faucet • Drain Assembly • Supply Pipe & Fittings • Drain Pipe, Trap & Fittings • Silicone Sealant •

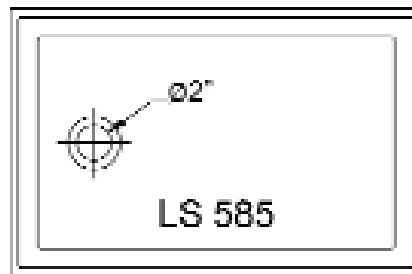
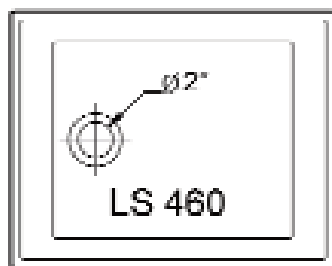
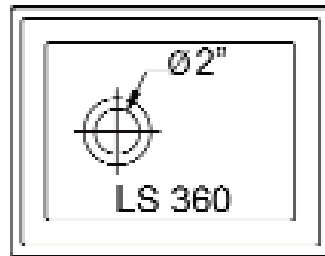
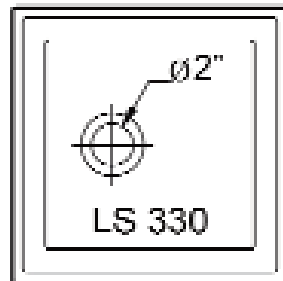

1. Using a template 1/2" narrower than the sink rim, mark the counter top cut out. Drill a starter hole 3/8" inside of circle and then use a saw to finish cutting the opening for the sink.
2. Place a bead of silicone caulk around the cut out opening. Install the drain assembly. Set the sink into the opening. Press the rim down firmly. Hook up the drain and water supply fittings.
3. Tighten all connections, being careful not to over tighten. Check for leaks. Small leaks can be corrected by tightening the nuts.

### **NOTE:**

**DO NOT tighten too much or you may damage bowl.**