

**RADCLIFF
67" ACRYLIC
OVAL TUB**

Cat. No.
ATSOVN67F



L: 66-1/2"
W: 29-1/2"
H: 23-1/2"

Rim: 1-1/2" W
Water depth: 17-3/8" to top of tub
Water depth: 12-7/8" to overflow

**The following is recommended for
ATSOVN67F tubs:**

- Faucets: part #7901 or 7913
- Leg tub drain: part #5599LT or 5599TS



Overflow can be drilled.
With overflow drilled this tub
requires drain 5599PD.
**Tubs that have been
drilled with overflow are
"special order" and
are not returnable.**

Gallon Capacity without OF:	55
Gallon Capacity with OF:	46
Shipping Weight:	288 lbs.
Empty Weight:	88 lbs.
Filled Weight without OF:	548 lbs.
Filled Weight with OF:	472 lbs.

Features:

- ▶ Interior and exterior walls acrylic sheets
- ▶ Air between sheets provides insulation to retain warmth
- ▶ For use with a freestanding tub filler or faucet mounted on the wall
- ▶ No faucet holes
- ▶ No overflow
- ▶ Tub is thoroughly inspected before shipment



Custom Colors Available (inside of tub is always white enamel):
Painted bathtubs are considered "special order" and are not returnable
\$160 Bisque or Black \$250 Designer Color

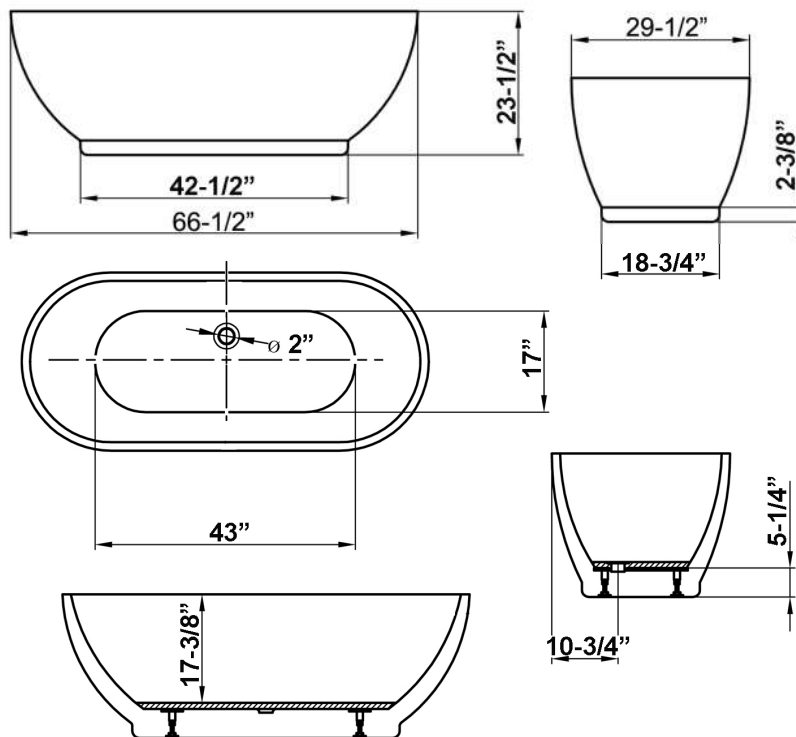

Dimensions of fixture are nominal and specifications subject to change without notice.