

**FORTUNA  
61" ACRYLIC  
SLIPPER TUB**

Cat. No.  
ATS7H61I

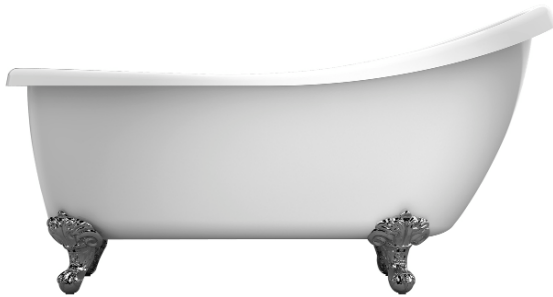

L: 61"  
W: 27½"  
H: 30½"

Water depth: 17-⅛" to top of tub  
Water depth: 12-⅝" to overflow

**The following is recommended for  
ATS7H tubs:**

- Rim-mounted faucets: part #4601 or 4201
- Straight bath supplies: part #5577
- Leg tub drain: part #5599

Gallon Capacity : 39  
Shipping Weight: 425 lbs.  
Empty Weight: 200 lbs.  
Filled Weight: 526 lbs.

**Features:**

- ▶ Acrylic construction for lighter weight
- ▶ Sloped back for comfort
- ▶ 7" centers in tub deck
- ▶ Pre-drilled overflow hole
- ▶ Aluminum imperial feet available in 4 finishes
- ▶ Tub is thoroughly inspected before shipment

**Feet Finishes:**

**BN** Brushed Nickel  
**PB** Polished Brass  
**CP** Polished Chrome  
**ORB** Oil Rubbed Bronze



**Custom Colors Available** (inside of tub is always white enamel):  
Painted bathtubs are considered "special order" and are not returnable  
\$160 Bisque or Black \$250 Designer Color

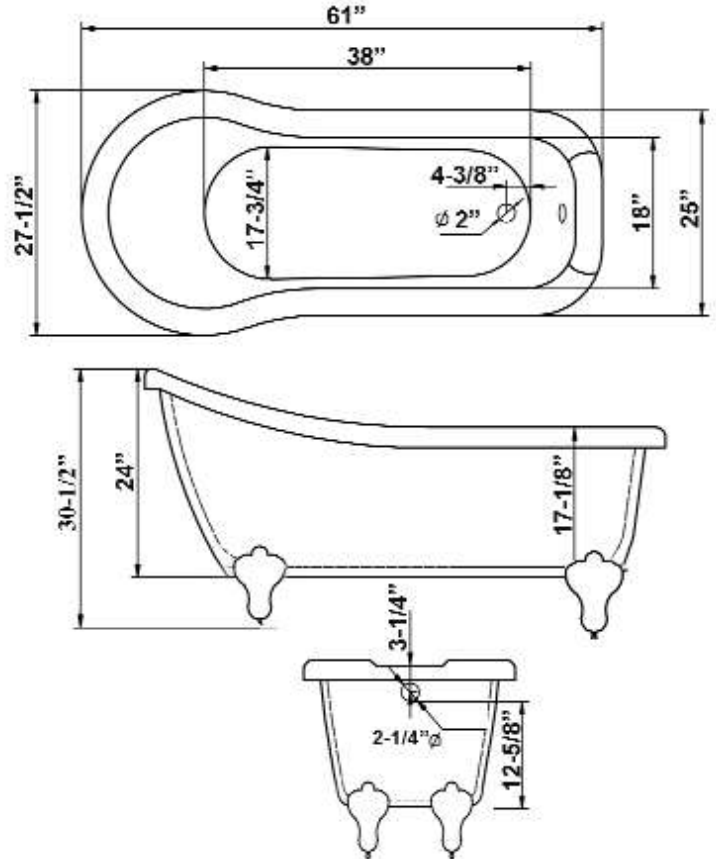

Dimensions of fixture are nominal and specifications subject to change without notice.