

**SAXTON  
70" ACRYLIC  
OVAL TUB**

Cat. No.  
ATOVN70MF



L: 70"  
W: 32"  
H: 21-3/4"

Water depth: 16-1/2" to top of tub  
Water depth: 12" to overflow

**The following is recommended for ATOVN70MF tubs:**

- Faucets: part #7901 or 7913
- Leg tub drain: part #5599LT



Overflow can be drilled.  
With overflow drilled this tub requires drain 5599PD or 5599HD.  
**Tubs that have been drilled with overflow are "special order" and are not returnable.**

Gallon Capacity without OF:	60
Gallon Capacity with OF:	49
Shipping Weight:	300 lbs.
Empty Weight:	75 lbs.
Filled Weight without OF:	576 lbs.
Filled Weight with OF:	485 lbs.

**Features:**

- ▶ Interior and exterior walls acrylic sheets
- ▶ Air between sheets provides insulation to help retain warmth
- ▶ No faucet holes
- ▶ No overflow
- ▶ Tub is thoroughly inspected before shipment
- ▶ Option to add foam insulation between tub walls available



**Custom Colors Available** (inside of tub is always white enamel):  
Painted bathtubs are considered "special order" and are not returnable  
\$160 Bisque or Black \$250 Designer Color

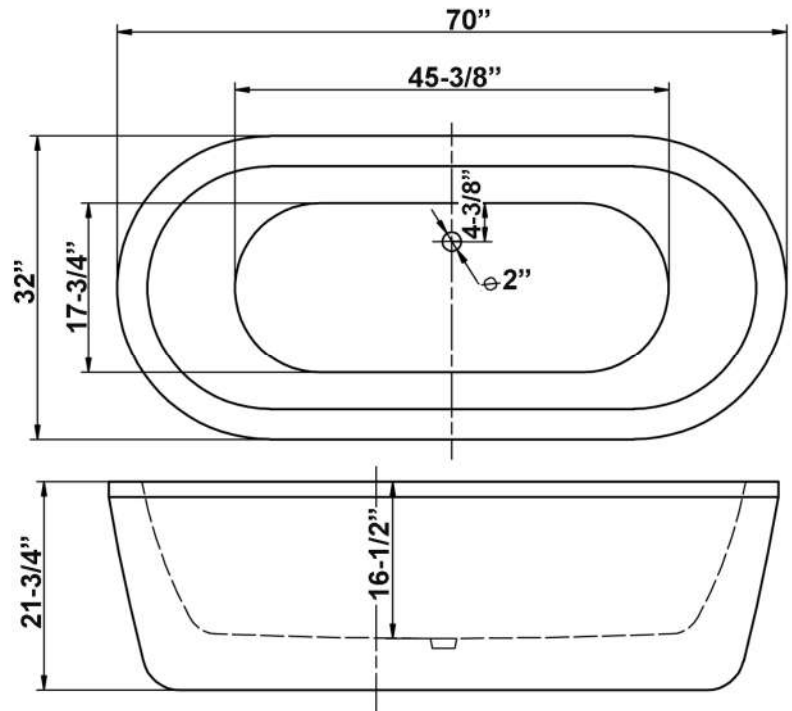

Dimensions of fixture are nominal and specifications subject to change without notice.