

ORRICK 63" FREESTANDING ACRYLIC TUB

Cat. No.
ATOVN63I



L: 62-1/4"
W: 29-1/2"
H: 22-1/2"

Water depth: 17" to top of tub
Water depth: 12-3/4" to overflows

The following is recommended for ATOVN63I tubs:

- Faucets: part #4602, 4604 or 7082
- Rigid, freestanding supplies: part #4502
- Leg tub drain: part #5599LT



Overflow can be drilled.
With overflow drilled this
tub requires drain
5599PD or 5599HD.
**Tubs that have been
drilled with overflow are
"special order" and
are not returnable.**

Gallon Capacity without OF:	61
Gallon Capacity with OF:	51
Shipping Weight:	214 lbs.
Empty Weight:	104 lbs.
Filled Weight without OF:	613 lbs.
Filled Weight with OF:	530 lbs.

Features:

- ▶ Interior and exterior walls acrylic sheets
- ▶ Air between walls provides insulation to help retain warmth
- ▶ Tub rim is 1-1/2" wide
- ▶ No faucet holes
- ▶ No overflow
- ▶ Includes built-in adjusters
- ▶ Tub is thoroughly inspected before shipment
- ▶ Option to add foam insulation between tub walls available



Custom Colors Available (inside of tub is always white enamel):
Painted bathtubs are considered "special order" and are not returnable
\$160 Bisque or Black \$250 Designer Color

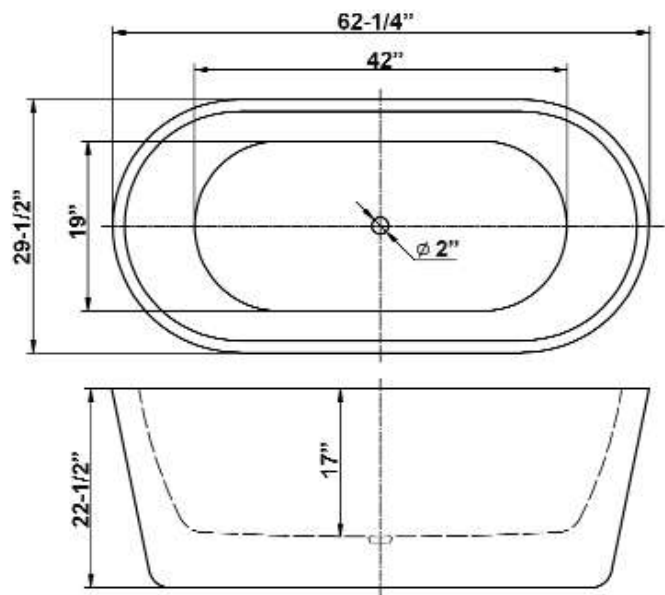

Dimensions of fixture are nominal and specifications subject to change without notice.