

59" PAIGE ACRYLIC FREESTANDING TUB

Cat. No.
ATOVN59K



L: 59"
W: 31"
H: 24"

Water depth: 17" to top of tub
Water depth: 12-1/2" to overflow

The following is recommended for
ATOVN59K tubs:

- Faucet: #4602,4604,7082 or 7088
- Rigid, freestanding supplies:part #4502
- Freestanding filler:part #7932, 7952 or 7918
(Does not need bath supplies)
- Leg tub drain: #5599LT or 5599TS



Overflow can be drilled.
With overflow drilled this tub
requires drain 5599PD.
**Tubs that have been
drilled with overflow are
"special order" and
are not returnable.**

Gallon Capacity: 54
Shipping Weight: 200 lbs.
Empty Weight: 90 lbs.
Filled Weight: 540 lbs.

Features:

- ▶ Acrylic construction for lighter weight
- ▶ Smooth inside and out
- ▶ No faucet hole
- ▶ No overflow hole
- ▶ Includes built-in adjusters
- ▶ Tub is thoroughly inspected before shipment
- ▶ Option to add foam insulation between tub walls available



Custom Colors Available (inside of tub is always white enamel):
Painted bathtubs are considered "special order" and are not returnable
\$160 Bisque or Black \$250 Designer Color

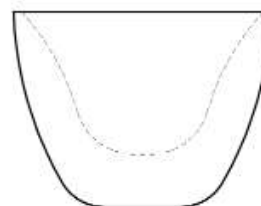
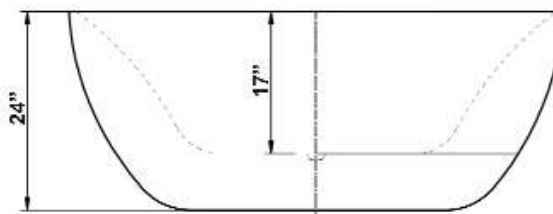
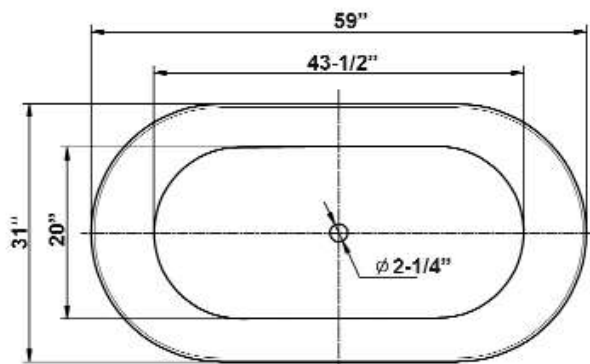

Dimensions of fixture are nominal and may vary within the range of tolerances established.