

Model : E034150

Designed By: **MATTEO THUN & ANTONIO RODRIGUEZ** | ITALY

2016 INVENTORY

- Features :**
- All wood back
 - Touch-activated LED light strip on the bottom of the top hutch frame panel
 - Touch-activated LED light button on bottom right
 - 4 open wood shelves on right
 - Solid wood construction (no MDF)
 - Multi-step polyurethane finish resists moisture and scratches
 - For use on top of 51" and 78" Noce vanity

All Ronbow cabinets are made of solid hardwood or hardwood plywood and meet strict CARB II Standards. No particle board or Micro-Density Fiberboard (MDF) are used.

Available Finish : American Walnut (E56)

Top

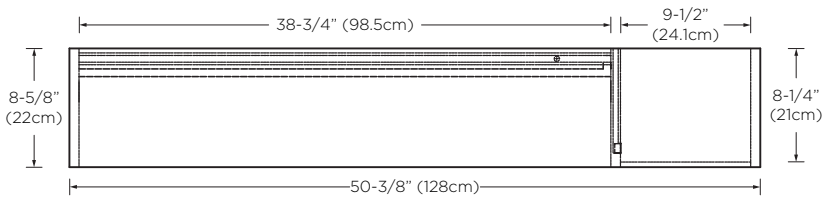

Front

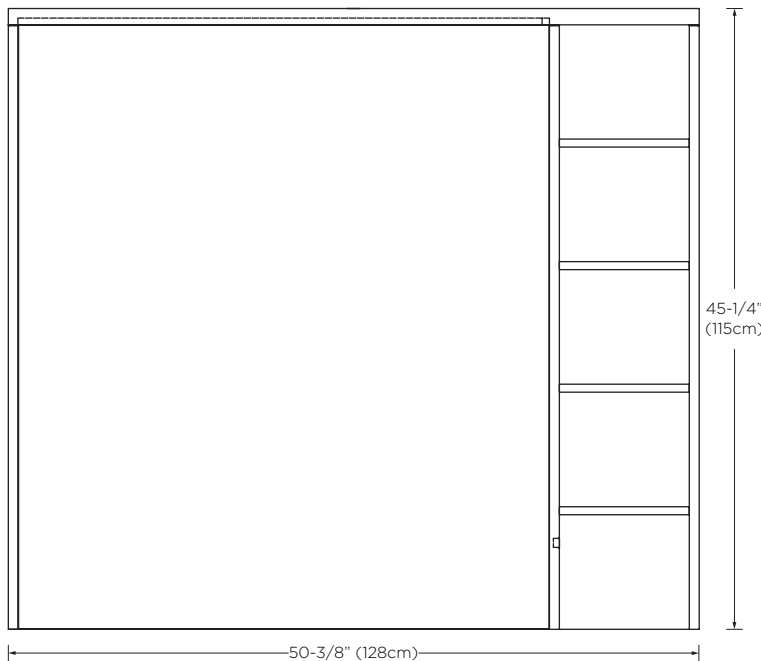

Sides

Mirror-Side

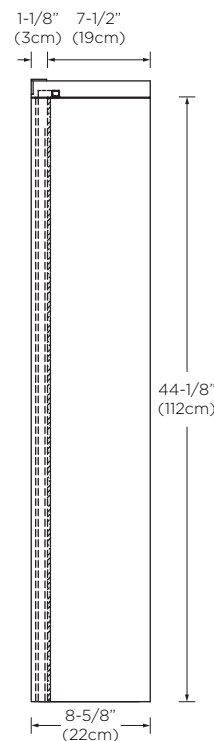

Shelves-Side

