

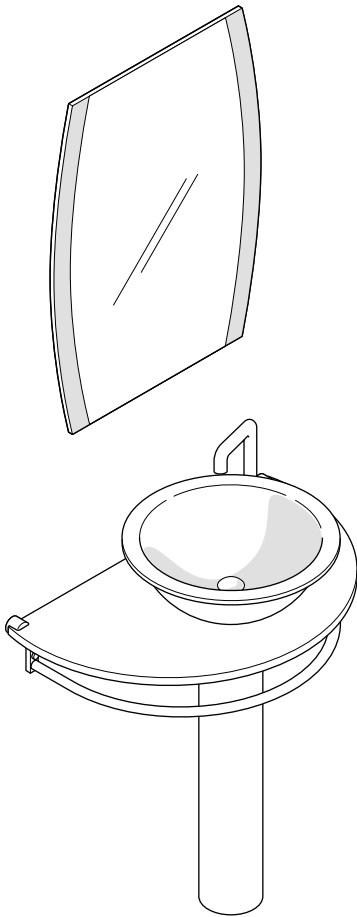

FVN1066
SCOPERTO
INSTALLATION GUIDE



FRESCA

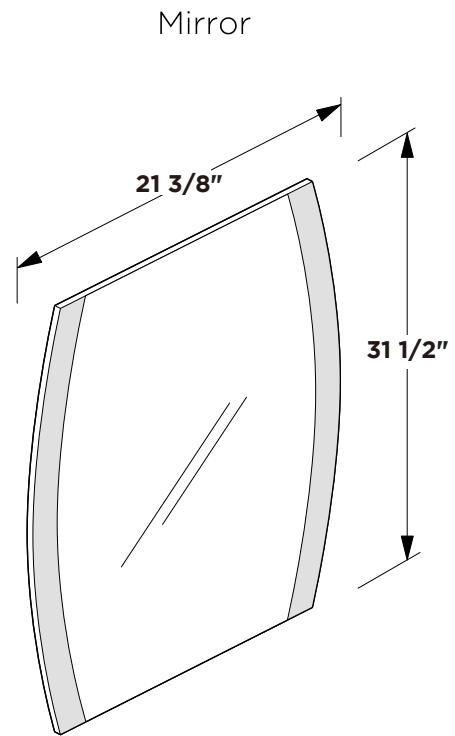

Vanity Front

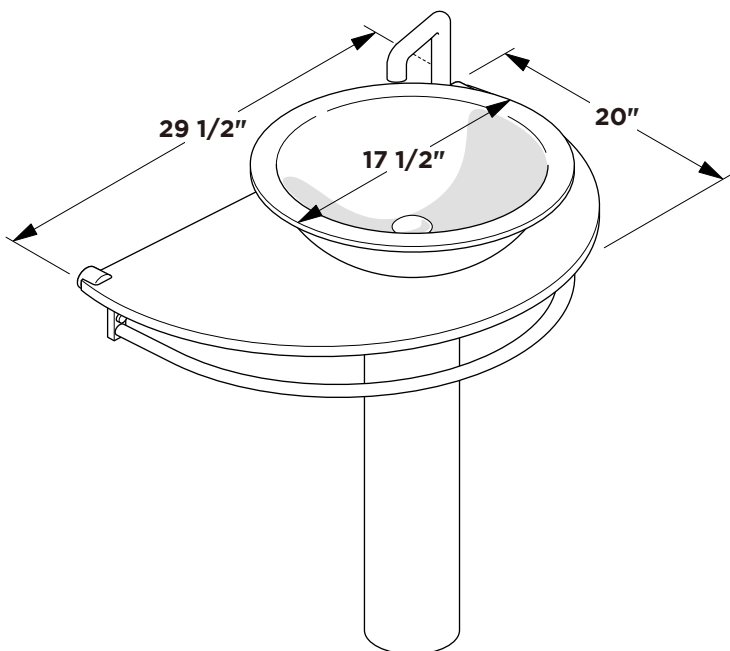

Mirror



Vanity Back

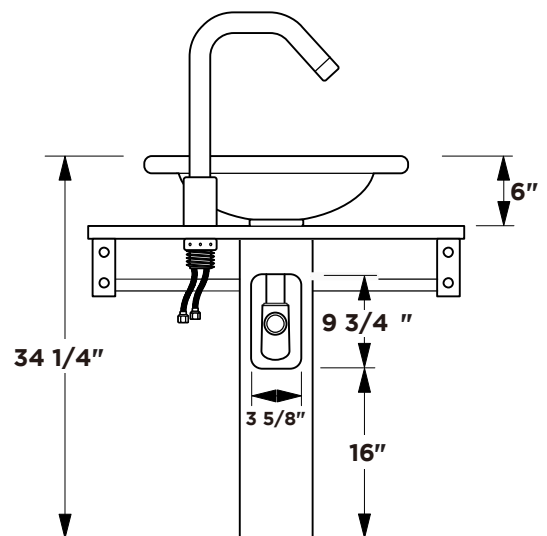

Note: All dimensions and specifications are approximate and subject to change without notice.

TOOLS FOR ASSEMBLY

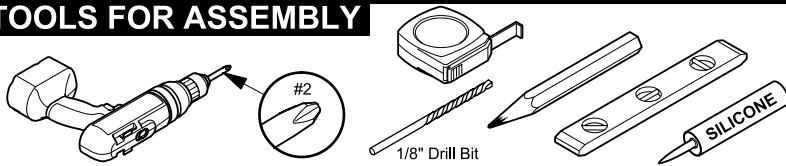

PARTS

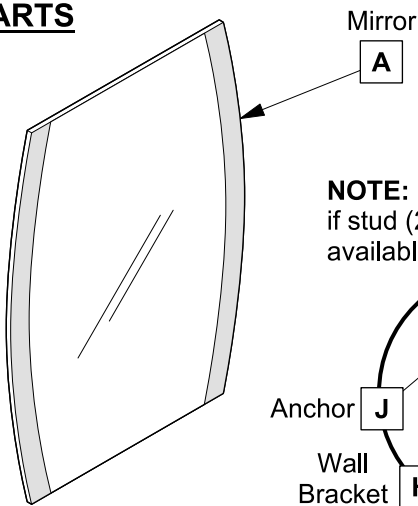

NOTE: Only use anchors (J) if stud (2"x4" frame) is not available.

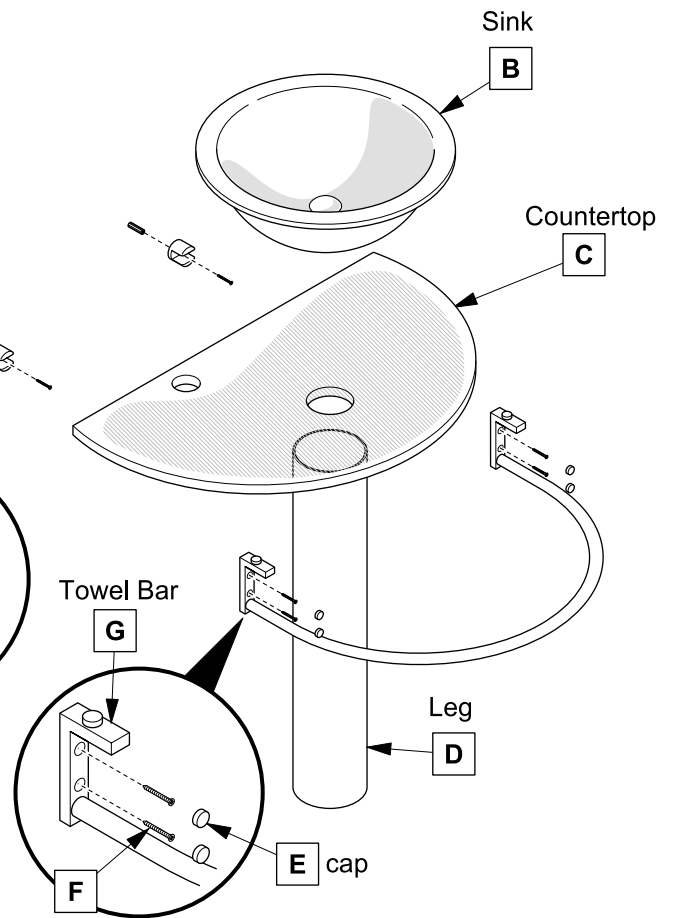
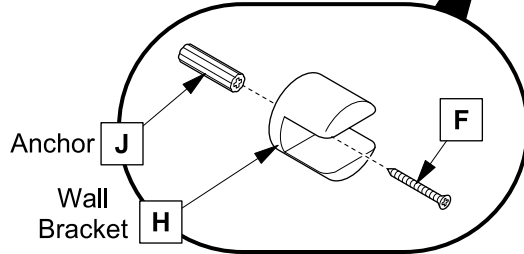

1 Install wall brackets (H)

IMPORTANT: Consult an expert for the proper screws/bolts to use when attaching to various wall constructions. Screws provided do not attach to all wall construction types.

2 Locate leg (D) and install countertop (C)

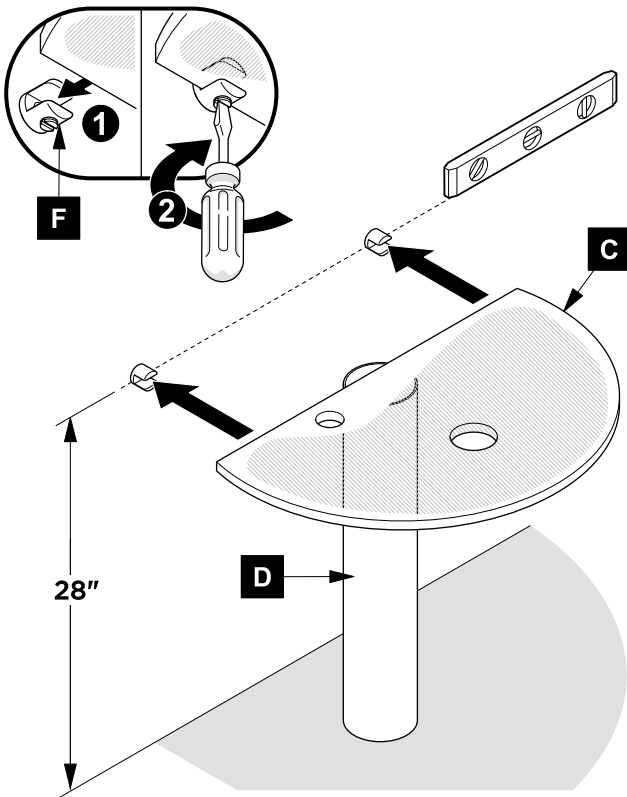

3 Install sink (B) & towel bar (G)

4 Install mirror (A)

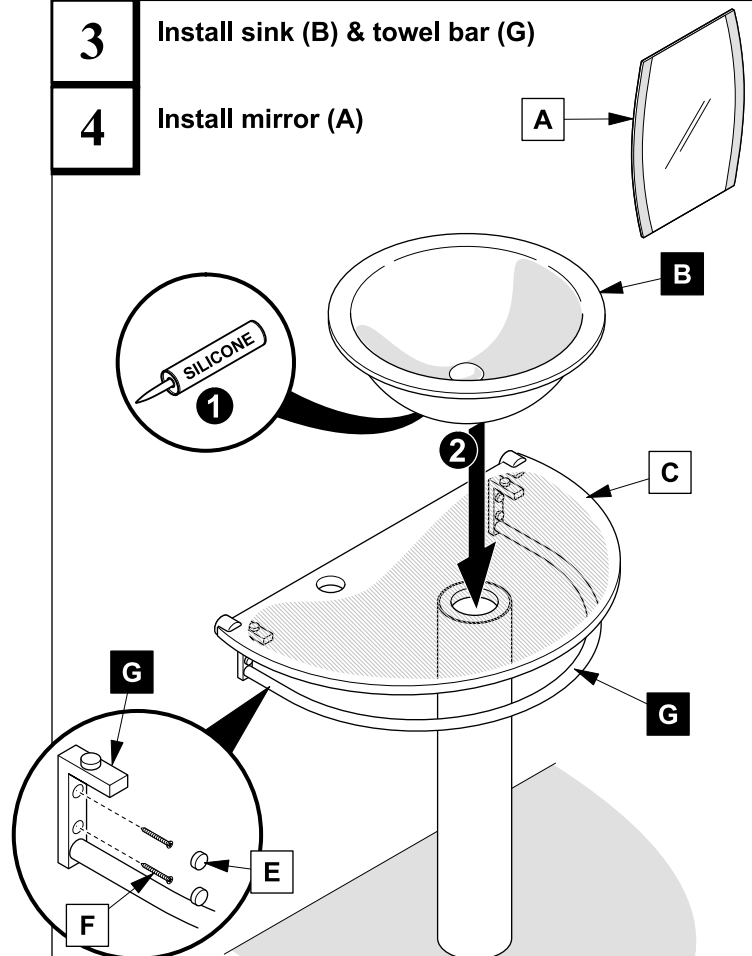

P-TRAP AND POP-UP INSTALLATION INSTRUCTIONS

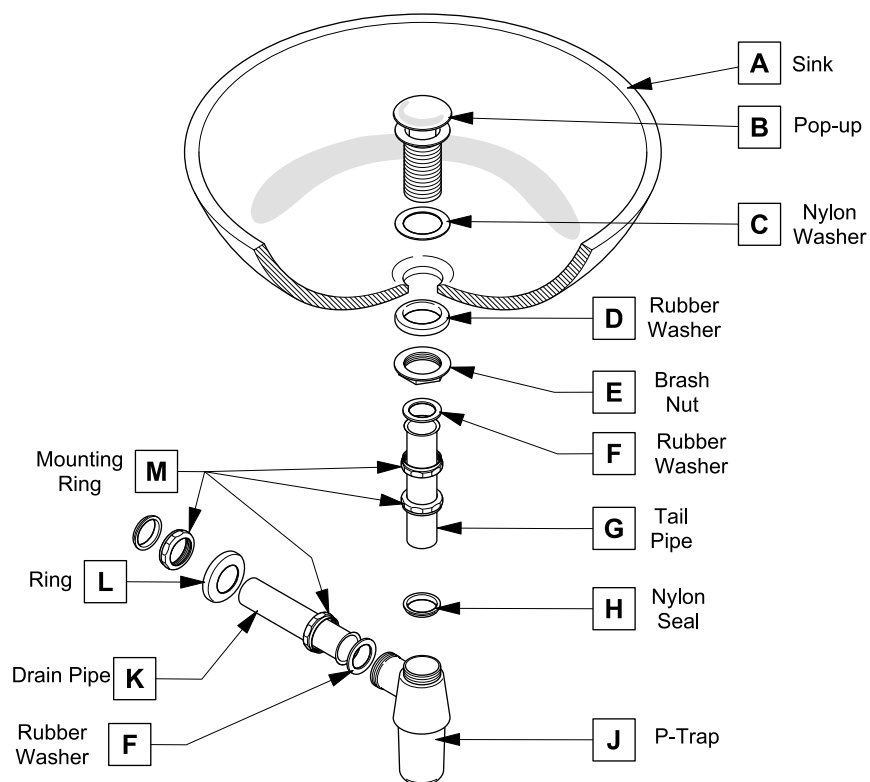

POP-UP INSTALLATION

FOR SINKS WITHOUT OVERFLOW

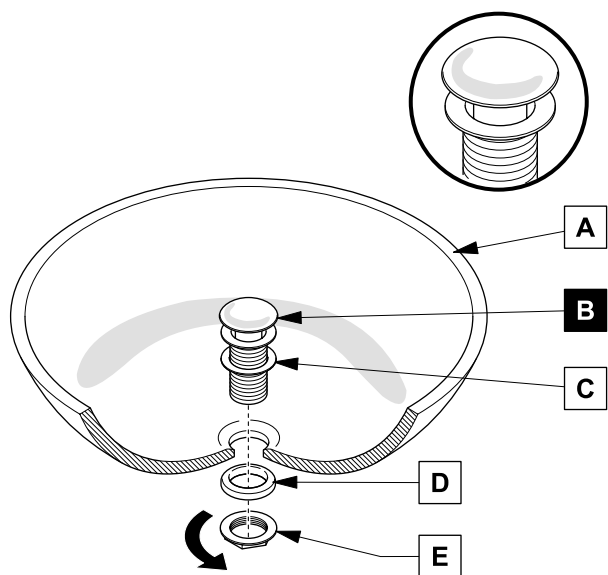

OR

FOR SINKS WITH OVERFLOW

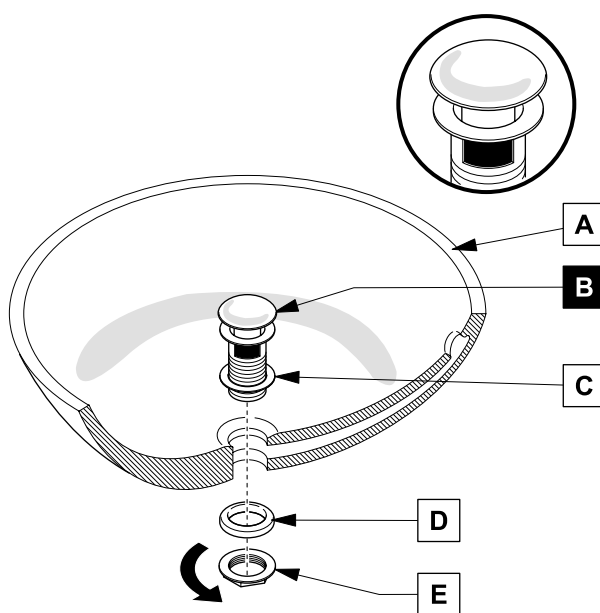

1

Install tail pipe (G)

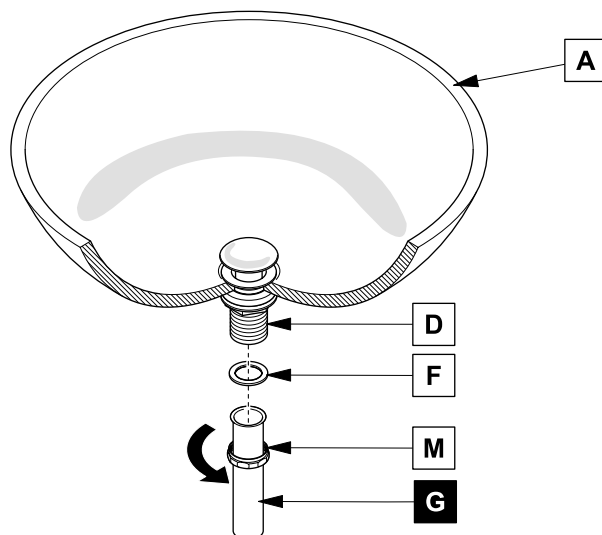

2

Install p-trap (J)

