

SHOWER
Topaz Pressure Balancing Shower
Set (Rough & Trim)
G-7110-LM14

GRAFF®



Information

- 1/2" Rough Valve, Trim Plate, and Handle
- 3-3/4" showerhead with 5" arm & flange
- Optional extension kit
- Showerhead flow rate ≤ 1.8 max gpm
- 1/2" rough valve flow rate ~ 7.5 gpm @60 psi
- ADA
- CALGreen

G-7110-LM14

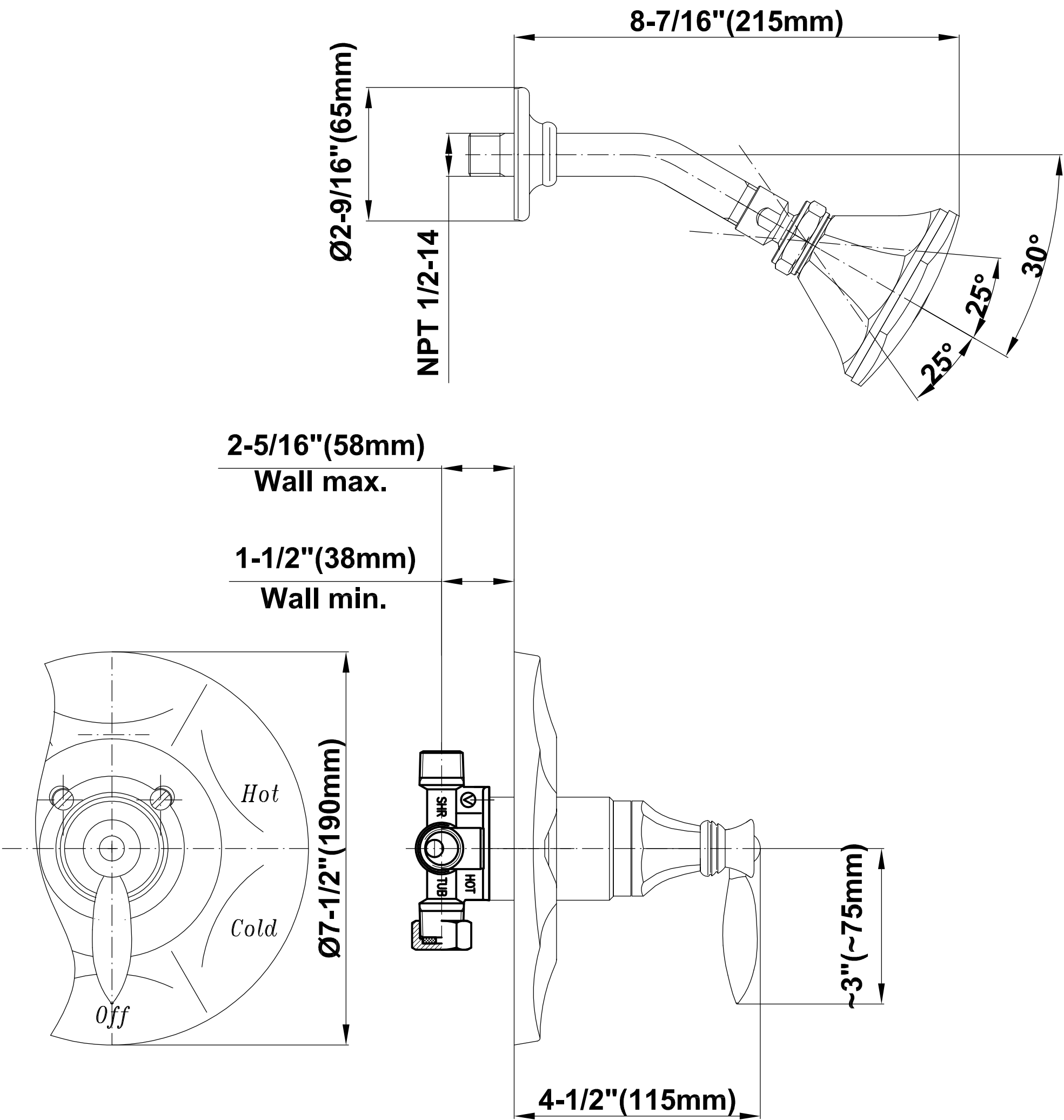

SHOWER
Concealed Pressure Balancing
Valve Rough
G-7005

GRAFF®



Information

- Anti-scald protection
- 1/2" universal inlets/outlets with male threads
- Built-in service stops
- For use with shower only configuration
- Supplied with protective plastic guard

Finishes



24K Gold



24K Brushed
Gold



Olive Bronze



Polished
Chrome



Polished
Nickel



Steelnox®
(Satin Nickel)

G-7005

Concealed Pressure Balancing Valve Rough



Product Features

- Anti-scald protection
- 1/2" universal inlets/outlets with male threads
- Built-in service stops
- For use with shower only configuration
- Supplied with protective plastic guard

Warranty

- Limited lifetime warranty

For complete warranty information go to www.graff-faucets.com/en/info/faqs

Pressure Balance Rough G-7005

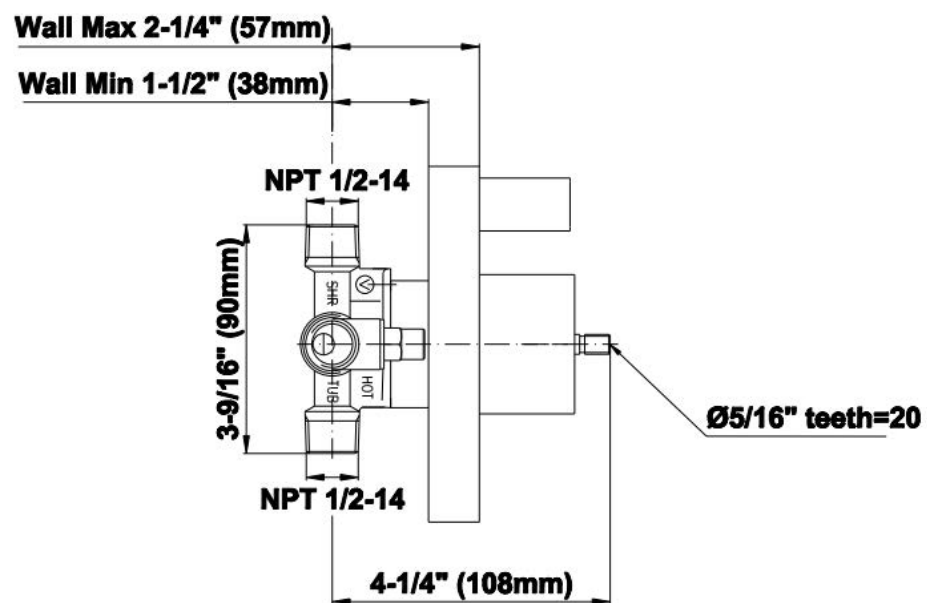

SHOWER
Topaz Trim plate w/Handle
G-7025-LM14-T

GRAFF®



Information

- Single metal lever handle
- Octagonal trim plate
- Use with G-7005 pressure balancing rough valve for shower-only configurations
- To complete package, you must order rough valve
- ADA

Finishes



24K Gold



24K Brushed
Gold



Olive Bronze



Polished
Chrome



Polished
Nickel



Steelnox®
(Satin Nickel)

G-7025

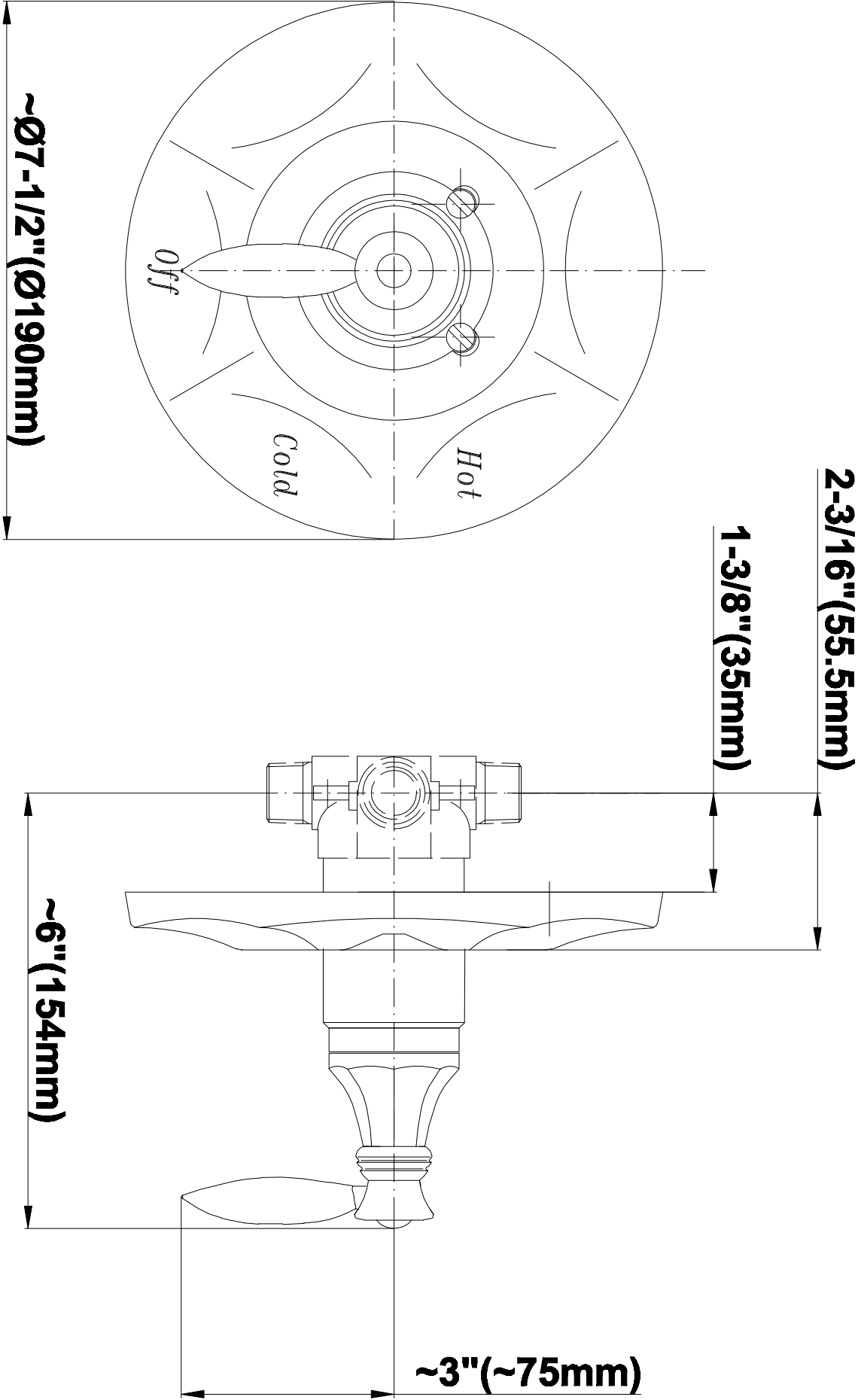

SHOWER
3-3/4" Hexagonal Showerhead
G-8445

GRAFF®



Information

- Octagon shape, 40 spray openings
- Metal ball-joint allows for showerhead angle adjustment
- Matches Topaz Series
- Showerhead flow rate ≤ 1.8 max gpm
- CALGreen

Finishes



24K Gold



24K Brushed
Gold



Olive Bronze



Polished
Chrome



Polished
Nickel



Steelnox®
(Satin Nickel)

G-8445

Topaz Collection

3-3/4" Octagonal Showerhead

GRAFF[®]
CUTTING EDGE DESIGN



Product Features

- Octagon shape, 40 spray openings
- Metal ball-joint allows for showerhead angle adjustment
- Matches Topaz Collection
- Showerhead flow rate ≤ 1.8 max gpm

Available Finishes

- Polished Chrome
G-8445-PC
- Polished Nickel
G-8445-BNi
- Steelnox
G-8445-SN
- Olive Brass
G-8445-OB
- Gold*
G-8445-AU*
- Brushed Gold*
G-8445-BAU*

* Special order finish- call for availability

Code Compliance

- CALGreen

Warranty

- Limited lifetime warranty

For complete warranty information go to
www.graff-designs.com/en-nam/warranty

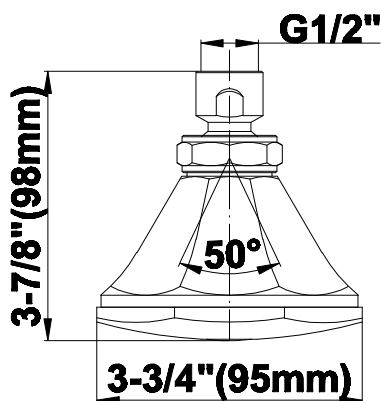

The measurements shown are for reference only. Products and specifications shown are subject to change without notice. Revised 12/2017

www.graff-designs.com | phone: 800-954-4723

SHOWER
Traditional 5" Shower Arm
G-8520

GRAFF®



Information

- Includes arm and flange
- 1/2" NPT male thread inlet
- For use with all showerheads (especially G-8420, G-8440 and G-8450)

Finishes



24K Gold



24K Brushed
Gold



Olive Bronze



Polished
Chrome



Polished
Nickel



Steelnox®
(Satin Nickel)

G-8520

